

PLOTTED: 25-MAR-2025 09:01

PRELIMINARY
STATE ROUTE 0426 SECTION 01M
CITY OF CORRY, ERIE COUNTY
MILL AND OVERLAY PROJECT

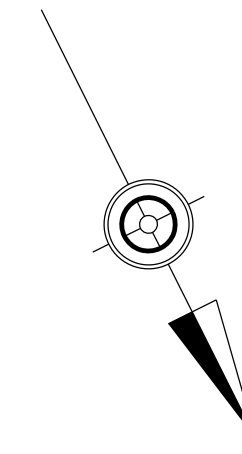

LIMIT OF WORK
STA 22+10.00
SEG 0260 OFF 2406
SR 0426 SEC 01M
COLUMBUS TOWNSHIP
WARREN COUNTY

START WORK
BEGIN MILL AND OVERLAY
STA 22+60.00
SEG 0010 OFF 0000
SR 0426 SEC 01M

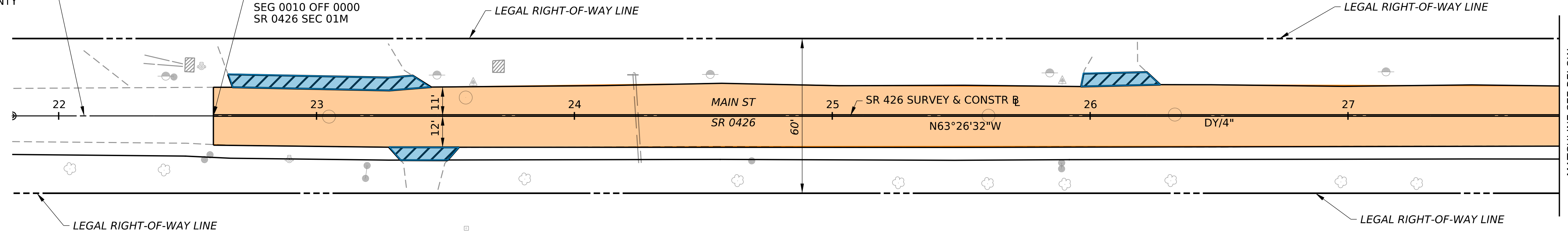

MATCHLINE SEE BELOW

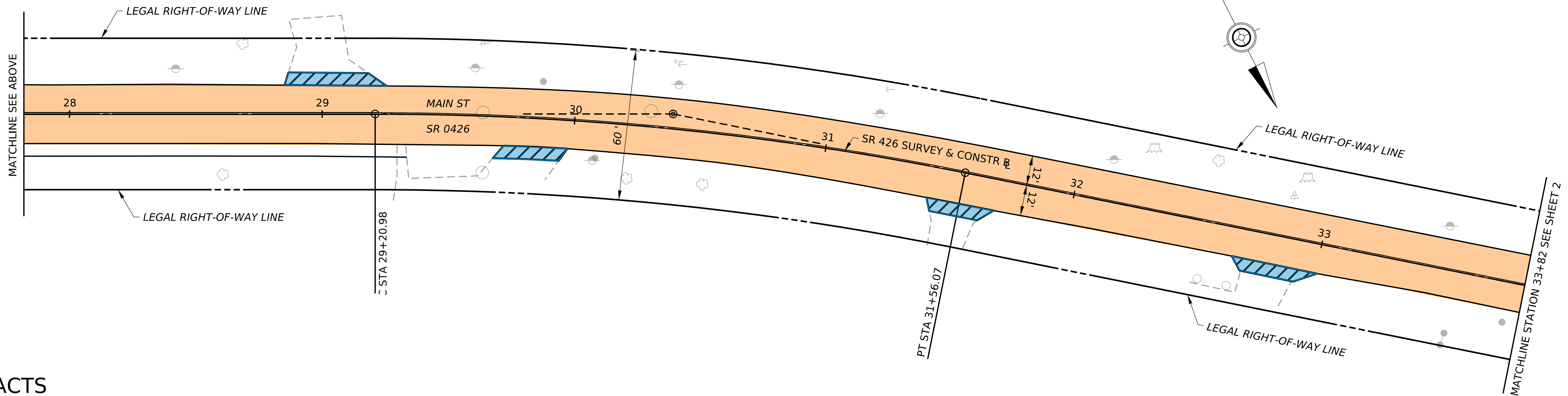

CONTACTS

ANY QUESTIONS OR CONCERNS CAN BE DIRECTED TO THE FOLLOWING:
CHRISTINE BOYER-KRANTZ, P.E.
PENNDOT PROJECT MANAGER
225 ELM STREET
OIL CITY, PA 16301
CHBOYER@PA.GOV
(814) 678-7379
LODOVICO (VICO) C. INNOCENTI, P.E.
FISHER ASSOCIATES
CONSULTANT PROJECT MANAGER
121 HILLPOINTE DR, SUITE 100
CANONSBURG, PA 15317
LINNOCENTI@FISHERASSOC.COM
(724) 916-4250 EXT 394

LEGEND

- DRIVEWAY ADJUSTMENT
- MILL AND OVERLAY

SCALE



OPERATOR: jbaillly
FILE NAME: H:\Projects\22\220651-00-E05514Erie_Grp3\Eng\CAD\InRoads\25 0426 01M ALT3.dgn

PLOTTED: 25-MAR-2025 09:01

PRELIMINARY
STATE ROUTE 0426 SECTION 01M
CITY OF CORRY, ERIE COUNTY
MILL AND OVERLAY PROJECT

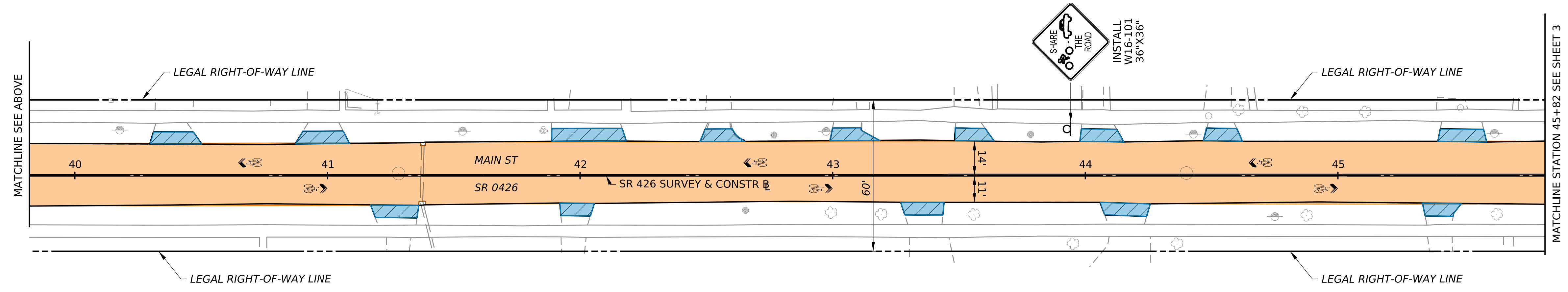
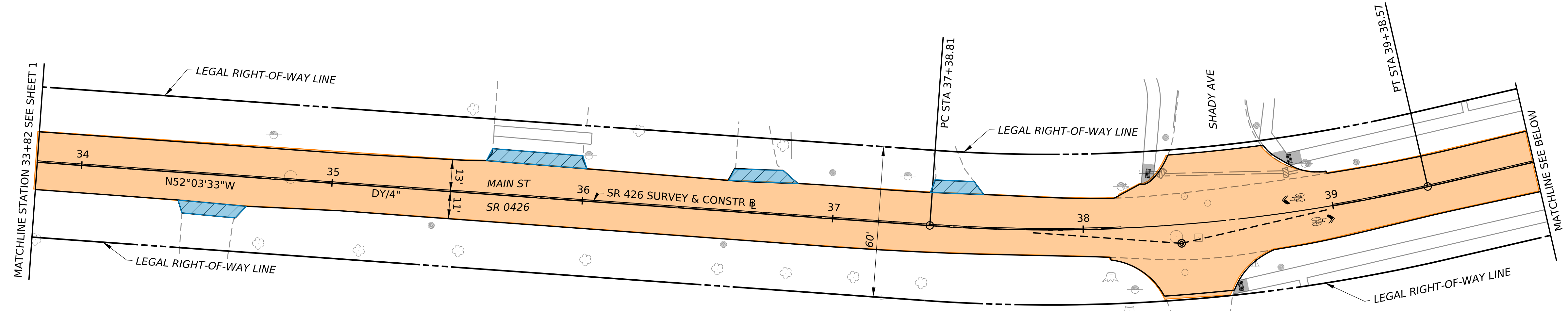



CONTACTS

ANY QUESTIONS OR CONCERNS CAN BE DIRECTED TO THE FOLLOWING:

CHRISTINE BOYER-KRANTZ, P.E. PENNDOT PROJECT MANAGER 225 ELM STREET OIL CITY, PA 16301 CHBOYER@PA.GOV (814) 678-7379	LODOVICO (VICO) C. INNOCENTI, P.E. FISHER ASSOCIATES CONSULTANT PROJECT MANAGER 121 HILLPOINTE DR, SUITE 100 CANONSBURG, PA 15317 LINNOCENTI@FISHERASSOC.COM (724) 916-4250 EXT 394
---	---

LEGEND

-  DRIVEWAY ADJUSTMENT
-  MILL AND OVERLAY

SCALE

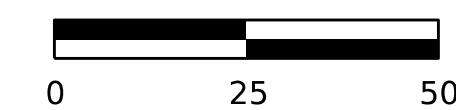

OPERATOR: jbaillly
FILE NAME: H:\Projects\22\220651-00-E05514Erie_Grp3\Eng\CAD\InRoads\25 0426 01M ALT3.dgn

PLOTTED: 25-MAR-2025 09:02

PRELIMINARY
STATE ROUTE 0426 SECTION 01M
CITY OF CORRY, ERIE COUNTY
MILL AND OVERLAY PROJECT

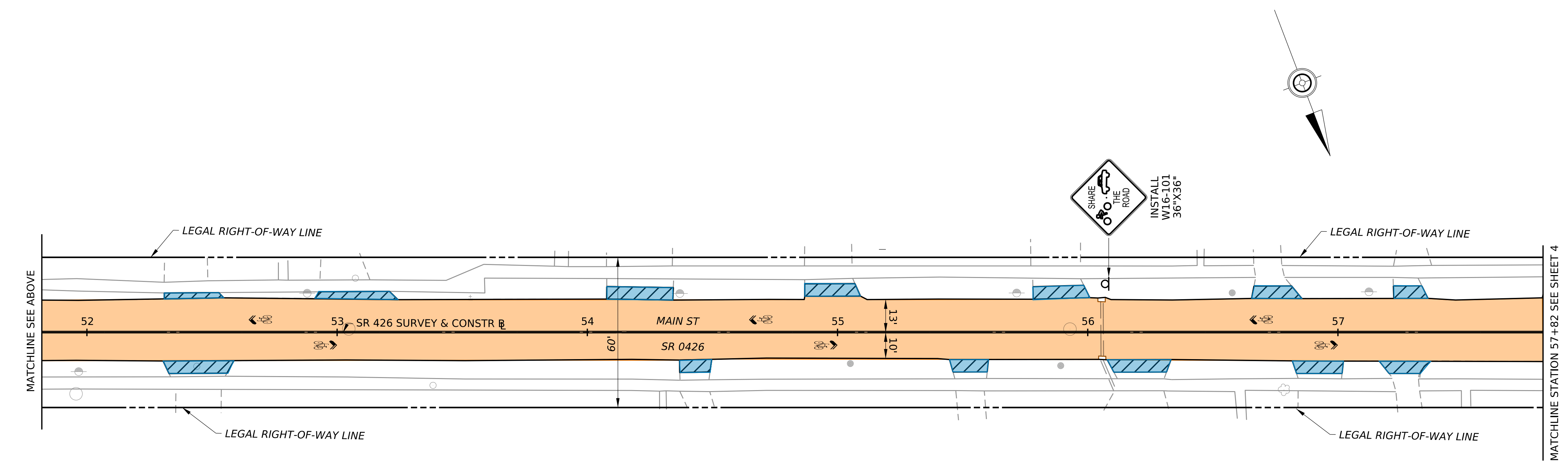
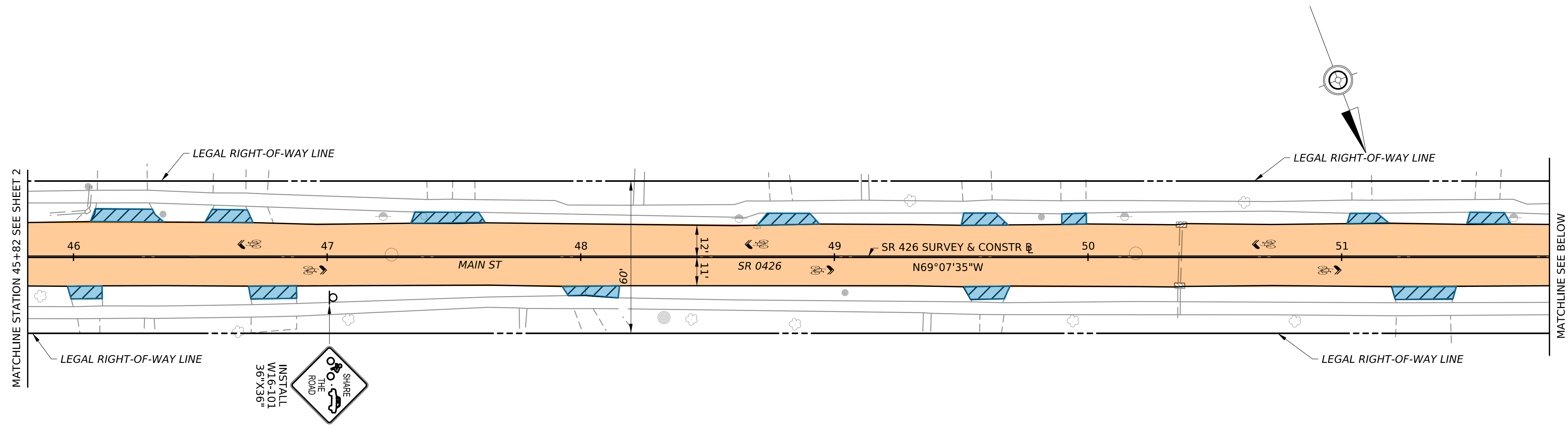



CONTACTS

ANY QUESTIONS OR CONCERNS CAN BE DIRECTED TO THE FOLLOWING:

CHRISTINE BOYER-KRANTZ, P.E. PENNDOT PROJECT MANAGER 225 ELM STREET OIL CITY, PA 16301 CHBOYER@PA.GOV (814) 678-7379	LODOVICO (VICO) C. INNOCENTI, P.E. FISHER ASSOCIATES CONSULTANT PROJECT MANAGER 121 HILLPOINTE DR, SUITE 100 CANONSBURG, PA 15317 LINNOCENTI@FISHERASSOC.COM (724) 916-4250 EXT 394
---	---

LEGEND

-  DRIVEWAY ADJUSTMENT
-  MILL AND OVERLAY

SCALE

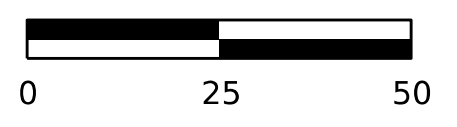

OPERATOR: jbaillly
FILE NAME: H:\Projects\22\220651-00-E05514Erie_Grp3\Eng\CAD\InRoads\25 0426 01M ALT3.dgn

PRELIMINARY
 STATE ROUTE 0426 SECTION 01M
 CITY OF CORRY, ERIE COUNTY
 MILL AND OVERLAY PROJECT

PLOTTED: 25-MAR-2025 09:02

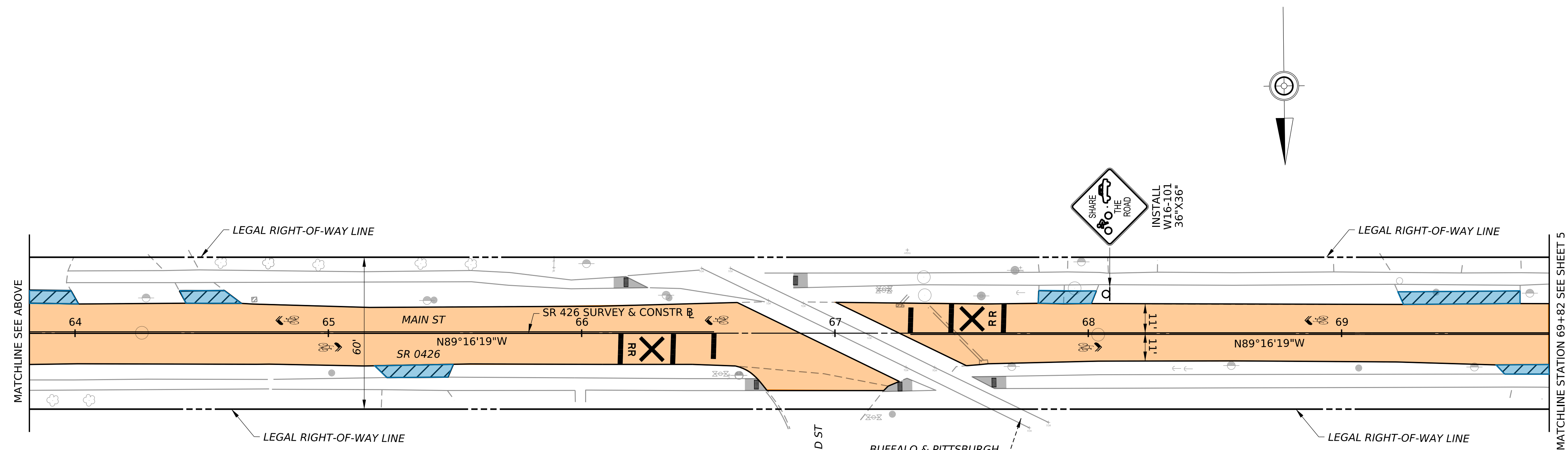
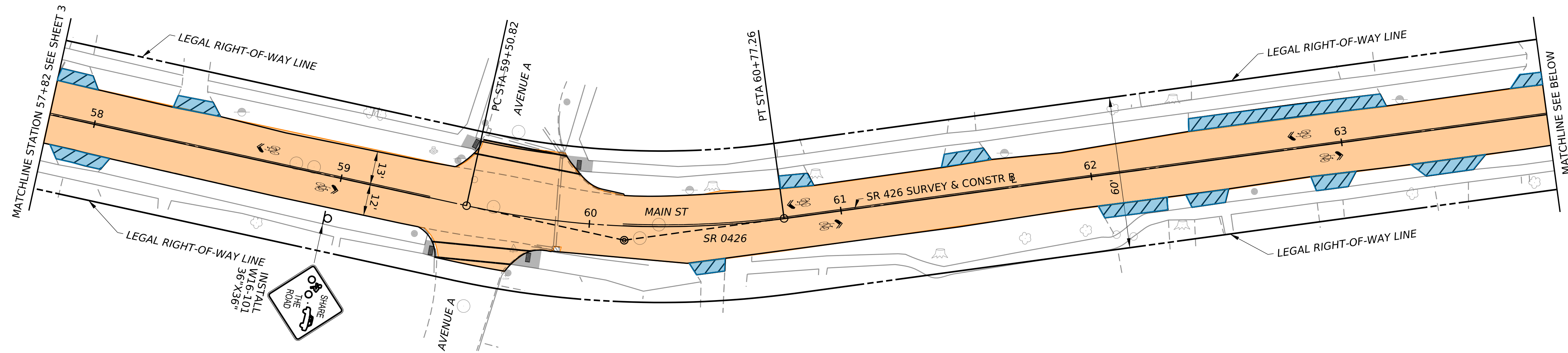



CONTACTS

ANY QUESTIONS OR CONCERNS CAN BE DIRECTED TO THE FOLLOWING:

CHRISTINE BOYER-KRANTZ, P.E. PENNDOT PROJECT MANAGER 225 ELM STREET OIL CITY, PA 16301 CHBOYER@PA.GOV (814) 678-7379	LODOVICO (VICO) C. INNOCENTI, P.E. FISHER ASSOCIATES CONSULTANT PROJECT MANAGER 121 HILLPOINTE DR, SUITE 100 CANONSBURG, PA 15317 LINNOCENTI@FISHERASSOC.COM (724) 916-4250 EXT 394
---	---

LEGEND

-  DRIVEWAY ADJUSTMENT
-  MILL AND OVERLAY

SCALE

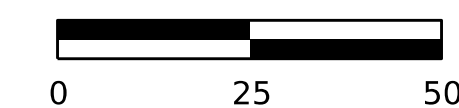

OPERATOR: jbaillly
 FILE NAME: H:\Projects\22\220651-00-E05514Erie_Grp3\Eng\CAD\InRoads\25 0426 01M ALT3.dgn

PRELIMINARY
 STATE ROUTE 0426 SECTION 01M
 CITY OF CORRY, ERIE COUNTY
 MILL AND OVERLAY PROJECT

PLOTTED: 25-MAR-2025 09:02

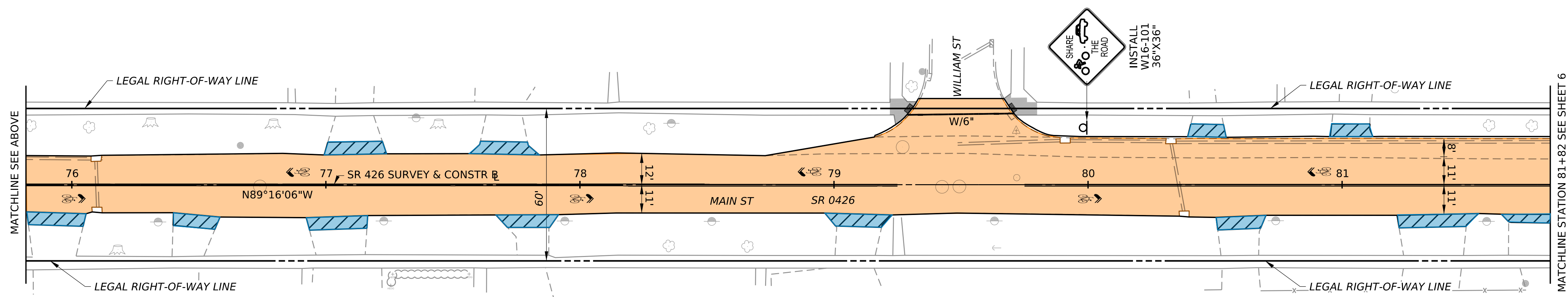
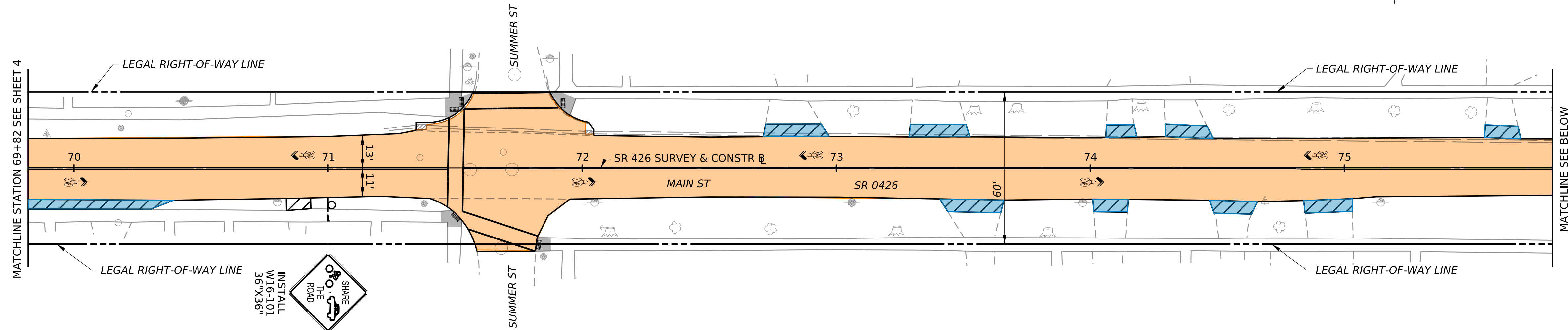



CONTACTS

ANY QUESTIONS OR CONCERNS CAN BE DIRECTED TO THE FOLLOWING:

CHRISTINE BOYER-KRANTZ, P.E. PENNDOT PROJECT MANAGER 225 ELM STREET OIL CITY, PA 16301 CHBOYER@PA.GOV (814) 678-7379	LODOVICO (VICO) C. INNOCENTI, P.E. FISHER ASSOCIATES CONSULTANT PROJECT MANAGER 121 HILLPOINTE DR, SUITE 100 CANONSBURG, PA 15317 LINNOCENTI@FISHERASSOC.COM (724) 916-4250 EXT 394
---	---

LEGEND

-  DRIVEWAY ADJUSTMENT
-  MILL AND OVERLAY

SCALE

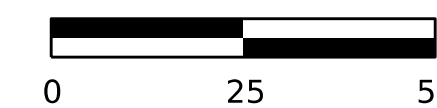

OPERATOR: jbaillly
 FILE NAME: H:\Projects\22\220651-00-E05514Erie_Grp3\Eng\CAD\InRoads\25 0426 01M ALT3.dgn

PRELIMINARY
STATE ROUTE 0426 SECTION 01M
CITY OF CORRY, ERIE COUNTY
MILL AND OVERLAY PROJECT

PLOTTED: 25-MAR-2025 09:02

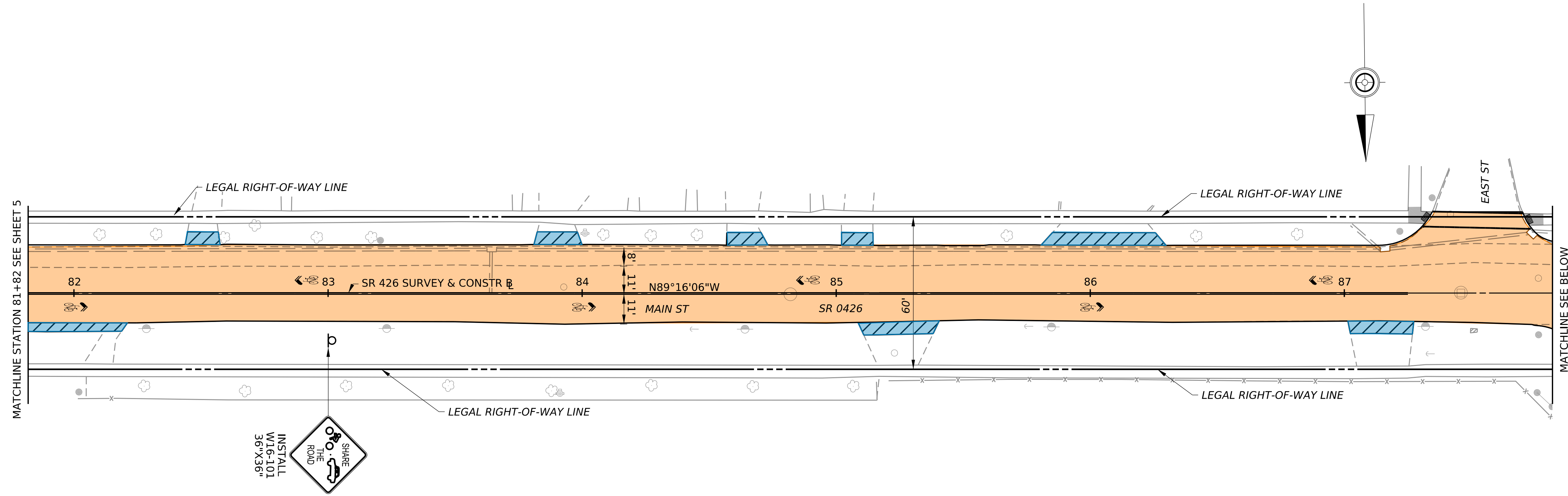



CONTACTS

ANY QUESTIONS OR CONCERNS CAN BE DIRECTED TO THE FOLLOWING:

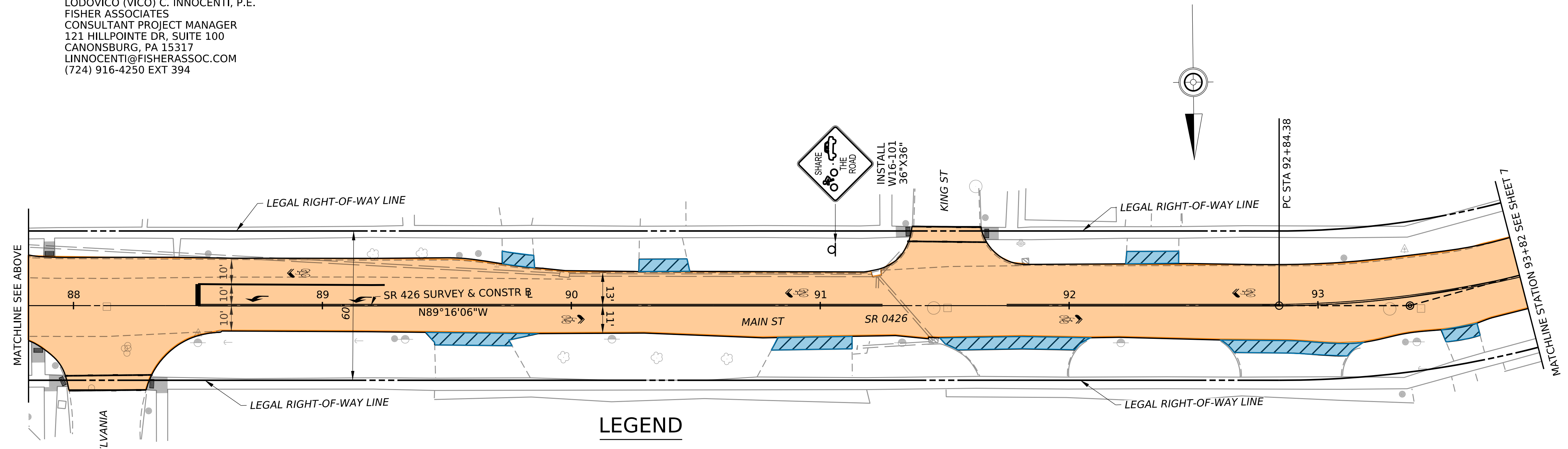
CHRISTINE BOYER-KRANTZ, P.E. PENNDOT PROJECT MANAGER 225 ELM STREET OIL CITY, PA 16301 CHBOYER@PA.GOV (814) 678-7379	LODOVICO (VICO) C. INNOCENTI, P.E. FISHER ASSOCIATES CONSULTANT PROJECT MANAGER 121 HILLPOINTE DR, SUITE 100 CANONSBURG, PA 15317 LINNOCENTI@FISHERASSOC.COM (724) 916-4250 EXT 394
---	---



LEGEND

-  DRIVEWAY ADJUSTMENT
-  MILL AND OVERLAY

SCALE

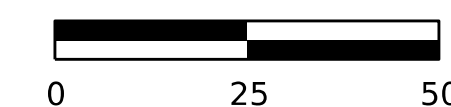

OPERATOR: jbaillly
FILE NAME: H:\Projects\22\220651-00-E05514Erie_Grp3\Eng\CAD\InRoads\25 0426 01M ALT3.dgn

PLOTTED: 25-MAR-2025 09:02

PRELIMINARY
STATE ROUTE 0426 SECTION 01M
CITY OF CORRY, ERIE COUNTY
MILL AND OVERLAY PROJECT

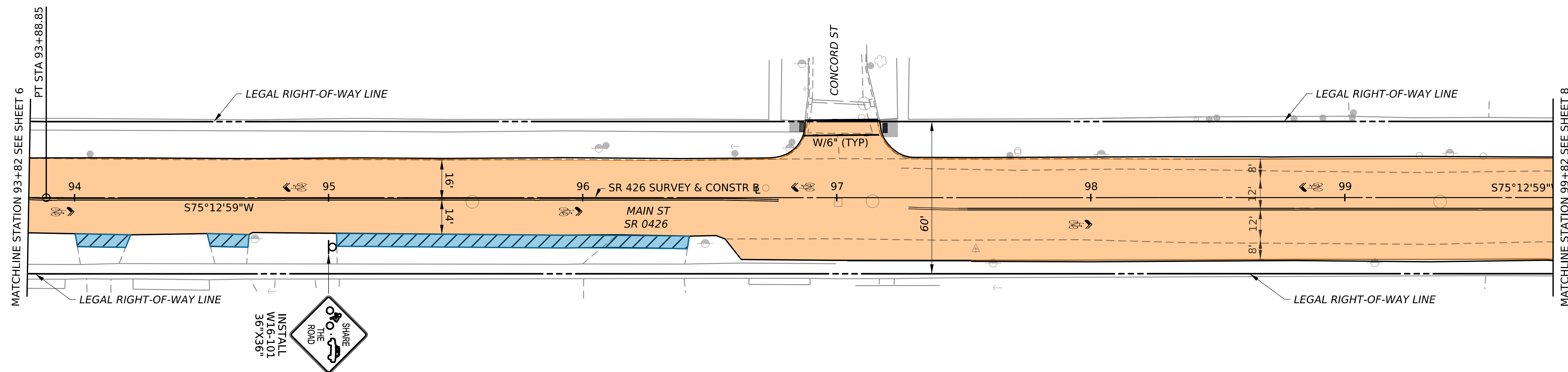
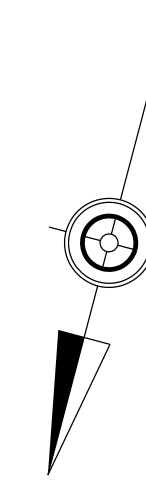



CONTACTS

ANY QUESTIONS OR CONCERNS CAN BE DIRECTED TO THE FOLLOWING:

CHRISTINE BOYER-KRANTZ, P.E. PENNDOT PROJECT MANAGER 225 ELM STREET OIL CITY, PA 16301 CHBOYER@PA.GOV (814) 678-7379	LODOVICO (VICO) C. INNOCENTI, P.E. FISHER ASSOCIATES CONSULTANT PROJECT MANAGER 121 HILLPOINTE DR, SUITE 100 CANONSBURG, PA 15317 LINNOCENTI@FISHERASSOC.COM (724) 916-4250 EXT 394
---	---

LEGEND

-  DRIVEWAY ADJUSTMENT
-  MILL AND OVERLAY

SCALE

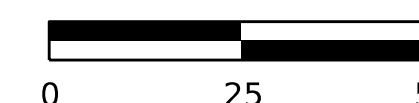

OPERATOR: jbaillly
FILE NAME: H:\Projects\22\220651-00-E05514Erie_Grp3\Eng\CAD\InRoads\25 0426 01M ALT3.dgn

PLOTTED: 25-MAR-2025 09:02

PRELIMINARY
STATE ROUTE 0426 SECTION 01M
CITY OF CORRY, ERIE COUNTY
MILL AND OVERLAY PROJECT

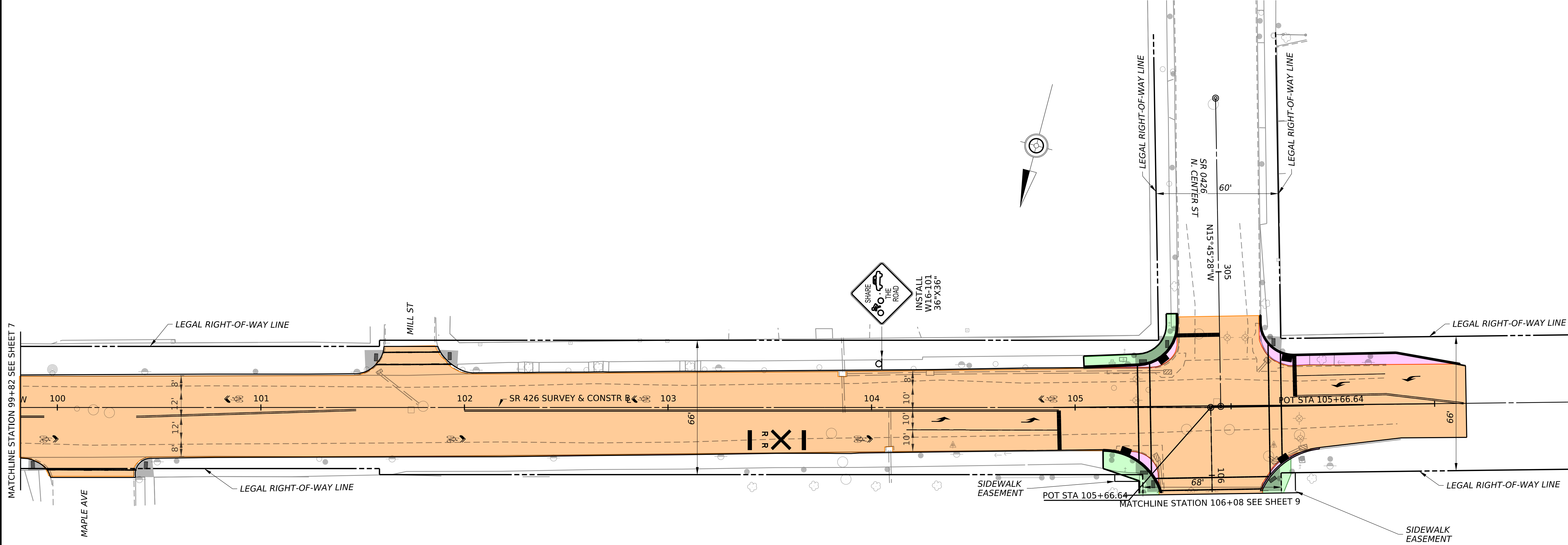

CONTACTS

ANY QUESTIONS OR CONCERNS CAN BE DIRECTED TO THE FOLLOWING:

CHRISTINE BOYER-KRANTZ, P.E. PENNDOT PROJECT MANAGER 225 ELM STREET OIL CITY, PA 16301 CHBOYER@PA.GOV (814) 678-7379	LODOVICO (VICO) C. INNOCENTI, P.E. FISHER ASSOCIATES CONSULTANT PROJECT MANAGER 121 HILLPOINTE DR, SUITE 100 CANONSBURG, PA 15317 LINNOCENTI@FISHERASSOC.COM (724) 916-4250 EXT 394
---	---

LEGEND

- MILL AND OVERLAY
- FULL DEPTH RECONSTRUCTION ROADWAY
- PROPOSED SIDEWALK

SCALE



OPERATOR: jbaillly
FILE NAME: H:\Projects\22\220651-00-E05514Erie_Grp3\Eng\CAD\InRoads\25 0426 01M ALT3.dgn

PRELIMINARY
 STATE ROUTE 0426 SECTION 01M
 CITY OF CORRY, ERIE COUNTY
 MILL AND OVERLAY PROJECT

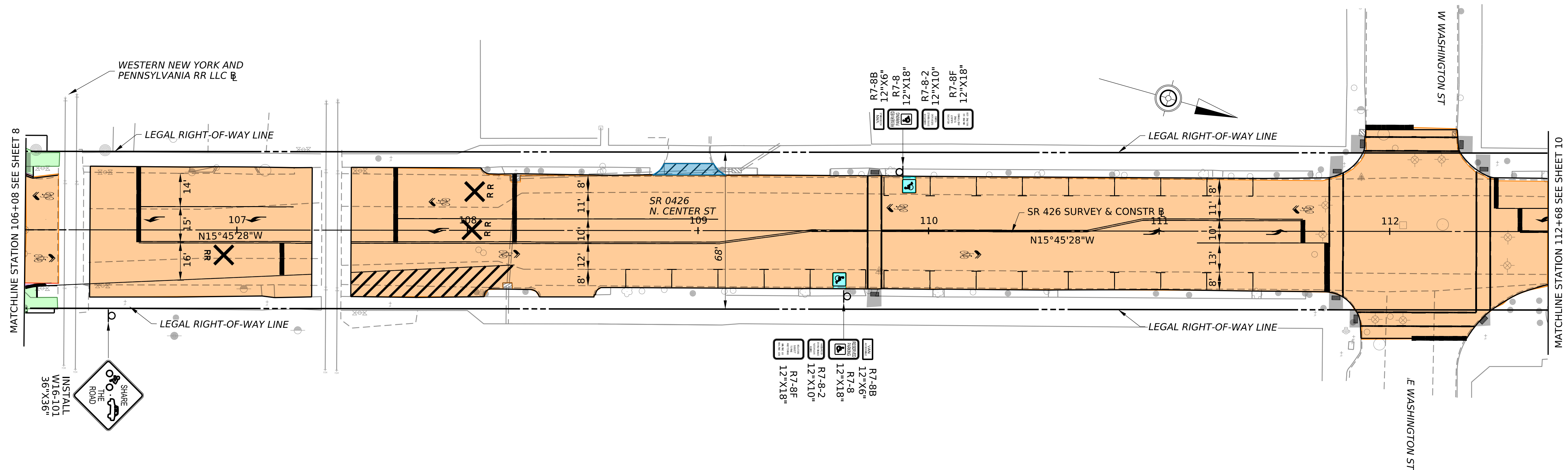





CONTACTS

ANY QUESTIONS OR CONCERNS CAN BE DIRECTED TO THE FOLLOWING:

CHRISTINE BOYER-KRANTZ, P.E. PENNDOT PROJECT MANAGER 225 ELM STREET OIL CITY, PA 16301 CHBOYER@PA.GOV (814) 678-7379	LODOVICO (VICO) C. INNOCENTI, P.E. FISHER ASSOCIATES CONSULTANT PROJECT MANAGER 121 HILLPOINTE DR, SUITE 100 CANONSBURG, PA 15317 LINNOCENTI@FISHERASSOC.COM (724) 916-4250 EXT 394
---	---

LEGEND

-  DRIVEWAY ADJUSTMENT
-  MILL AND OVERLAY
-  FULL DEPTH RECONSTRUCTION ROADWAY
-  PROPOSED SIDEWALK

SCALE

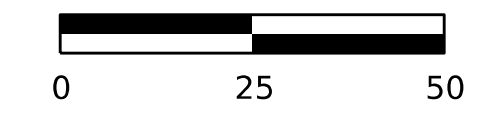

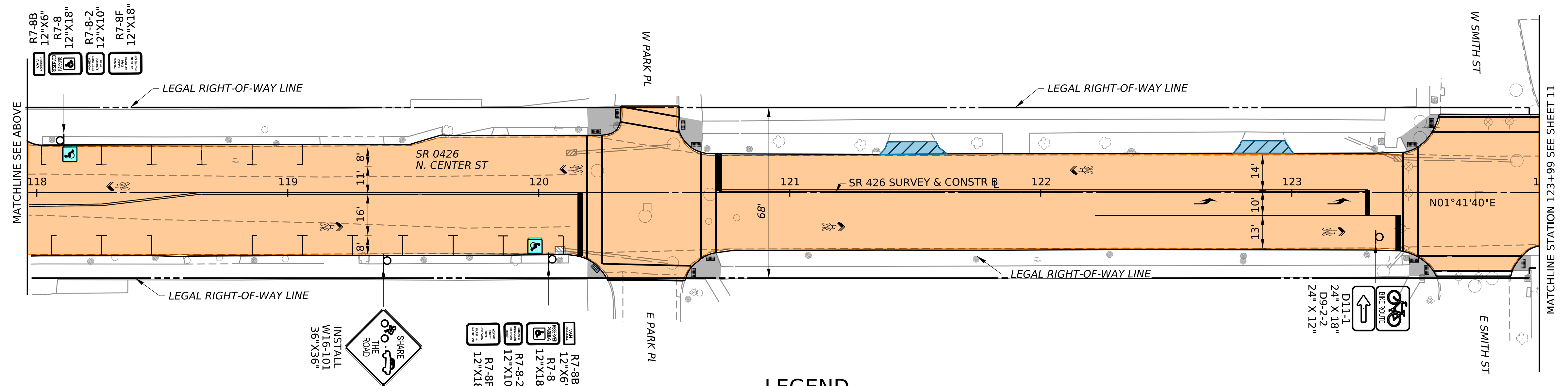
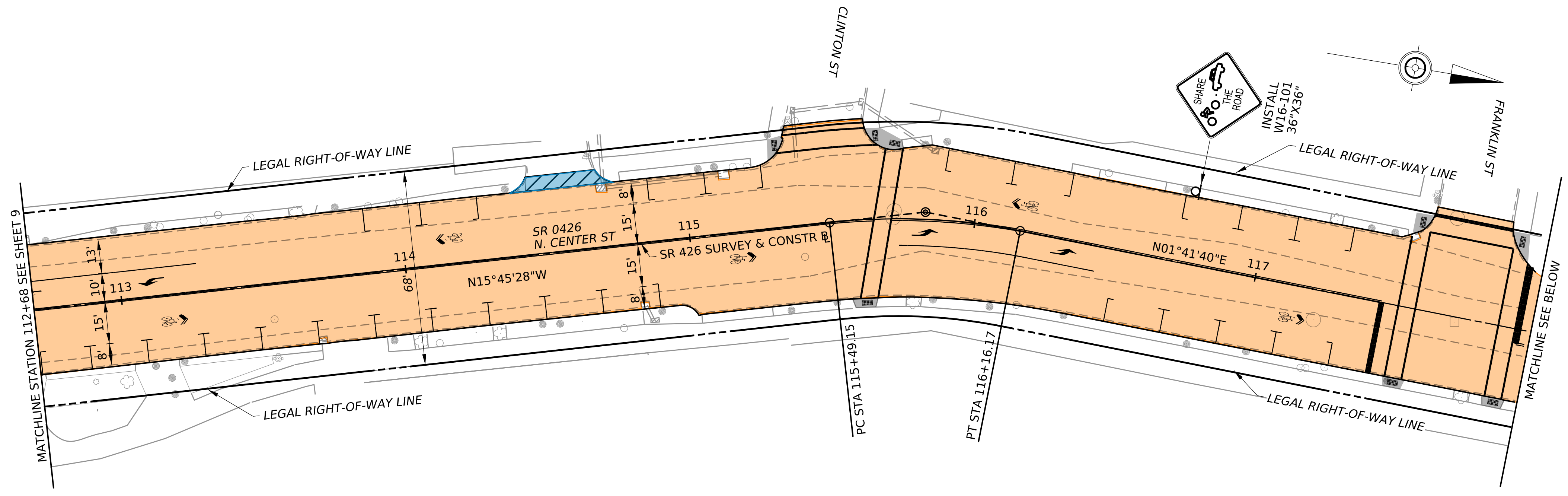

PLOTTED: 25-MAR-2025 09:02

PRELIMINARY
STATE ROUTE 0426 SECTION 01M
CITY OF CORRY, ERIE COUNTY
MILL AND OVERLAY PROJECT

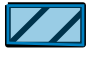

LEGEND

-  DRIVEWAY ADJUSTMENT
-  MILL AND OVERLAY

CONTACTS

ANY QUESTIONS OR CONCERNS CAN BE DIRECTED TO THE FOLLOWING:

CHRISTINE BOYER-KRANTZ, P.E. PENNDOT PROJECT MANAGER 225 ELM STREET OIL CITY, PA 16301 CHBOYER@PA.GOV (814) 678-7379	LODOVICO (VICO) C. INNOCENTI, P.E. FISHER ASSOCIATES CONSULTANT PROJECT MANAGER 121 HILLPOINTE DR, SUITE 100 CANONSBURG, PA 15317 LINNOCENTI@FISHERASSOC.COM (724) 916-4250 EXT 394
---	---

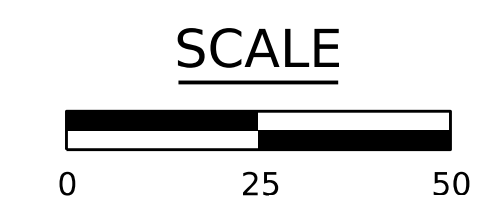

OPERATOR: jbaillly
FILE NAME: H:\Projects\221220651-00-E05514Erie_Grp3\Eng\CAD\InRoads\25 0426 01M ALT3.dgn

PRELIMINARY
STATE ROUTE 0426 SECTION 01M
CITY OF CORRY, ERIE COUNTY
MILL AND OVERLAY PROJECT

PLOTTED: 25-MAR-2025 09:02

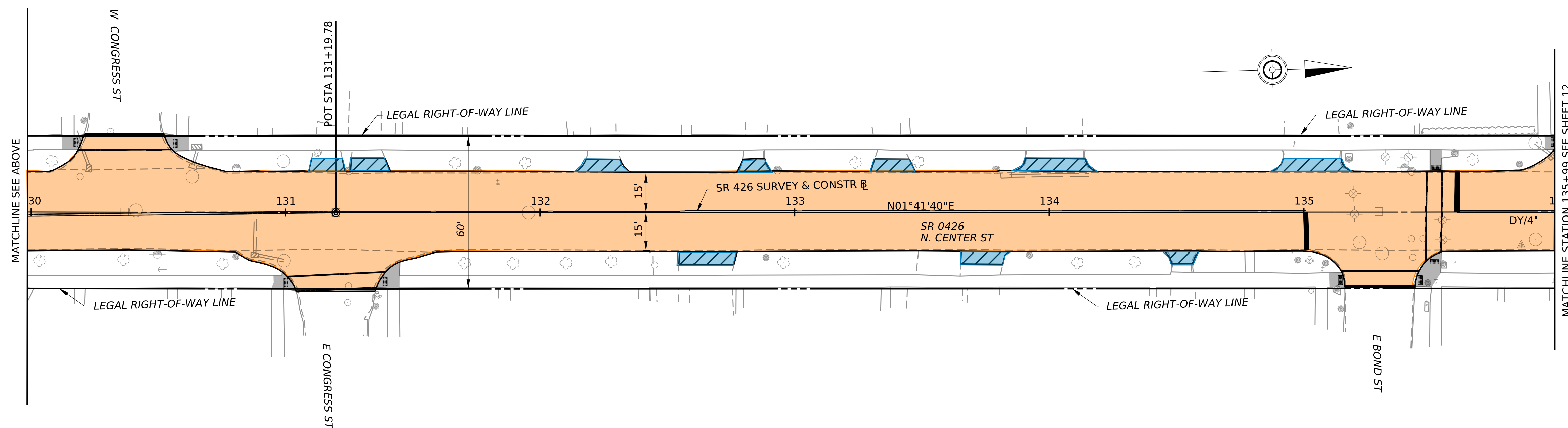
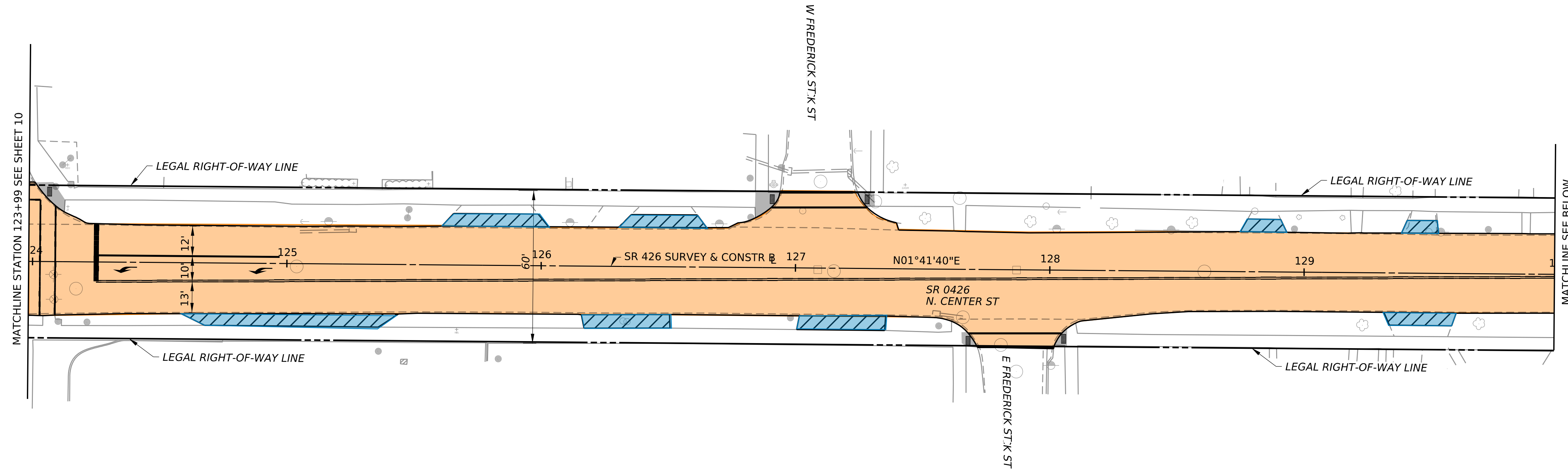
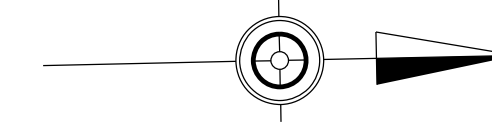



CONTACTS

ANY QUESTIONS OR CONCERNS CAN BE DIRECTED TO THE FOLLOWING:

CHRISTINE BOYER-KRANTZ, P.E. PENNDOT PROJECT MANAGER 225 ELM STREET OIL CITY, PA 16301 CHBOYER@PA.GOV (814) 678-7379	LODOVICO (VICO) C. INNOCENTI, P.E. FISHER ASSOCIATES CONSULTANT PROJECT MANAGER 121 HILLPOINTE DR, SUITE 100 CANONSBURG, PA 15317 LINNOCENTI@FISHERASSOC.COM (724) 916-4250 EXT 394
---	---

LEGEND

-  DRIVEWAY ADJUSTMENT
-  MILL AND OVERLAY

SCALE



OPERATOR: jBailey
FILE NAME: H:\Projects\22\220651-00-E05514Erie_Grp3\Eng\CAD\InRoads\25_0426_01M_ALT3.dgn

PLOTTED: 25-MAR-2025 09:02

PRELIMINARY
STATE ROUTE 0426 SECTION 01M
CITY OF CORRY, ERIE COUNTY
MILL AND OVERLAY PROJECT

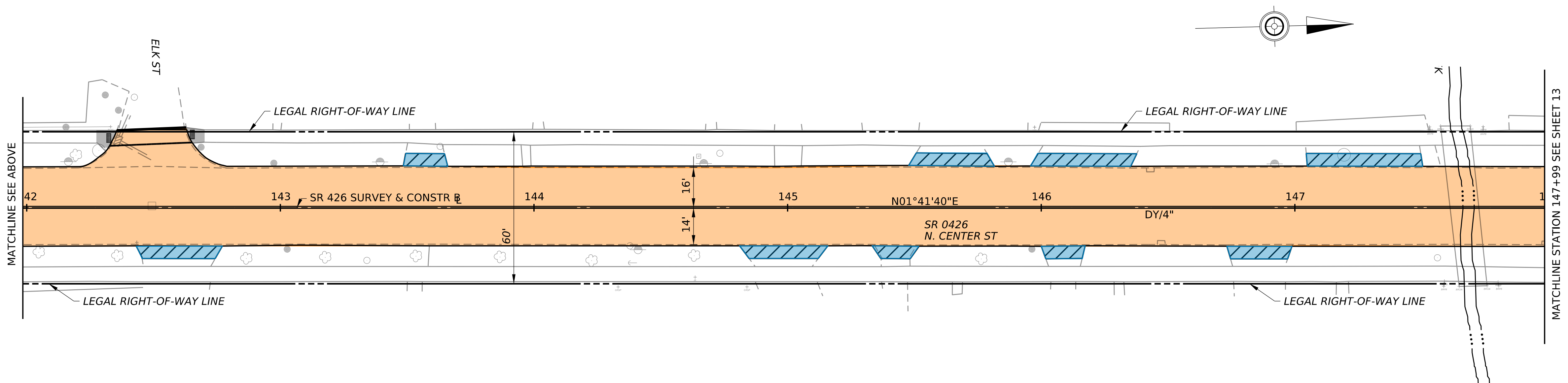
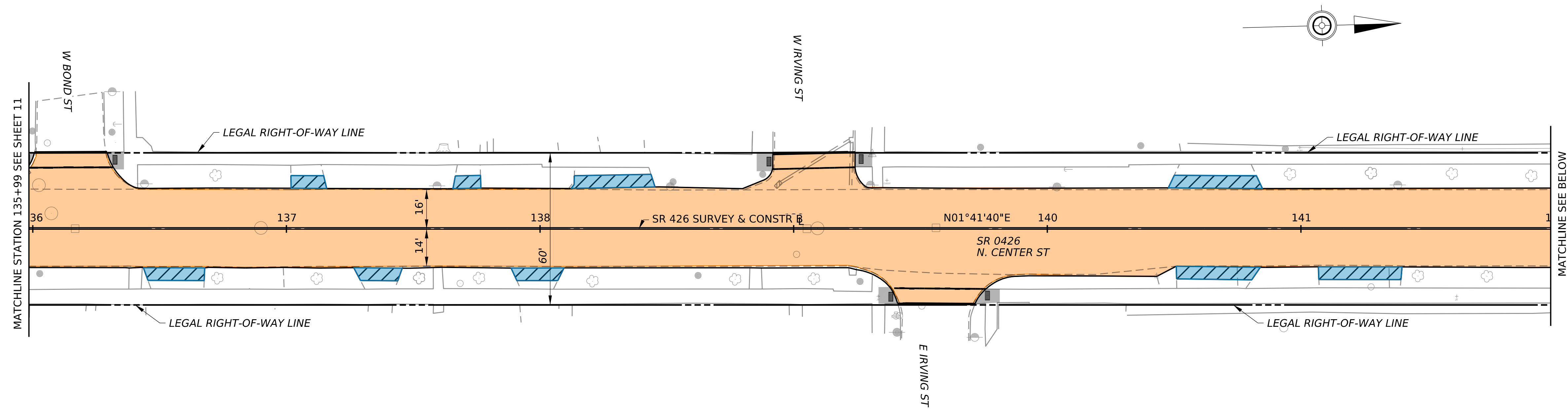



CONTACTS

ANY QUESTIONS OR CONCERNS CAN BE DIRECTED TO THE FOLLOWING:

CHRISTINE BOYER-KRANTZ, P.E. PENNDOT PROJECT MANAGER 225 ELM STREET OIL CITY, PA 16301 CHBOYER@PA.GOV (814) 678-7379	LODOVICO (VICO) C. INNOCENTI, P.E. FISHER ASSOCIATES CONSULTANT PROJECT MANAGER 121 HILLPOINTE DR, SUITE 100 CANONSBURG, PA 15317 LINNOCENTI@FISHERASSOC.COM (724) 916-4250 EXT 394
---	---

LEGEND

-  DRIVEWAY ADJUSTMENT
-  MILL AND OVERLAY

SCALE

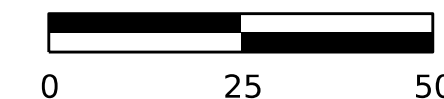

OPERATOR: jbaillly
FILE NAME: H:\Projects\22\220651-00-E05514Erie_Grp3\Eng\CAD\InRoads\25 0426 01M ALT3.dgn

PLOTTED: 25-MAR-2025 09:02

PRELIMINARY
STATE ROUTE 0426 SECTION 01M
CITY OF CORRY, ERIE COUNTY
MILL AND OVERLAY PROJECT

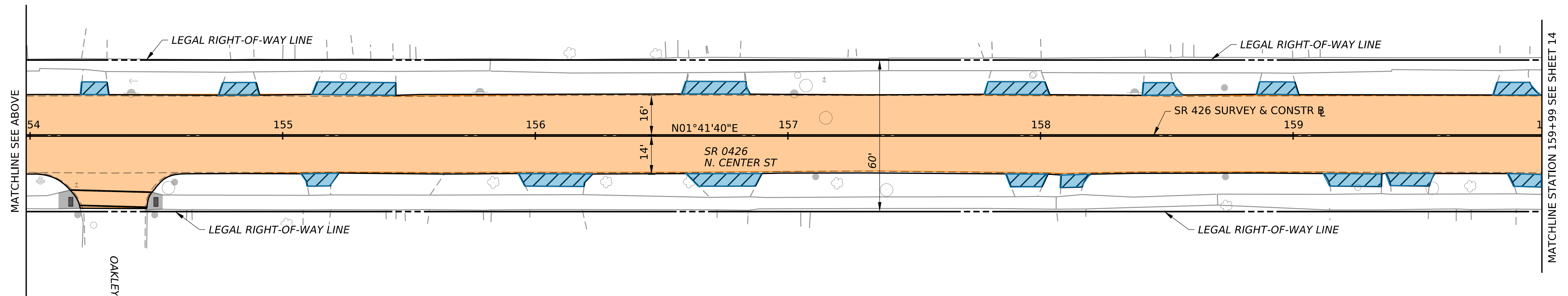
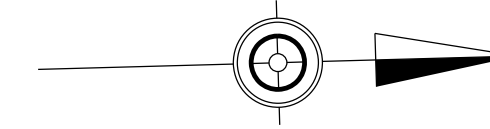
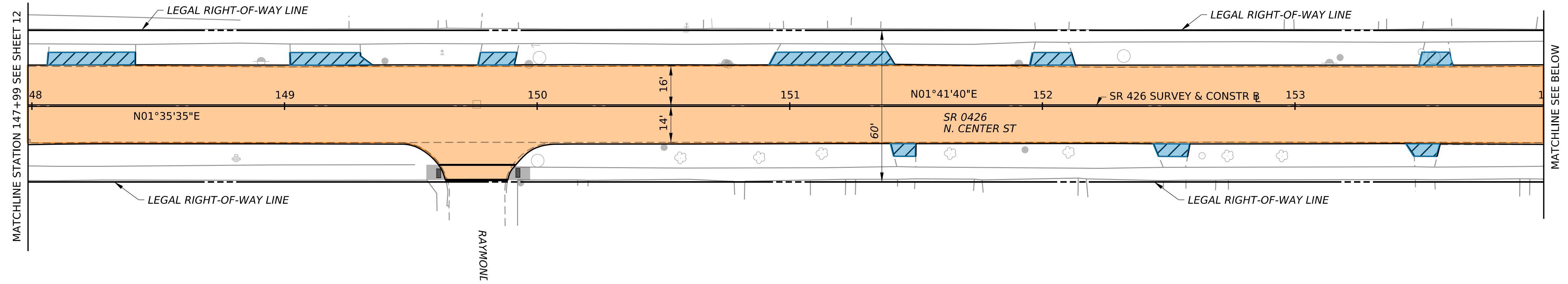
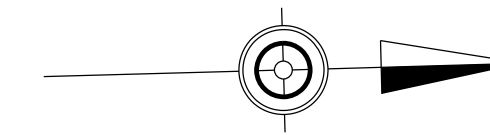



CONTACTS

ANY QUESTIONS OR CONCERNS CAN BE DIRECTED TO THE FOLLOWING:

CHRISTINE BOYER-KRANTZ, P.E. PENNDOT PROJECT MANAGER 225 ELM STREET OIL CITY, PA 16301 CHBOYER@PA.GOV (814) 678-7379	LODOVICO (VICO) C. INNOCENTI, P.E. FISHER ASSOCIATES CONSULTANT PROJECT MANAGER 121 HILLPOINTE DR, SUITE 100 CANONSBURG, PA 15317 LINNOCENTI@FISHERASSOC.COM (724) 916-4250 EXT 394
---	---

LEGEND

-  DRIVEWAY ADJUSTMENT
-  MILL AND OVERLAY

SCALE

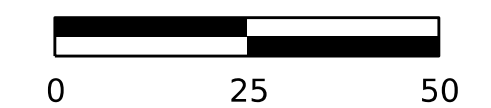

OPERATOR: jbaillly
FILE NAME: H:\Projects\22\220651-00-E05514Erie_Grp3\Eng\CAD\InRoads\25 0426 01M ALT3.dgn

PLOTTED: 25-MAR-2025 10:28

PRELIMINARY
STATE ROUTE 0426 SECTION 01M
CITY OF CORRY, ERIE COUNTY
MILL AND OVERLAY PROJECT

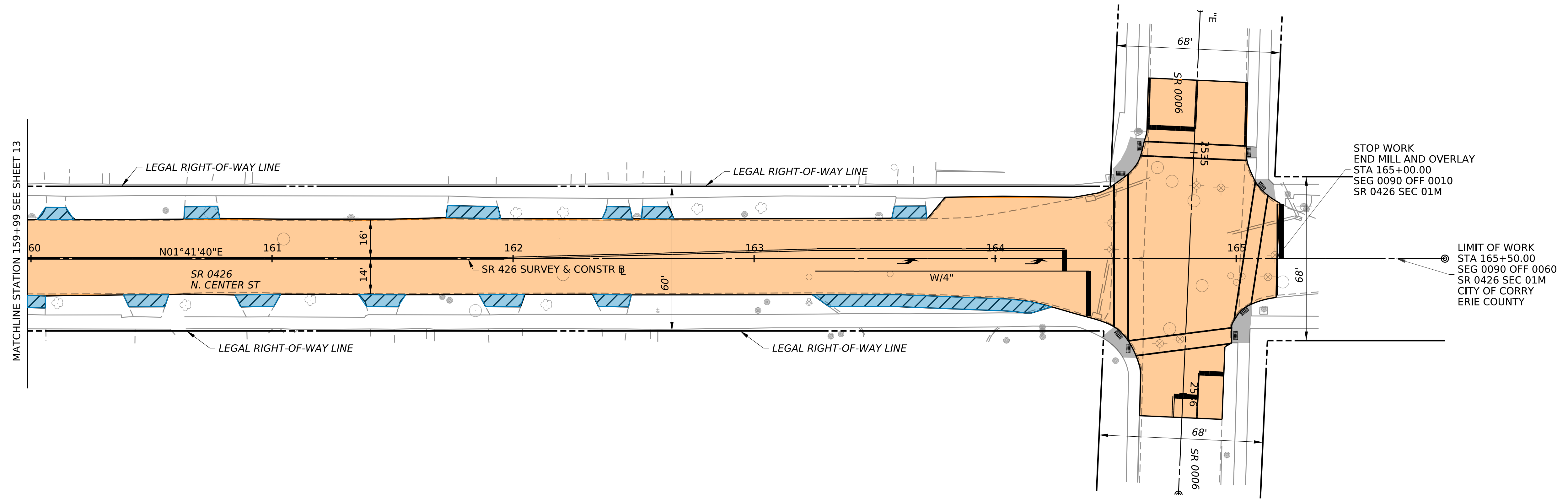



CONTACTS

ANY QUESTIONS OR CONCERNS CAN BE DIRECTED TO THE FOLLOWING:

CHRISTINE BOYER-KRANTZ, P.E. PENNDOT PROJECT MANAGER 225 ELM STREET OIL CITY, PA 16301 CHBOYER@PA.GOV (814) 678-7379	LODOVICO (VICO) C. INNOCENTI, P.E. FISHER ASSOCIATES CONSULTANT PROJECT MANAGER 121 HILLPOINTE DR, SUITE 100 CANONSBURG, PA 15317 LINNOCENTI@FISHERASSOC.COM (724) 916-4250 EXT 394
---	---

LEGEND

-  DRIVEWAY ADJUSTMENT
-  MILL AND OVERLAY

SCALE



OPERATOR: jbaillly
FILE NAME: H:\Projects\22\220651-00-E05514Erie_Grp3\Eng\CAD\InRoads\25 0426 01M ALT3.dgn

PLOTTED: 27-NOV-2024 15:55

OPERATOR: TPrezel
FILE NAME: H:\Projects\22220651-00-E05514Erie_Grp3\Eng\CAD\CUT\426 Alt Typical.dgn

DISTRICT	COUNTY	ROUTE	SECTION	SHEET
1-0	ERIE	0426	01M	2 OF 32
CITY OF CORRY				
REV NO	REVISIONS	DATE	BY	APPD

- LEGEND**
- (A) ITEM #0413-0245
SUPERPAVE ASPHALT MIXTURE DESIGN,
WEARING COURSE, PG 64S-22, 0.3 TO <3 MILLION ESALS,
9.5 MM MIX, 1 1/2" DEPTH, SRL-H
 - (B) ITEM #0413-1024
SUPERPAVE ASPHALT MIXTURE DESIGN,
WEARING COURSE (SCRATCH), PG 64S-22, 0.3 TO <3 MILLION ESALS,
9.5 MM MIX, SRL-L
 - (C) ITEM #0460-0003
ASPHALT TACK COAT (NTT/CNTT)
 -  ITEM #4491-0019
MILLING OF ASPHALT PAVEMENT SURFACE, VARIABLE DEPTH, MILLED
MATERIAL RETAINED BY CONTRACTOR,
SHOULDER BACKUP (2" TARGET DEPTH)

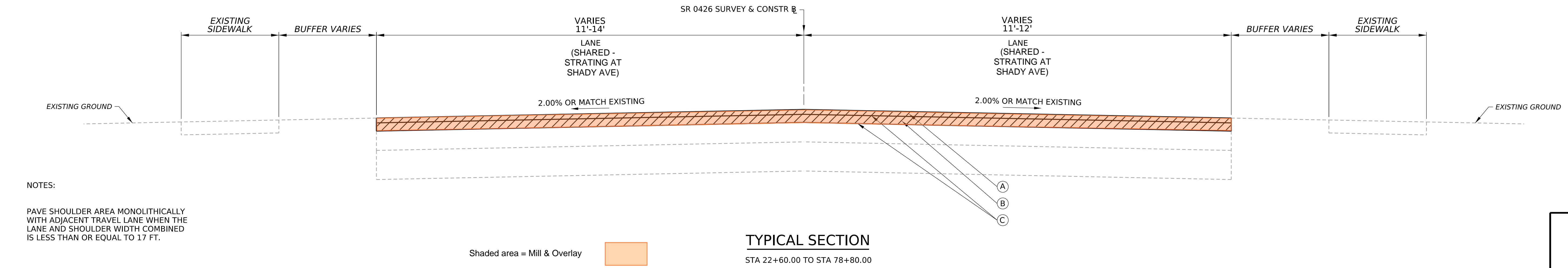
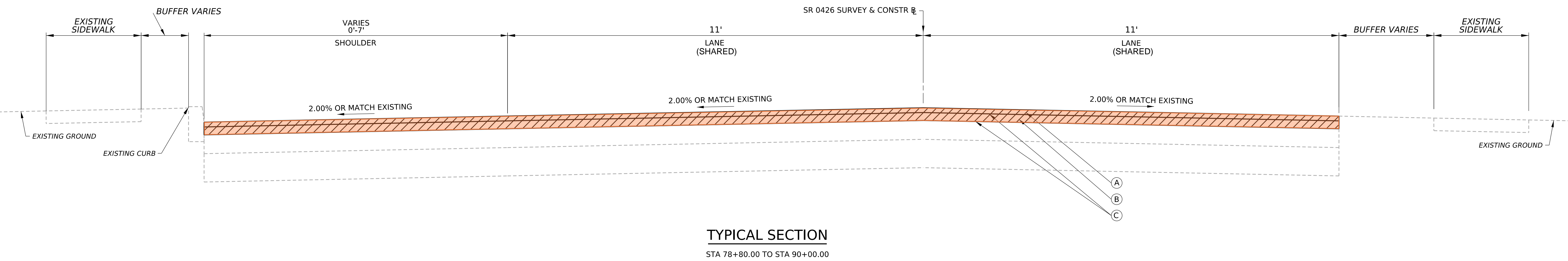
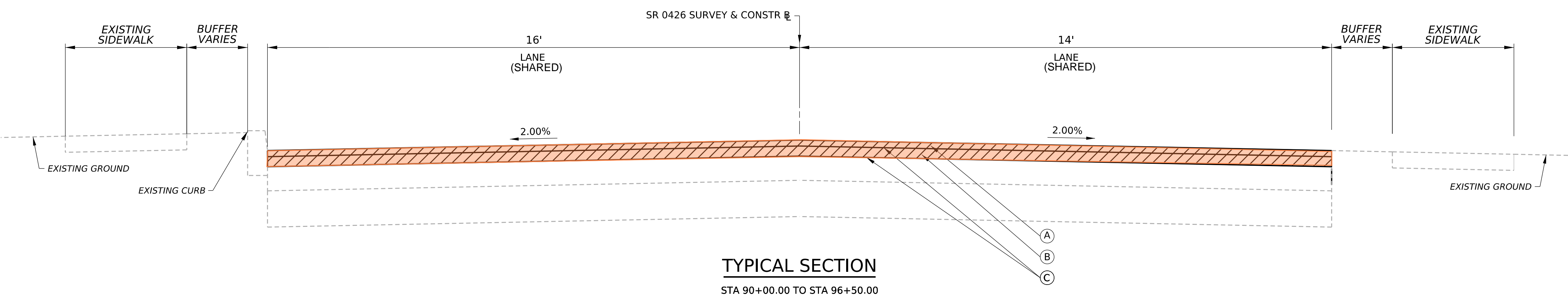

NOTES:
PAVE SHOULDER AREA MONOLITHICALLY WITH ADJACENT TRAVEL LANE WHEN THE LANE AND SHOULDER WIDTH COMBINED IS LESS THAN OR EQUAL TO 17 FT.

Shaded area = Mill & Overlay 

TYPICAL SECTIONS

PLOTTED: 27-NOV-2024 15:55

OPERATOR: TPrezel
 FILE NAME: H:\Projects\221220651-00-E05514Erie_Grp3\Eng\CAD\CUT\426 Alt Typical.dgn

DISTRICT	COUNTY	ROUTE	SECTION	SHEET
1-0	ERIE	0426	01M	3 OF 32
CITY OF CORRY				
REV NO	REVISIONS	DATE	BY	APPD

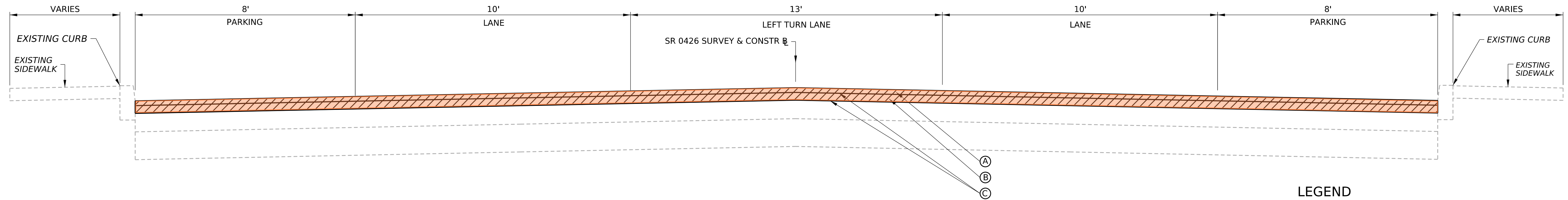

TYPICAL SECTION
 STA 105+27.31 TO STA 108+00.00

- LEGEND**
- (A) ITEM #0413-0245
 SUPERPAVE ASPHALT MIXTURE DESIGN,
 WEARING COURSE, PG 64S-22, 0.3 TO <3 MILLION ESALS,
 9.5 MM MIX, 1 1/2" DEPTH, SRL-H
 - (B) ITEM #0413-1024
 SUPERPAVE ASPHALT MIXTURE DESIGN,
 WEARING COURSE (SCRATCH), PG 64S-22, 0.3 TO <3 MILLION ESALS,
 9.5 MM MIX, SRL-L
 - (C) ITEM #0460-0003
 ASPHALT TACK COAT (NTT/CNTT)
 - [Hatched Box] ITEM #4491-0019
 MILLING OF ASPHALT PAVEMENT SURFACE, VARIABLE DEPTH, MILLED
 MATERIAL RETAINED BY CONTRACTOR,
 SHOULDER BACKUP (2" TARGET DEPTH)

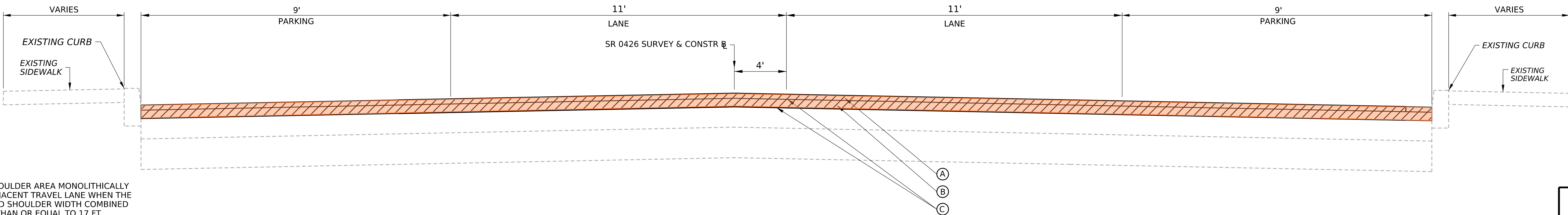

TYPICAL SECTION
 STA 96+50.00 TO STA 105+27.31

NOTES:
 PAVE SHOULDER AREA MONOLITHICALLY
 WITH ADJACENT TRAVEL LANE WHEN THE
 LANE AND SHOULDER WIDTH COMBINED
 IS LESS THAN OR EQUAL TO 17 FT.

Shaded area = Mill & Overlay

TYPICAL SECTIONS

PLOTTED: 27-NOV-2024 15:55

OPERATOR: TPrezel
FILE NAME: H:\Projects\221220651-00-E05514Erie_Grp3\Eng\CAD\CUT\426 Alt Typical.dgn

DISTRICT	COUNTY	ROUTE	SECTION	SHEET
1-0	ERIE	0426	01M	4 OF 32
CITY OF CORRY				
REV NO	REVISIONS	DATE	BY	APPD

- LEGEND**
- (A) ITEM #0413-0245
SUPERPAVE ASPHALT MIXTURE DESIGN,
WEARING COURSE, PG 64S-22, 0.3 TO <3 MILLION ESALS,
9.5 MM MIX, 1 1/2" DEPTH, SRL-H
 - (B) ITEM #0413-1024
SUPERPAVE ASPHALT MIXTURE DESIGN,
WEARING COURSE (SCRATCH), PG 64S-22, 0.3 TO <3 MILLION ESALS,
9.5 MM MIX, SRL-L
 - (C) ITEM #0460-0003
ASPHALT TACK COAT (NTT/CNTT)
 -  ITEM #4491-0019
MILLING OF ASPHALT PAVEMENT SURFACE, VARIABLE DEPTH, MILLED
MATERIAL RETAINED BY CONTRACTOR,
SHOULDER BACKUP (2" TARGET DEPTH)

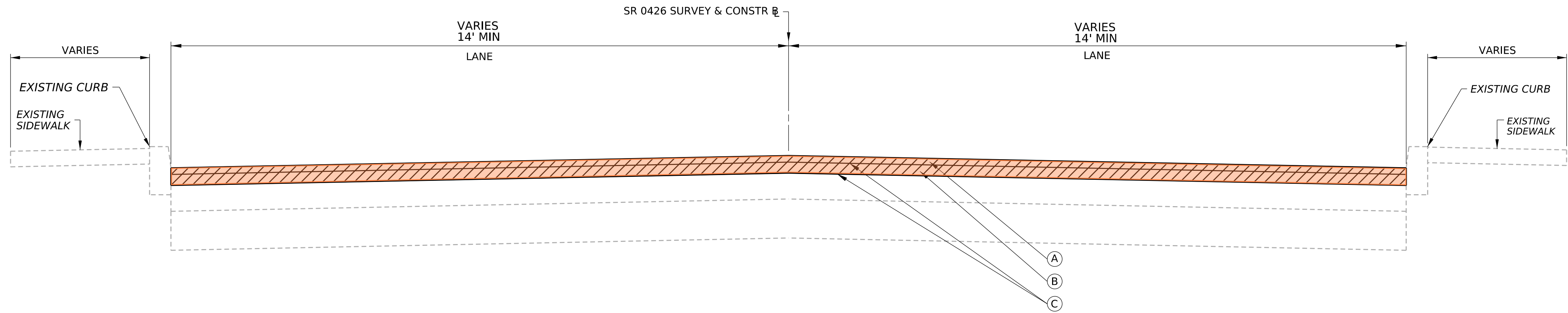

TYPICAL SECTION
STA 120+15.00 TO STA 165+17.00

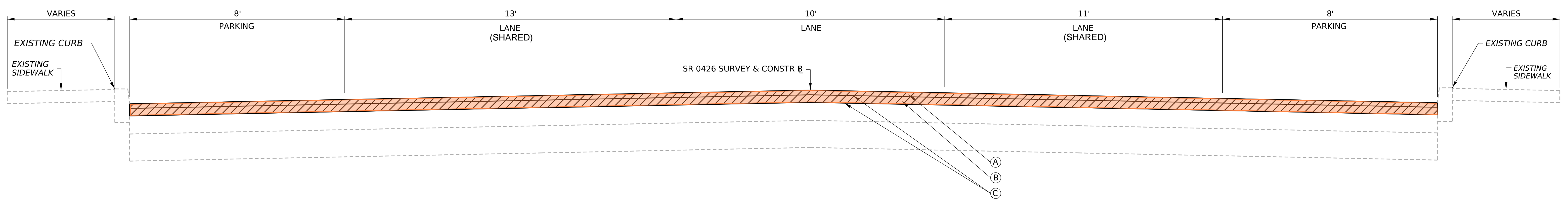

Shaded area = Mill & Overlay 

TYPICAL SECTION
STA 107+84.00 TO STA 120+15.00

TYPICAL SECTIONS