

SR 3018 OVER KETTLE CREEK BRIDGE PROJECT

Hamilton Township, Monroe County

BRIDGE FEATURES:

- BUILT IN 1912 (REINFORCED CONCRETE SLAB)
- WIDENED IN 1964
- BRIDGE IS IN POOR CONDITION

PURPOSE:

- REPLACE THE EXISTING BRIDGE IN A WAY THAT WILL MAINTAIN THE EXISTING CROSSING, MEETS CURRENT DESIGN STANDARDS, AND MINIMIZES THE IMPACTS DURING CONSTRUCTION.

PROJECT SCHEDULE:

- PRELIMINARY AND FINAL ENGINEERING (PRESENT TO FALL 2026)
- AWARD CONTRACT (FALL/WINTER 2026)
- CONSTRUCTION (SPRING 2028 TO FALL/WINTER 2028)



TYPICAL ROADWAY VIEW



TYPICAL ELEVATION VIEW



EXISTING DRY-STACK WALL

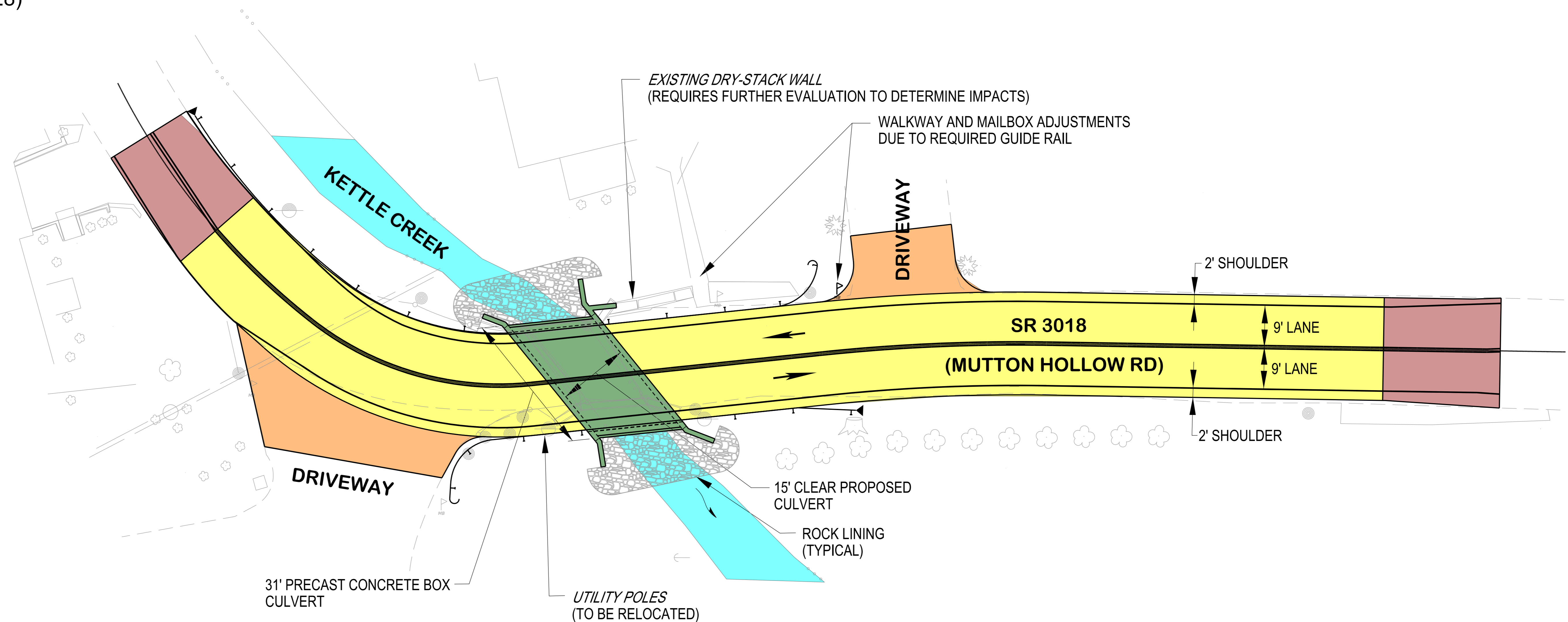

LEGEND

- DRIVEWAY RECONSTRUCTION
- MILL AND OVERLAY
- FULL-DEPTH ROADWAY
- BRIDGE
- KETTLE CREEK

PRELIMINARY

SR 3018 OVER KETTLE CREEK BRIDGE PROJECT

Hamilton Township, Monroe County

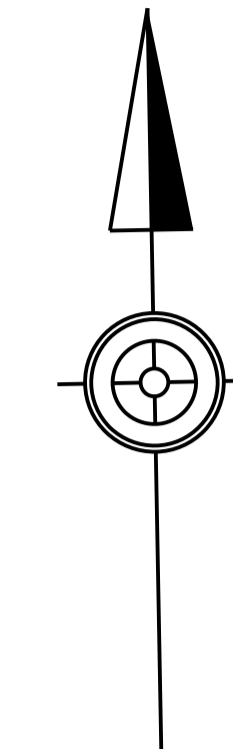
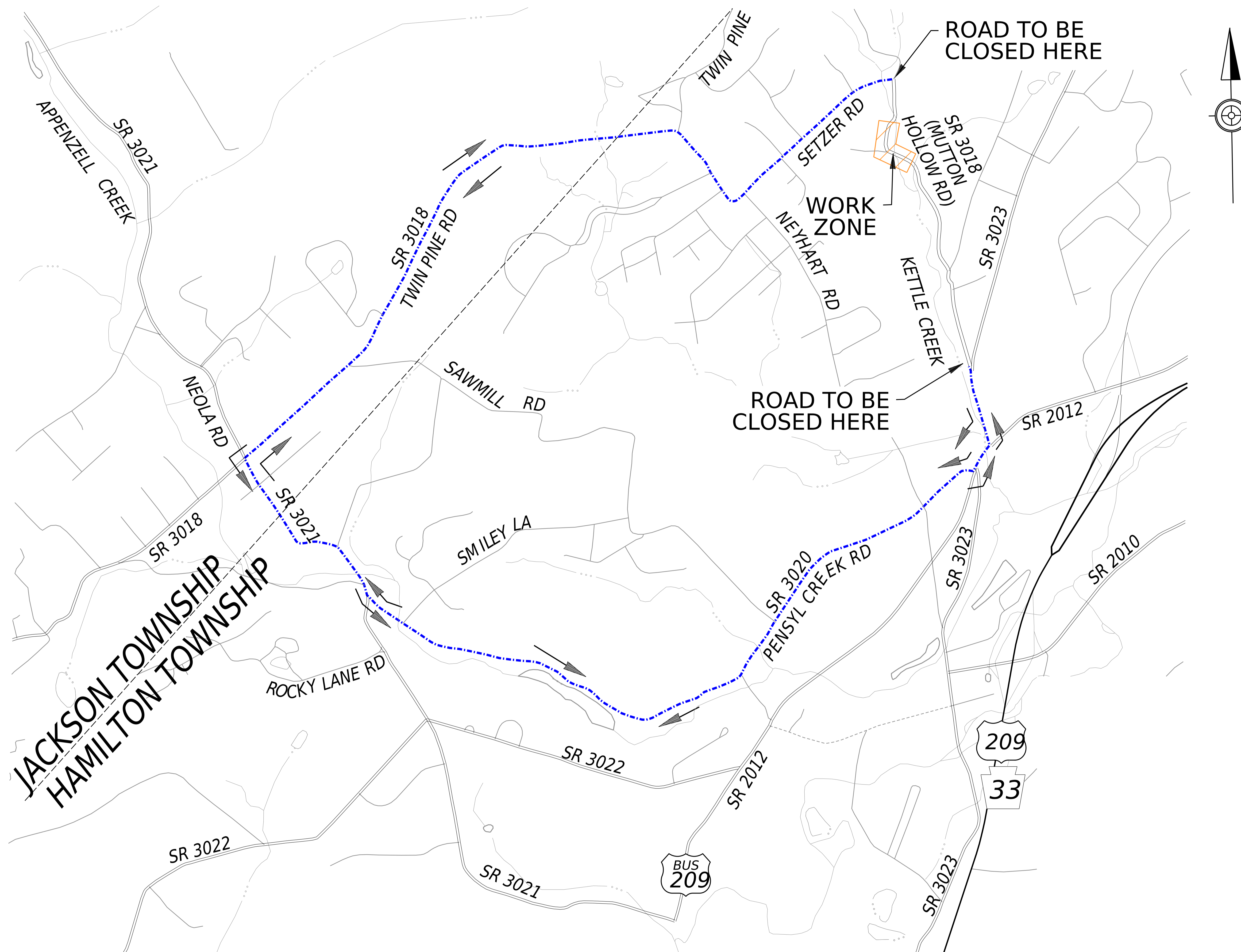

LEGEND

- STATE HIGHWAY
- INTERSTATE
- LOCAL ROAD
- MUNICIPAL BOUNDARY
- DETOUR (7.6 MILES)
- WATERWAY
- WORK ZONE

PRELIMINARY



PROJECT DETAILS
Fall 2024

