

SR 1005, SECTION A06 HIGHLAND PARK BRIDGE PRESERVATION & SR 0008 WASHINGTON BLVD INTERCHANGE RAMPS

CITY OF PITTSBURGH AND O'HARA TOWNSHIP, ALLEGHENY COUNTY

VIRTUAL PUBLIC MEETING



JANUARY 22, 2025



SR 1005, SECTION A06 HIGHLAND PARK BRIDGE PRESERVATION & SR 0008 WASHINGTON BLVD INTERCHANGE RAMPS

CITY OF PITTSBURGH AND O'HARA TOWNSHIP, ALLEGHENY COUNTY

THE VIRTUAL PUBLIC MEETING PRESENTATION WILL BEGIN SHORTLY...



JANUARY 22, 2025



MICROSOFT TEAMS LIVE NAVIGATION

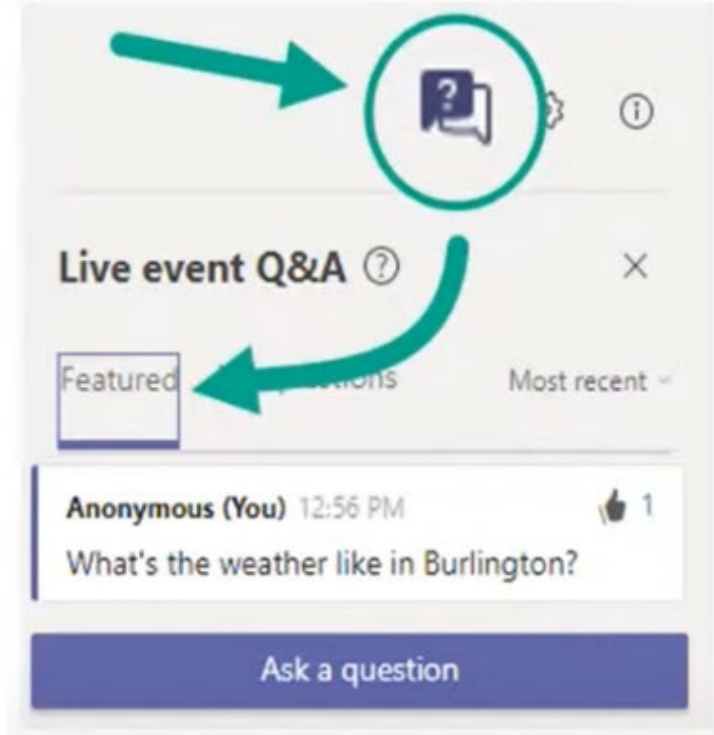

This meeting is
being recorded

Q&A Questions will be answered at the
end of the presentation



MEETING PRESENTERS



Doug Seeley, PE
PennDOT District 11-0
Assistant District Executive,
Design Division

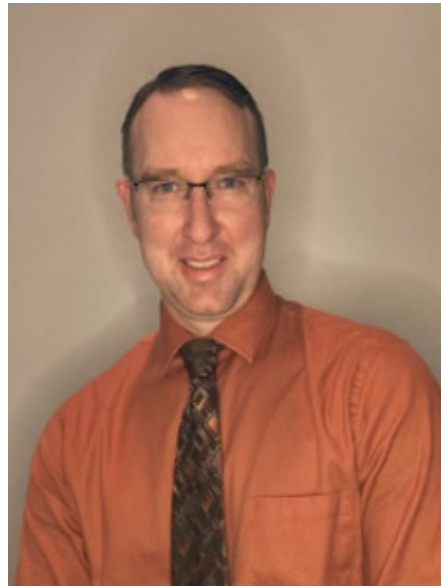

Erik Porter, PE
PennDOT District 11-0
District Project Manager



Nick Krobot, PE
PennDOT District 11-0
Assistant Environmental Manager



Steve Rodgers, PE
Lochner
Consultant Project Manager



PROJECT TEAM



PennDOT District 11-0

- **Steve Cowan** - District Press Officer
- **Nicole Haney** - Community Relations Coordinator
- **John Zelesnak, PE** - Portfolio Manager/Project Delivery Unit
- **Shane Szalankiewicz, PE** - District Bridge Engineer
- **Jacqueline Evans, PE** - District Right of Way Administrator
- **Ethan Bailey** - Chief Right of Way Negotiator
- **Mark Young** - District Environmental Planning Manager
- **Steve Sneddon, PE** - Assistant Construction Engineer



Lochner

- **Chris West**, Roadway Project Lead



PROJECT LOCATION

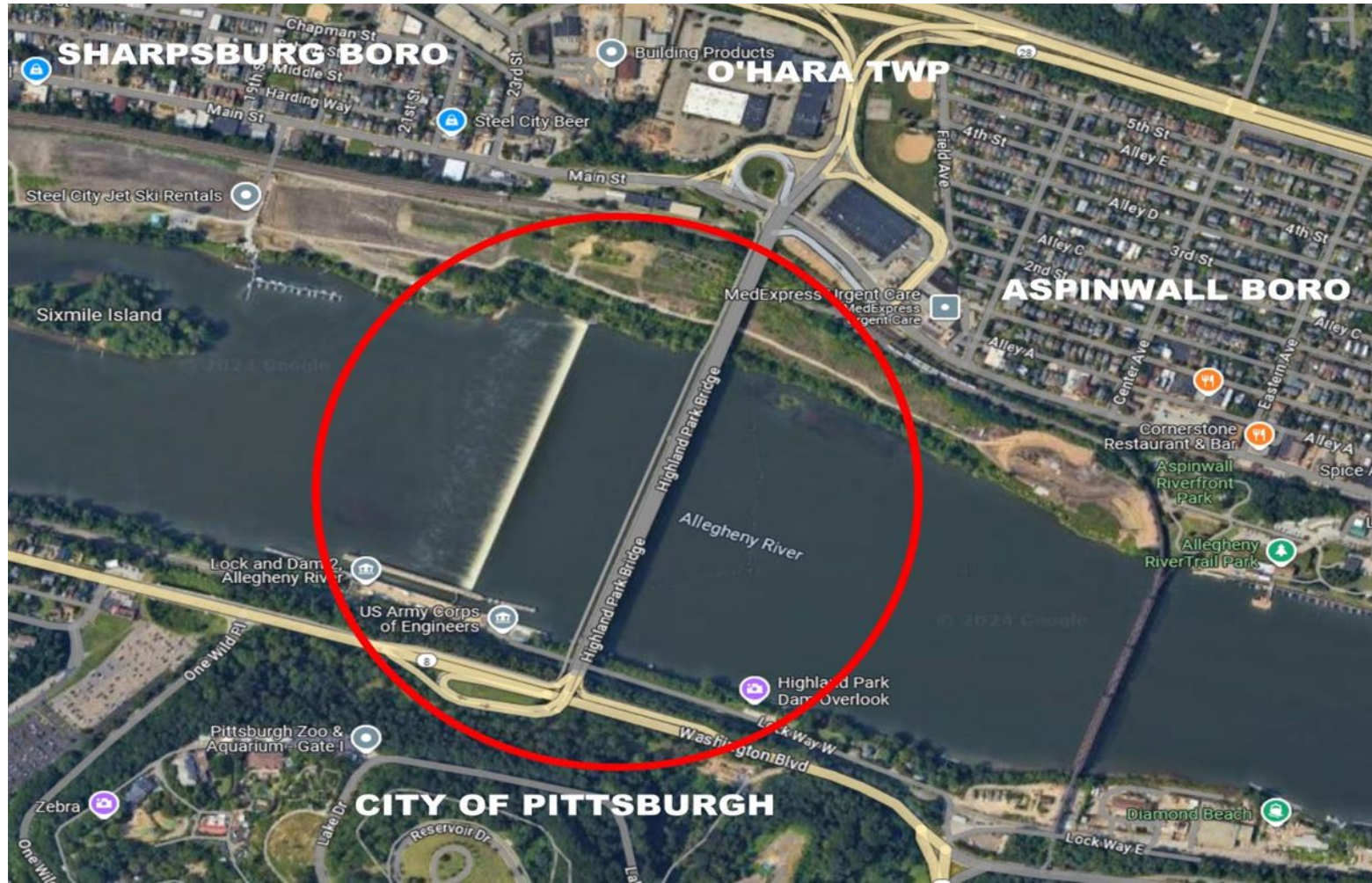

AGENDA

- **Introduction -**
 - Microsoft Teams Live Navigation
 - Project Team Introductions
 - Project Location
- **Preliminary Project Details -**
 - Project Purpose
 - Anticipated Project Schedule
 - Proposed Project Improvements
 - Preliminary Right-of-Way Impacts
 - Project Overview
 - Anticipated Traffic Control
 - Recreational and Historic Resources
- **Project Comment Form**
- **Question and Answer Session**



PROJECT PURPOSE

The purpose of this project is to maintain sustainable crossings over the Allegheny River and SR 8 (Butler Street/Washington Boulevard).



ANTICIPATED PROJECT SCHEDULE

Anticipated Project Schedule

2025				2026				2027				2028				2029			
Winter	Spring	Summer	Fall	Winter	Spring	Summer	Fall	Winter	Spring	Summer	Fall	Winter	Spring	Summer	Fall	Winter	Spring		
Preliminary Engineering																			
	Final Design																		
										Construction									

- Preliminary Engineering – Anticipated Completion Spring/Summer 2025
- Final Design – Anticipated Spring/Summer 2025 through Mid-2027
- Construction – Anticipated Mid-2027 into 2029



STRUCTURE PLAN & ELEVATION

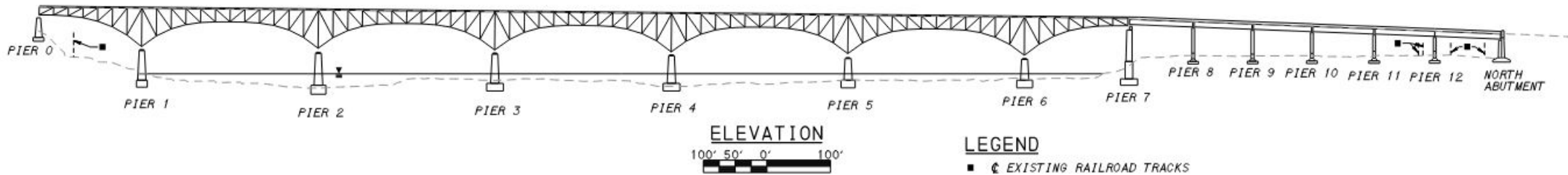
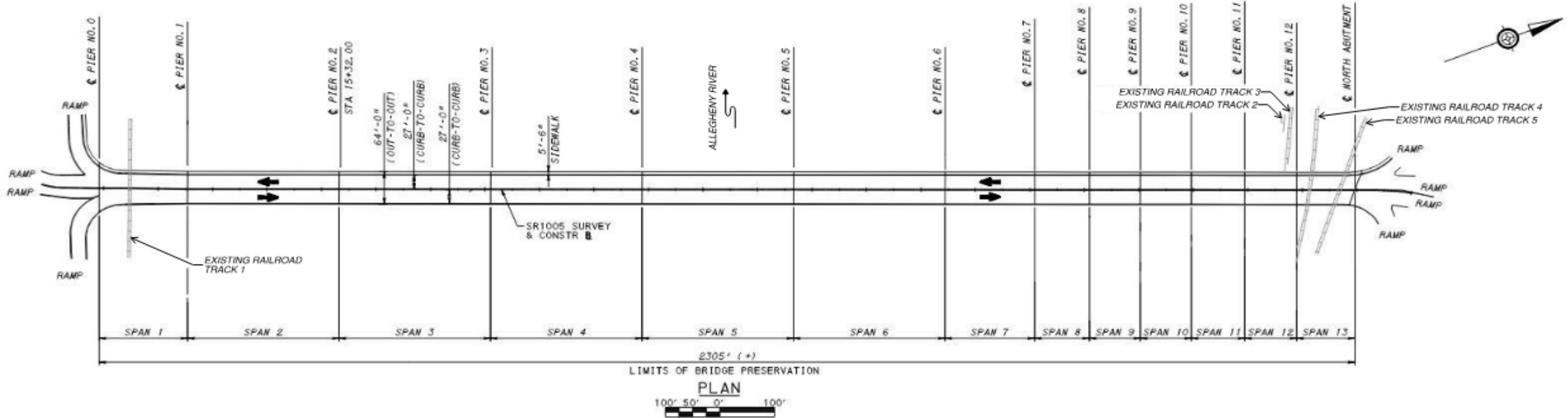

LEGEND

■ ◊ EXISTING RAILROAD TRACKS



PLAN – SOUTHERN RAMPS

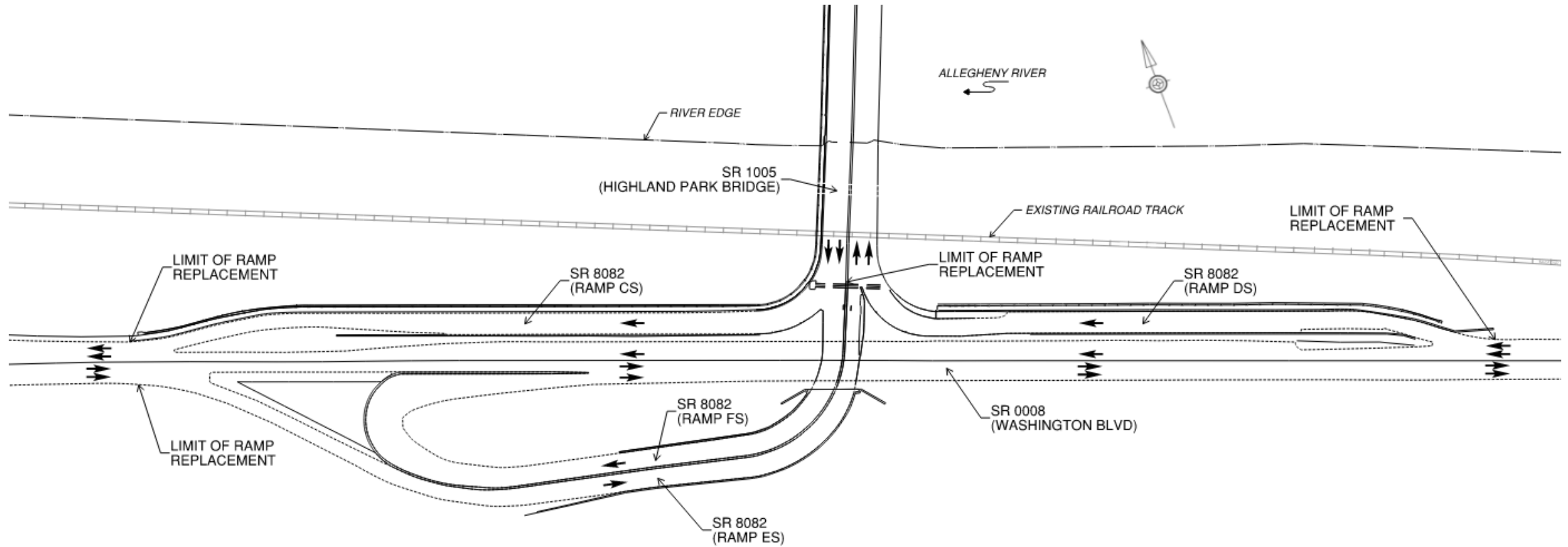

PROPOSED PROJECT IMPROVEMENTS

Bridge Preservation –

- Retrofitting/repairing various steel members.
- Full bridge painting
- Concrete barrier and deck repairs/overlay
- Expansion joint replacements
- Rocker bearing replacements
- Substructure repairs – both steel and concrete
- Bridge drainage repairs/upgrades
- Fencing upgrades



PROPOSED PROJECT IMPROVEMENTS

Southern Ramps Structure Improvements –

- Retrofitting/repairing various steel members
- Full steel member painting
- Substructure repairs – both steel and concrete
- **Full concrete deck and barrier replacement**
- Expansion joint replacements
- Rocker bearing replacements
- Bridge drainage repairs/upgrades



PROPOSED PROJECT IMPROVEMENTS

Southern Ramps Roadway Improvements –

- Barrier/Curb Replacements
- Full Depth Pavement Replacement
- Fencing Upgrades
- Drainage Improvements
- New Pavement Markings
- Turning Movement Improvements











PRELIMINARY RIGHT-OF-WAY IMPACTS

- **Required Right-of-Way** – 1 non-residential property necessary for minor widening of Southern Ramp ES (Route 8 EB to Highland Park Bridge NB)
- **Temporary Construction Easement** – 5 non-residential properties necessary for construction activities and contractor access to the bridge and ramps. Primarily required along Lock Way and 19th Street (Sharpsburg) and adjacent to the bridge at either end.
- **Required Aerial Easement** – 2 non-residential properties needed for repair access and then future bridge inspection and maintenance.

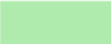

PROJECT OVERVIEW

LEGEND

-  PARCEL IDENTIFICATION
-  PARCEL IDENTIFICATION - NO TAKE
-  ALLEGHENY RIVER
-  HIGHLAND PARK BRIDGE PRESERVATION
-  BRIDGE DECK REPLACEMENT
-  ROADWAY RECONSTRUCTION
-  REQUIRED RIGHT-OF-WAY
-  REQUIRED AERIAL EASEMENT
-  SHARED USE / TEMPORARY CONSTRUCTION EASEMENT

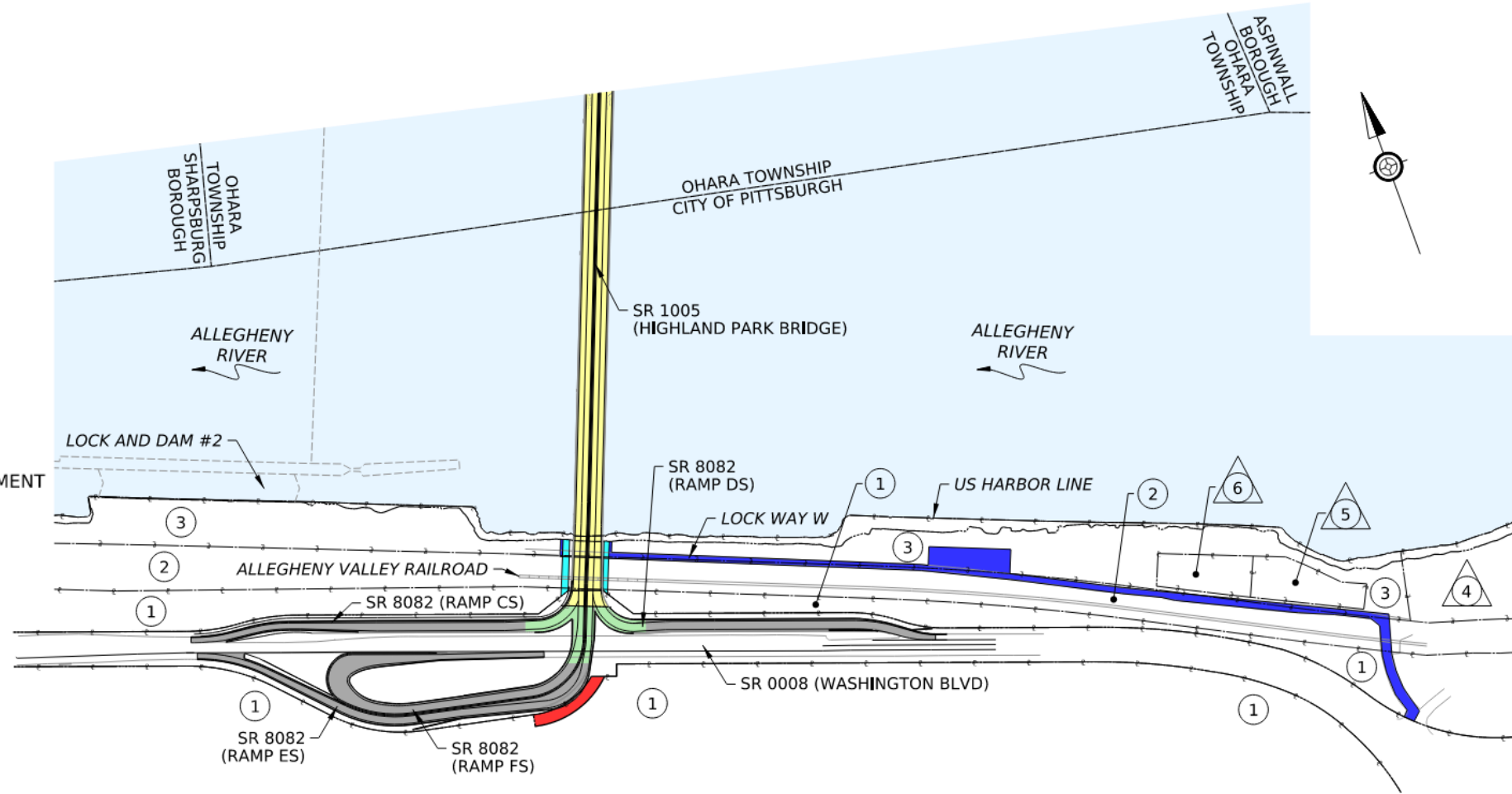







Unofficial/Preliminary
Not for Construction

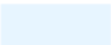

PROJECT OVERVIEW

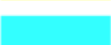
LEGEND

-  PARCEL IDENTIFICATION
-  PARCEL IDENTIFICATION - NO TAKE
-  ALLEGHENY RIVER
-  HIGHLAND PARK BRIDGE PRESERVATION
-  REQUIRED AERIAL EASEMENT
-  SHARED USE / TEMPORARY CONSTRUCTION EASEMENT
-  TEMPORARY CONSTRUCTION EASEMENT

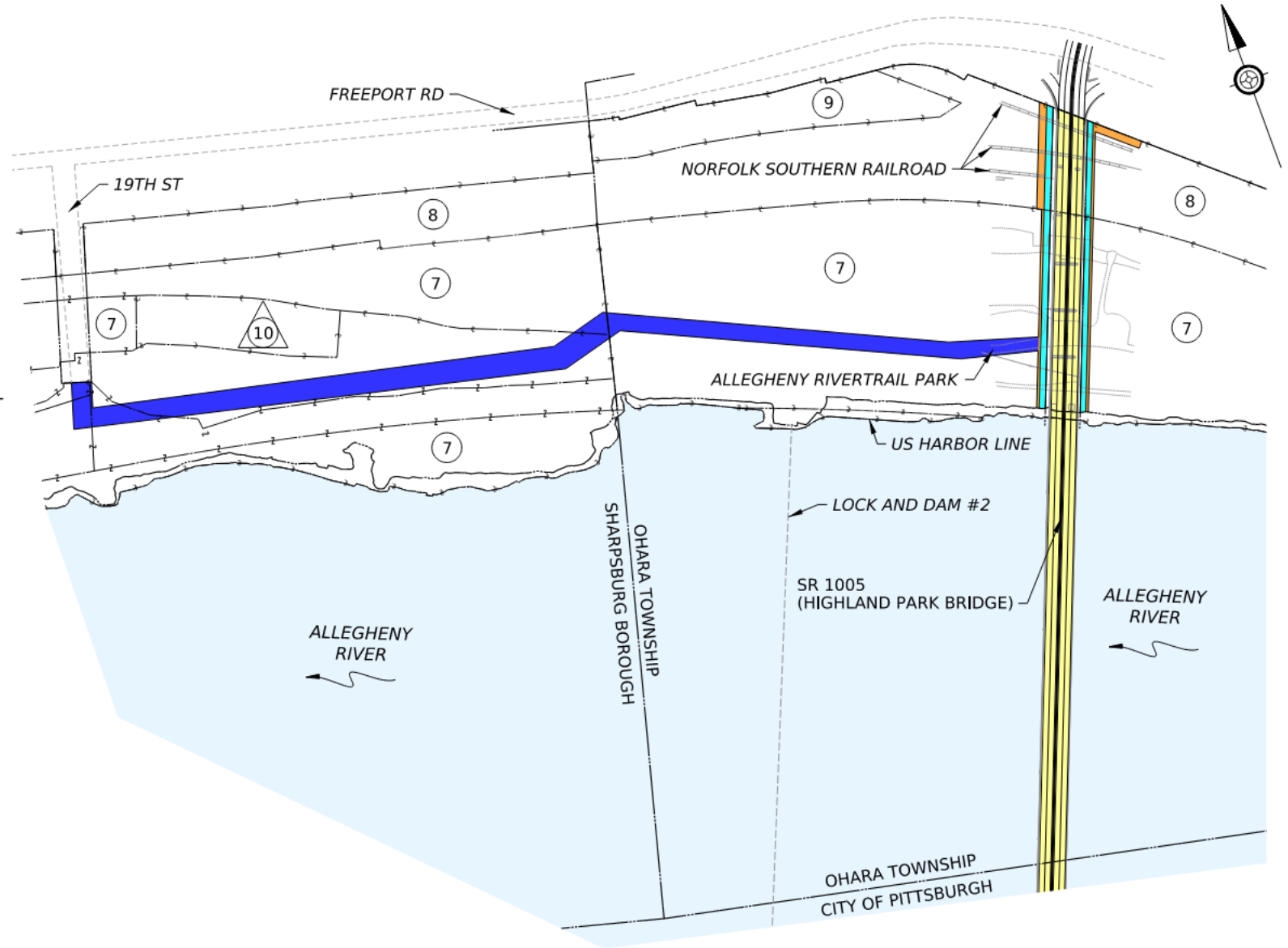

Unofficial/Preliminary
Not for Construction



ANTICIPATED TRAFFIC CONTROL

Maintenance and Protection of Traffic During Construction

- Bridge - Anticipated preservation work will require partial lane closures, lane closures with directional detours as well as some continuous daily closures (including weekends).
- Southern Ramps – Anticipated rehabilitation work will require full closures with detours of each ramp.



ANTICIPATED DETOUR PLAN



Anticipated Traffic Detour



SR 1005 Highland Park Bridge Work Zone



SR 1005 Highland Park Bridge Detour Route



Traffic Flow



POTENTIAL ALTERNATE DETOUR PLAN

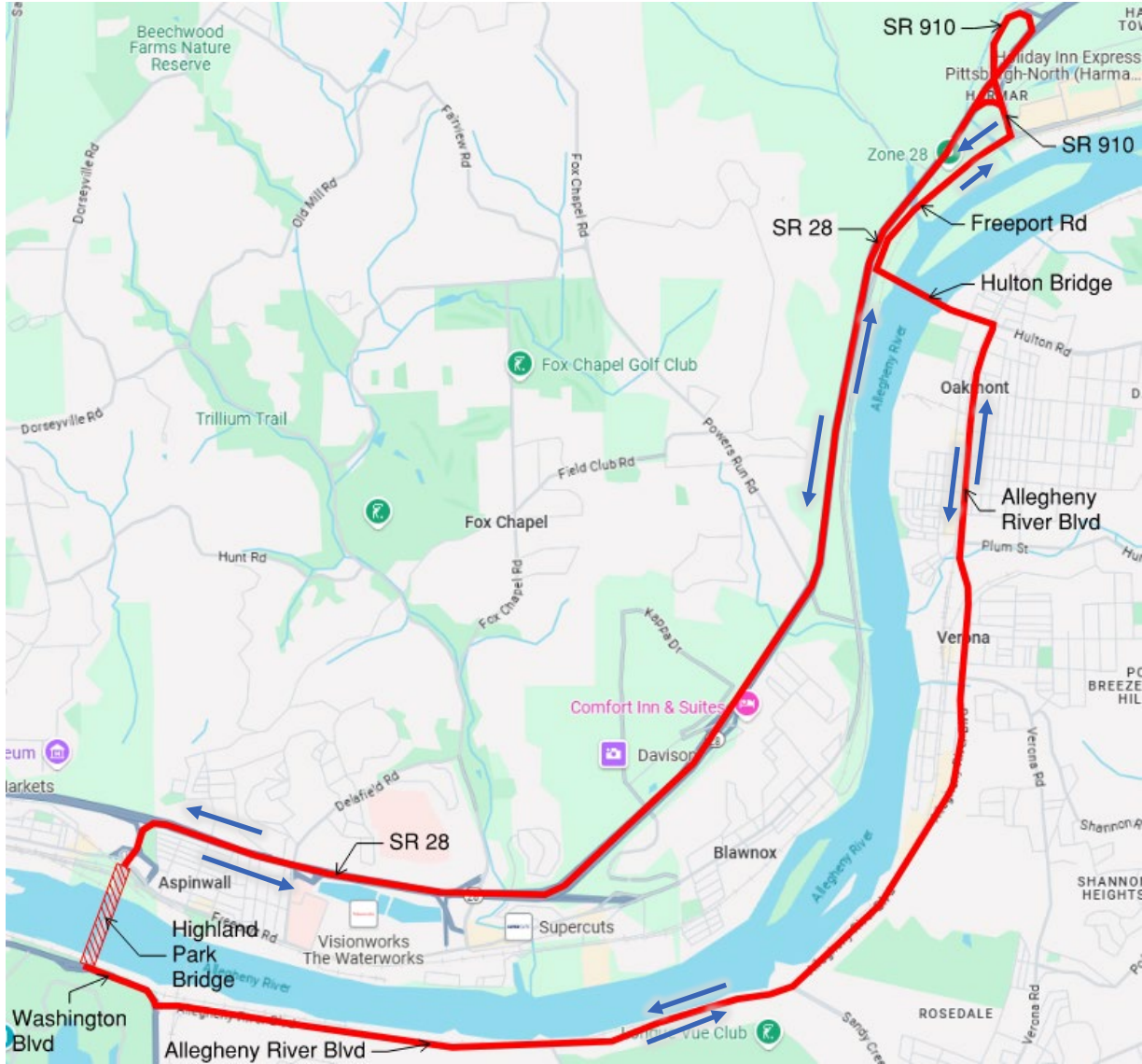

Potential Alternate Traffic Detour to the North – not continuous access to Route 28



SR 1005 Highland Park Bridge Work Zone



SR 1005 Highland Park Bridge Detour Route



Traffic Flow



ADDITIONAL TRAFFIC CONTROL

- Maintenance of pedestrian traffic during construction will be determined during final design of the project.
- Work over Span 1 (south end) will be coordinated with the Allegheny Valley Railroad.
- Likewise, work over Spans 12 & 13 will be coordinated with the Norfolk Southern Railroad.



RECREATIONAL RESOURCES - SECTION 4(F)



In Pennsylvania, there are both federal and state laws that govern the use of land from publicly owned parks, recreation areas, refuges, and historic sites for transportation projects.

This project area includes the following recreational resources:

- Highland Park Dam Overlook – Access will be maintained throughout construction.
- Allegheny River Water Trail – Barge use is anticipated during construction however their use will be limited to inside the exclusion buoy perimeter already in place to protect recreational boaters.
- Allegheny RiverTrail Park – Access will be maintained throughout construction.
- Highland Park

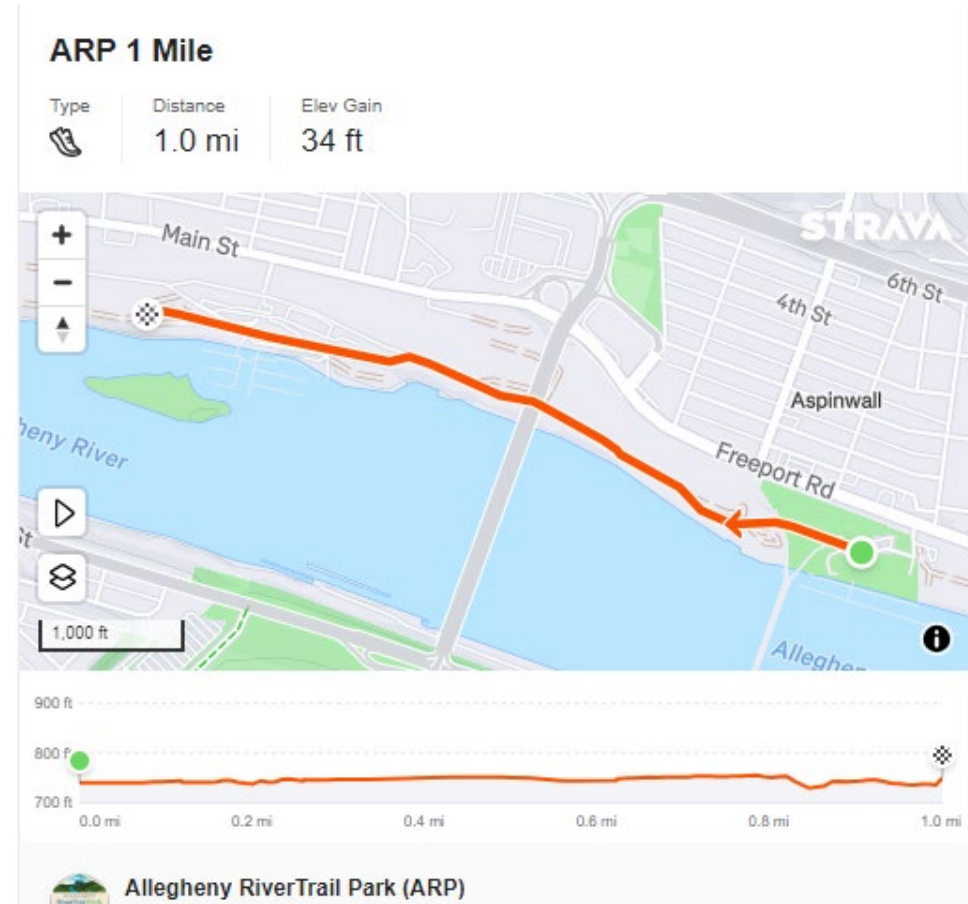

HISTORIC RESOURCES - SECTION 106

This project area includes the following historic resources:

- Highland Park Bridge
- Western Pennsylvania Railroad – Located on Sharpsburg/Aspinwall side
- Allegheny Valley Railroad – Located on the City of Pittsburgh side
- Allegheny River Lock and Dam #2
- Highland Park

Section 106 Resources are also protected by Section 4(f).



This project involves Section 106 resources that are either listed or eligible for listing in the National Register of Historic Places. This meeting provides an opportunity for the public to provide feedback on the historical significance of these resources.



HIGHLAND PARK

- Highland Park is both a Section 4(f) / Section 106 property owned by the City of Pittsburgh located within the proposed project area.
- Based upon the project design there will be a “use” of the Section 4(f) property through the permanent acquisition of right-of-way needed to construct the project (~4,000 square feet of property acquisition).
- This “use” of Highland Park is being considered *de minimis* as it does not appear to adversely affect the features, attributes or qualities that qualify Highland Park for protection under Section 4(f).
- Under Section 4(f), the public must be afforded an opportunity to review and comment on the effects of the project on the protected activities, features, and attributes of the property.
- If you have any comments or concerns related to project impacts to Highland Park, contact:
 - Mark Young, District Environmental Planning Manager – (412) 429-4858
 - Nick Krobot, Assistant Environmental Manager – (412) 429-5084

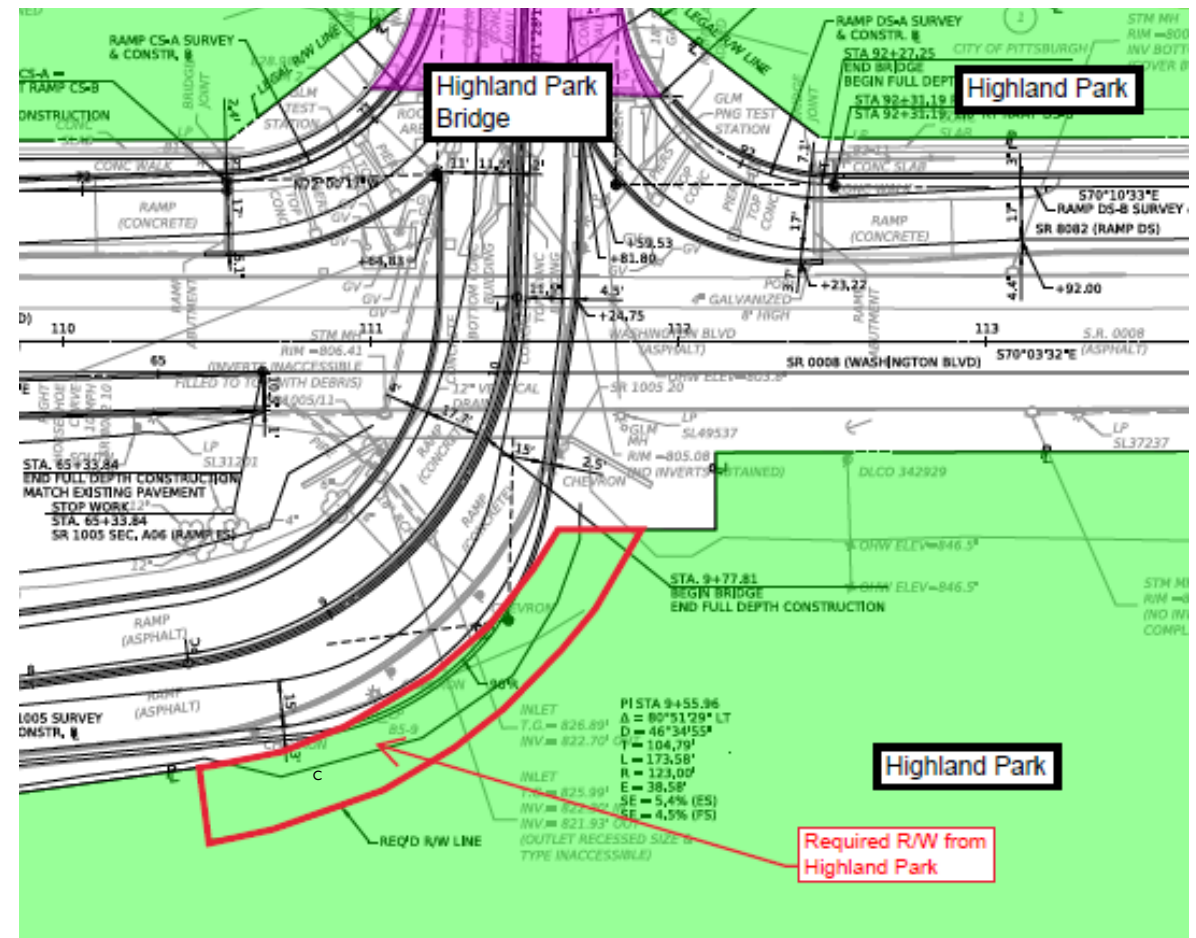

Unofficial/Preliminary
Not for Construction



NATIONAL ENVIRONMENTAL POLICY ACT (NEPA)

Public outreach begins with PennDOT Connects and extends into the **NEPA** (National Environmental Policy Act) process:

- PennDOT Connects is a project planning and development approach that engages local and planning partners by collaborating with stakeholders before project scopes are developed.
- NEPA requires agencies to integrate environmental values into their decision-making processes by considering the environmental impacts of their proposed actions and reasonable alternatives to those actions
- NEPA also includes public involvement activities and gathering feedback from the public
- This PowerPoint presentation is part of District 11-0's coordination with the public to obtain feedback on the project and to meet NEPA requirements.



PROJECT COMMENT FORM

PLEASE COMPLETE THE ON-LINE PROJECT COMMENT FORM

- The project comment form can be found on the project website link: <https://bit.ly/HighlandParkBridge>
- 1) Click the “**Submit a Comment**” tile under Contact Information on the right side of the screen.
- 2) Select “**Highland Park Bridge Preservation**” from the project (first) dropdown box

District 11 Public Involvement Comment Form

Feedback

Required fields are marked with an asterisk. (*)

Please select the project you would like to provide feedback for *

Highland Park Bridge Preservation

How did you hear about this public meeting? *

Select

1) Click Here

2) Click Here

ALLEGHENY COUNTY

Highland Park Bridge Preservation

Project Status

Step 1: Development | Step 2: Design | Step 3: Construction | Step 4: Completed

Project Overview

County: Allegheny
Municipality: City of Pittsburgh and O'Hara Township
State Route: 1005
Local Name: Highland Park Bridge
Project Type: Preservation
Proposed Construction Start: 2027
Proposed Construction End: TBD
Last Updated: 01/07/2025

The project involves bridge preservation of the Highland Park Bridge and approach spans over the Allegheny River, Norfolk Southern Railroad, and Allegheny Valley Railroad in the City of Pittsburgh and O'Hara Township, Allegheny County. The scope of work includes steel repairs, spall repairs, painting, drainage repairs, deck treatment, sign structure repairs, bearing replacements, and expansion dam/joint replacements, and other miscellaneous bridge preservation work. Also included in the project is reconstruction of the adjoining Route 8 Washington Boulevard Interchange, commonly referred to as the Southern Ramps. The Southern Ramps interchange work consists of four (4) ramp reconstructions, three (3) bridge deck replacements, barrier/curb replacements and repairs, drainage work, minor geometric and radius improvements, and other miscellaneous roadway work.

The project is tentatively slated to start construction in 2027.

Contact Information

Erik Porter, P.E.
Project Manager
412-429-4869
eporter@pa.gov

Mark Young
Environmental Planning Manager
412-429-4858
markyoung@pa.gov

Steve Cowan
Press Officer
412-334-5436
stcowan@pa.gov

Submit a Comment →



QUESTION & ANSWER SESSION

Thank You For Your Attendance and Attention!

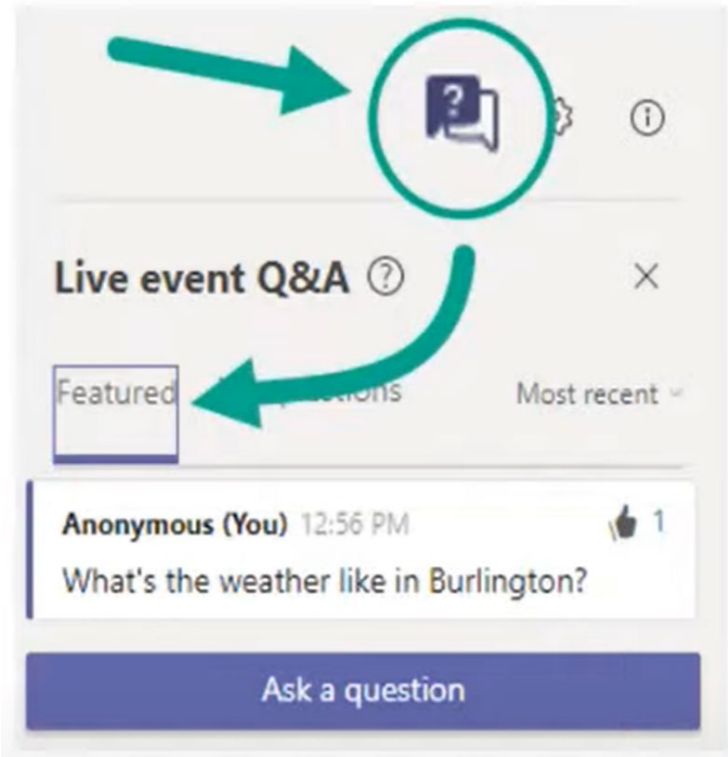

Questions/Comments/Feedback?

For Additional Information, please contact:

Erik M. Porter, PE
Senior Project Manager
(412) 429-4869
eporter@pa.gov

