

PROJECT DETAILS

THE SR 0119-20K PROJECT IS A SAFETY AND ROADWAY RECONSTRUCTION PROJECT THAT IS LOCATED IN BULLSKIN AND UPPER TYRONE TOWNSHIP IN FAYETTE COUNTY.

THE OVERALL PROJECT INCLUDES:

- RESURFACING/RECONSTRUCTION OF ROADWAYS
- EXTEND KENDI ROAD (TWP RD 791) SOUTH TO KINGVIEW ROAD (SR 1042)
- CONSTRUCTION OF TURN LANES
- CONSTRUCTION OF A ROUNDABOUT
- CONSTRUCTION OF A BRIDGE FOR TRAFFIC CROSSING INCLUDING CONSTRUCTION OF A NEW CONNECTOR ROAD (SR 1068) BETWEEN MT. PLEASANT ROAD (SR 1027) AND KENDI ROAD EXTENSION (TWP RD 791).
- REMOVAL OF TWO (2) AT GRADE INTERSECTIONS
- CONSTRUCTION OF ACCELERATION/DECELERATION LANES

THE PROJECT IS IN THE FINAL STAGES OF DESIGN.

MOST OF THE PROJECT SEQUENCING WILL UTILIZE SHORT DETOURS FOR ROADWAY TIE-IN WORK AND ROUNDABOUT CONSTRUCTION, AND SINGLE-LANE, EACH-DIRECTION PHASING OF ROUTE 119 TRAFFIC DURING RECONSTRUCTION.

CONTACTS

ANY CONCERNS OR QUESTIONS CAN BE DIRECTED TO THE FOLLOWING:

PERRY M. SCHWEISS, P.E.
 SPK PROJECT MANAGER
 126 KAIDER ROAD
 UNIONTOWN, PA 15401
 pschweiss@spkengr.com
 724-439-1600

JOSHUA ZAKOVITCH, P.E.
 PENNDOT PROJECT MANAGER
 825 N. GALLATIN AVENUE EXT.
 UNIONTOWN, PA 15401
 jzakovitch@pa.gov
 724-439-7377

LOCATION MAP

SCALE IN MILES

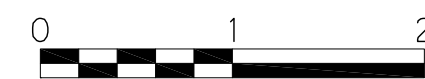

LEGEND

PROJECT	
STATE HIGHWAY	
TOWNSHIP ROAD	
TOWNSHIP LINE	
BOROUGH LINE	

**S.R. 0119, SECTION 20K
PROJECT SCHEDULE**

ENGINEERING DESIGN

**COMPLETE
WINTER
2024**

BID DATE

SPRING 2025

BEGIN CONSTRUCTION

**ESTIMATED
SUMMER 2025**

CONSTRUCTION COMPLETE

**ESTIMATED
FALL 2027**



LEGEND

- PROPOSED PAVEMENT
- PROPOSED SHOULDER
- PROPOSED DRIVE ADJUSTMENT
- PROPOSED CONCRETE GLARE SCREEN
- PROPOSED CONCRETE CURB/ISLAND/STRUCTURE
- PROPOSED CENTRAL/SPLITTER ISLAND
- MILL & OVERLAY

File Name: \\Bosch\proj\2025\012025\SR0119\20K\McClure\ProjPublic\Meeting\2025\0119_20K_Cor_Plan_Aerial.dwg, No. 13, 2025.01.09, mrcos

SR 0119/20K ROUNDBABOUT DISPLAY

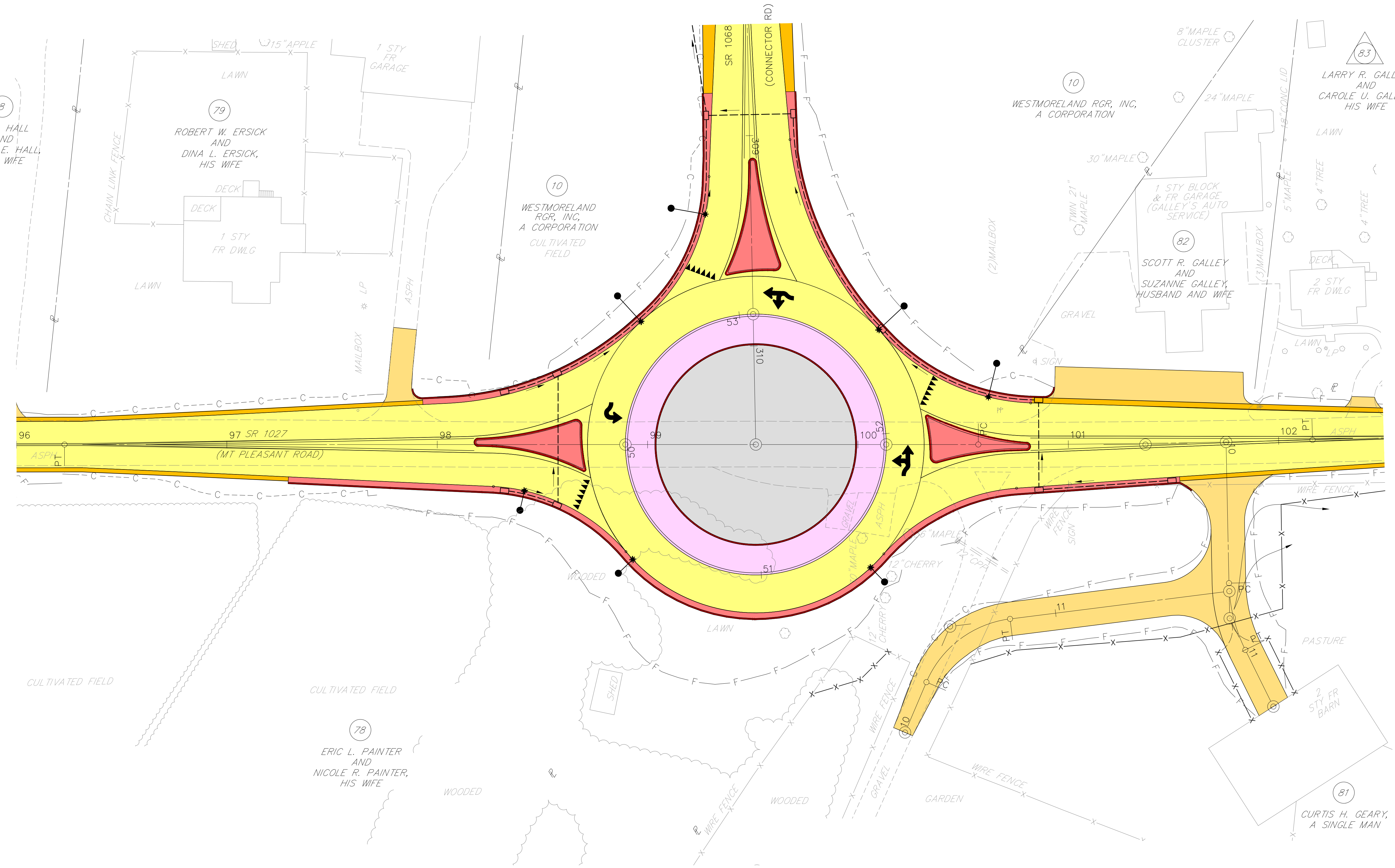
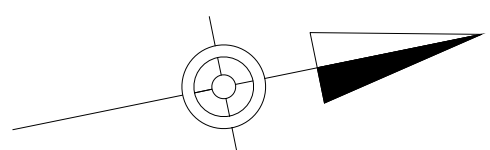

- PROPOSED PAVEMENT
- PROPOSED SHOULDER
- PROPOSED DRIVE ADJUSTMENT
- PROPOSED CONCRETE CURB/ISLAND
- PROPOSED TRUCK APRON
- PROPOSED ROUNDBABOUT CENTER

LEGEND

- PARCEL IDENTIFICATION NUMBER
- PARCEL IDENTIFICATION NUMBER-NO TAKE
- CUT SLOPE
- FILL SLOPE
- HIGHWAY LIGHTING

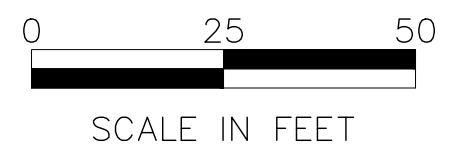

File name: \\Roadway\DIST-12\SR0119\20K (McClure Rd)\Public Meeting_20241019-20K Con Plot Display.dwg, Nov 19, 2024-11:44am, jlabak

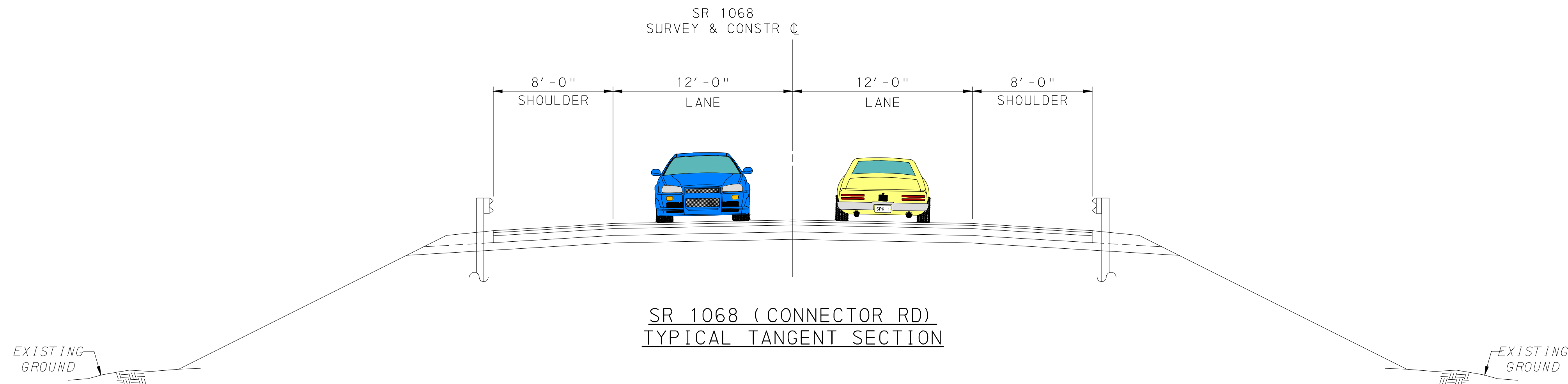
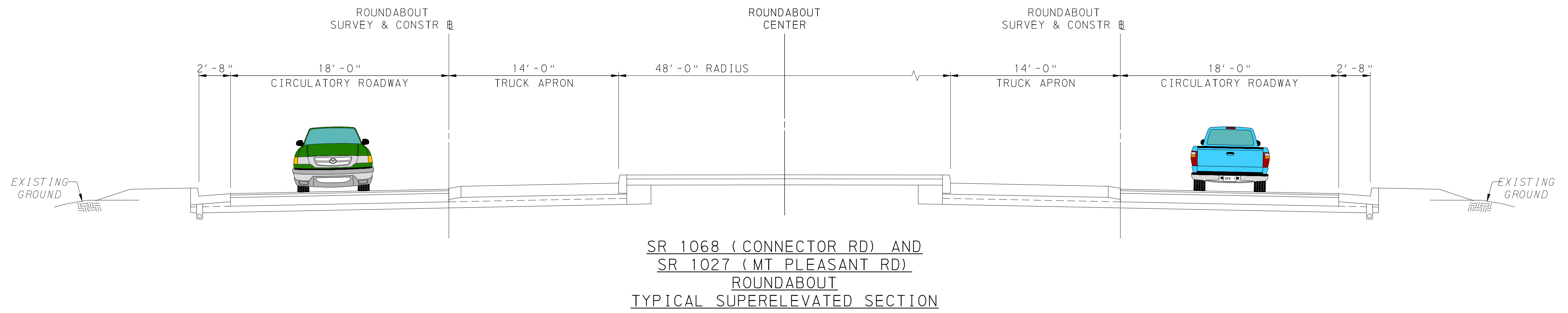
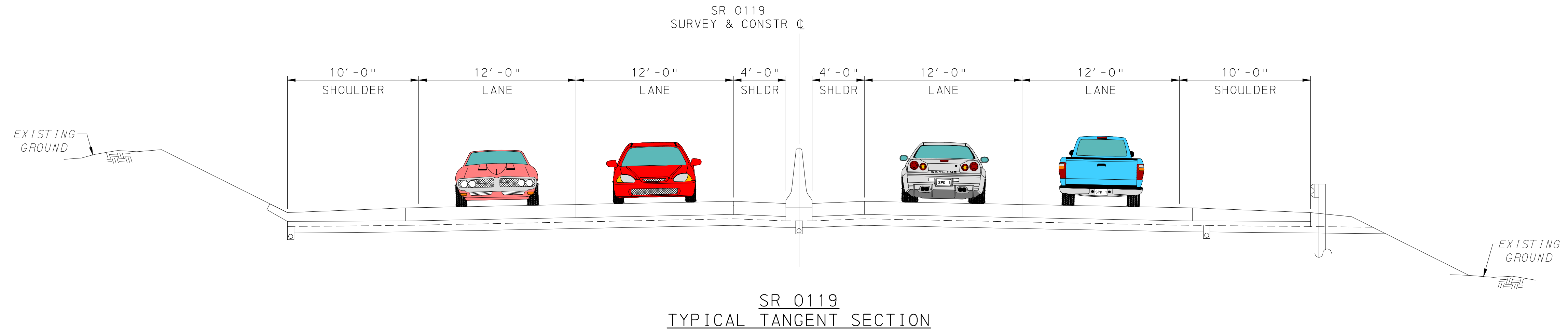

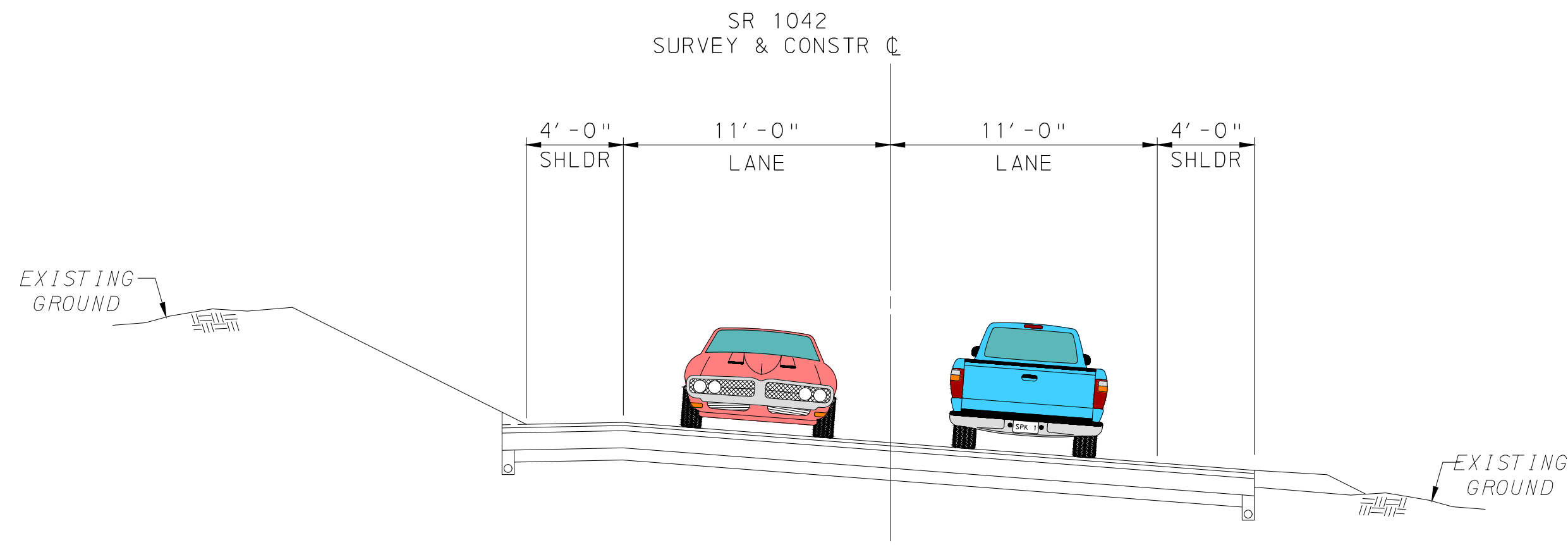

SR 1042 (KINGVIEW RD)
TYPICAL TANGENT SECTION

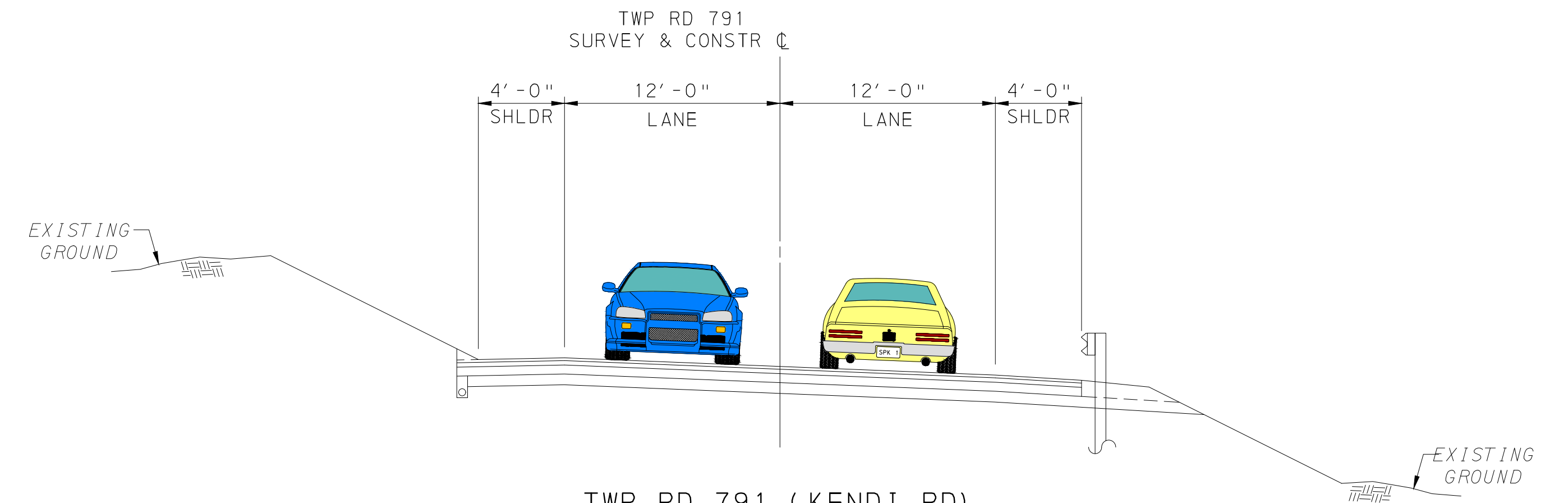

TWP RD 791 (KENDI RD)
TYPICAL SUPERELEVATED SECTION

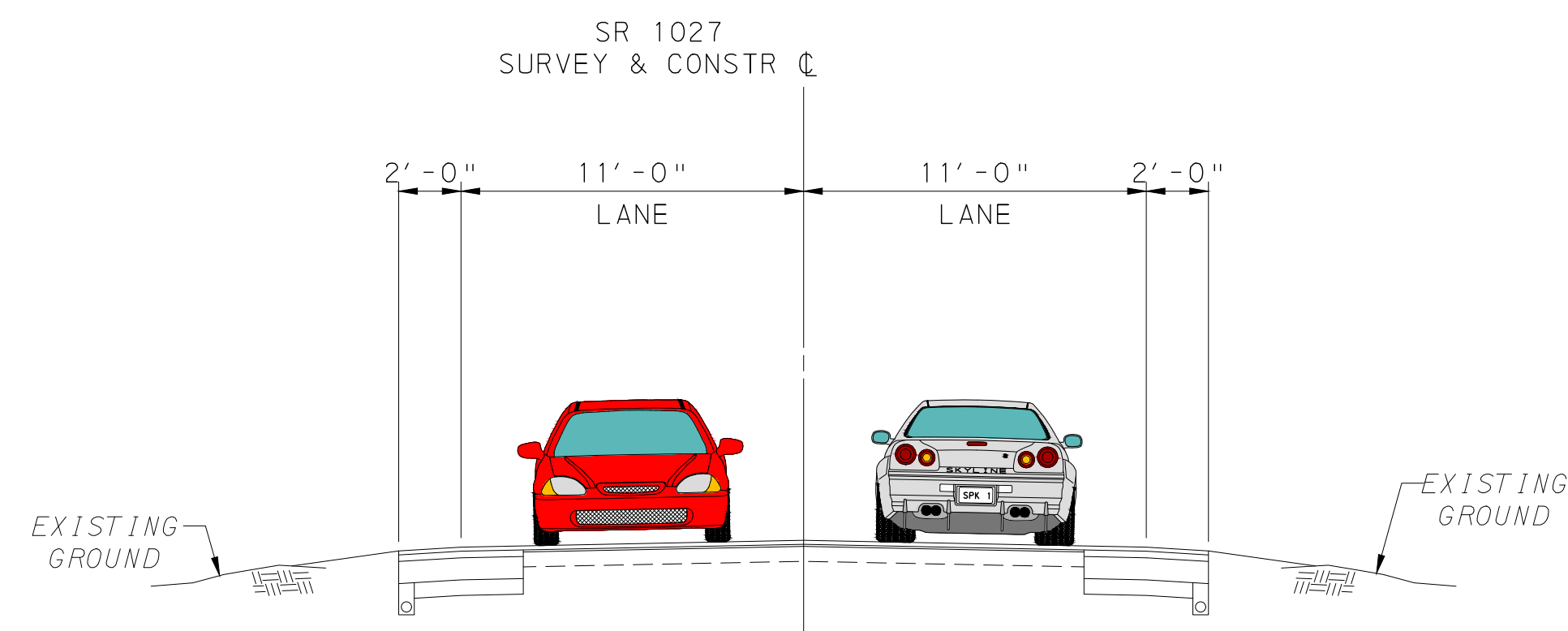

SR 1027 (MT PLEASANT RD)
TYPICAL TANGENT SECTION

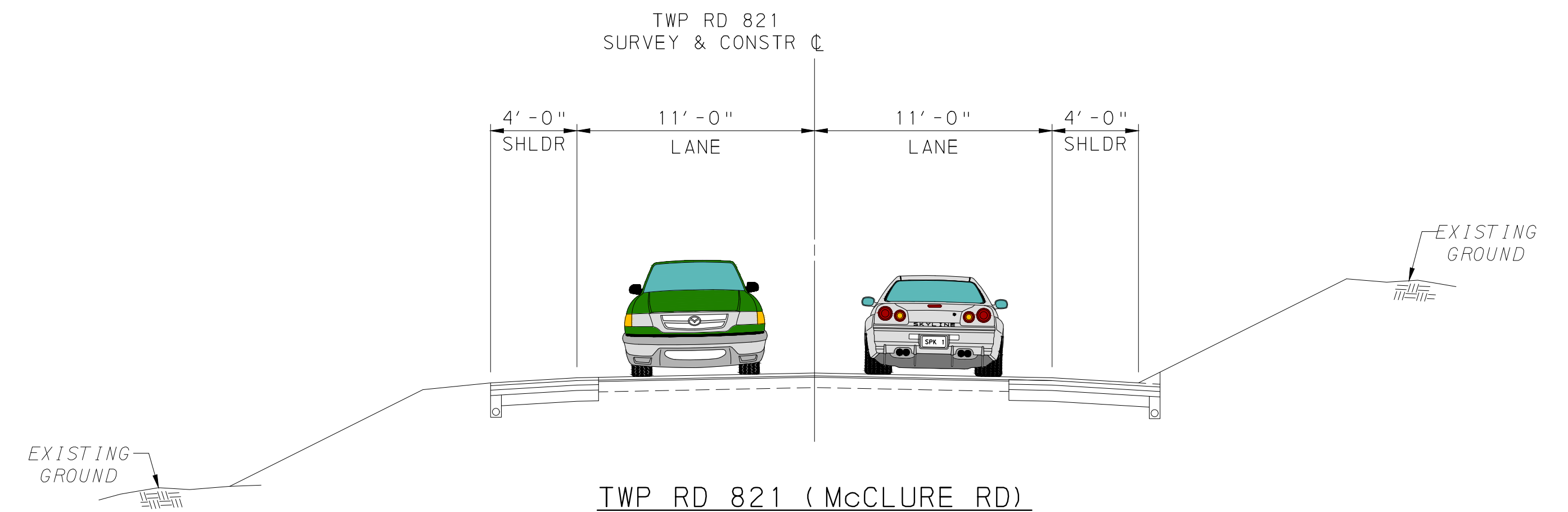

TWP RD 821 (McCLURE RD)
TYPICAL TANGENT SECTION

STRUCTURE INFORMATION CONNECTOR ROAD OVER SR 0119

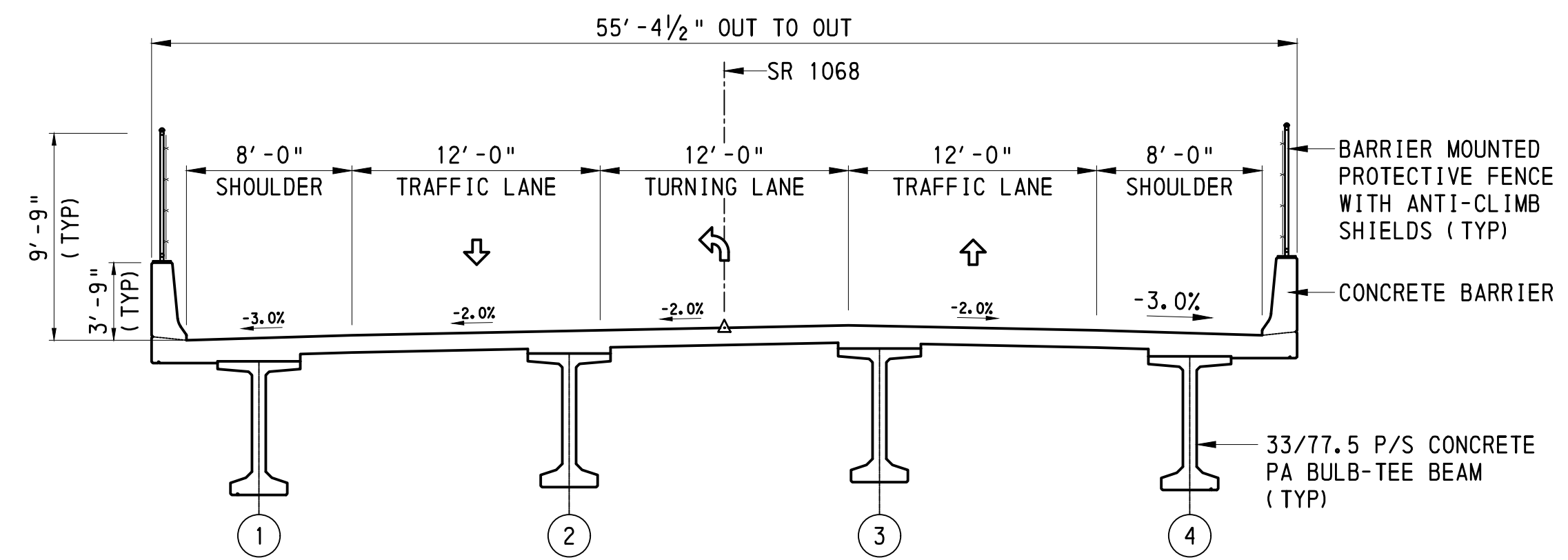

BRIDGE TYPICAL SECTION

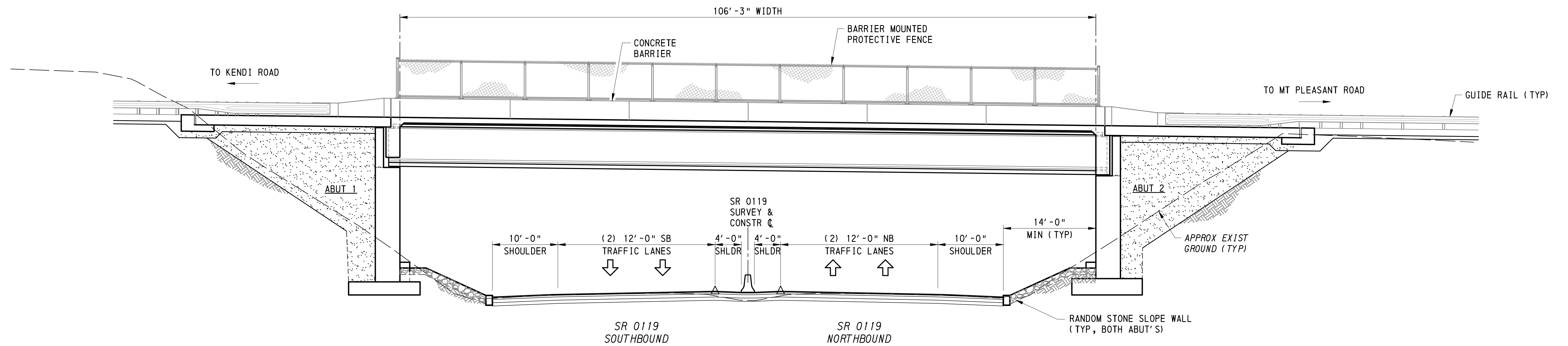

NEW CONNECTOR ROAD BRIDGE OVER SR 0119

File name: I:\Roadway\DIST-12\SR0119\20K (McClure Rd)\Public Meeting 202402 Elevation-Index.dwg Nov 19, 2024-11:51am

STRUCTURE INFORMATION CONNECTOR ROAD OVER SR 0119

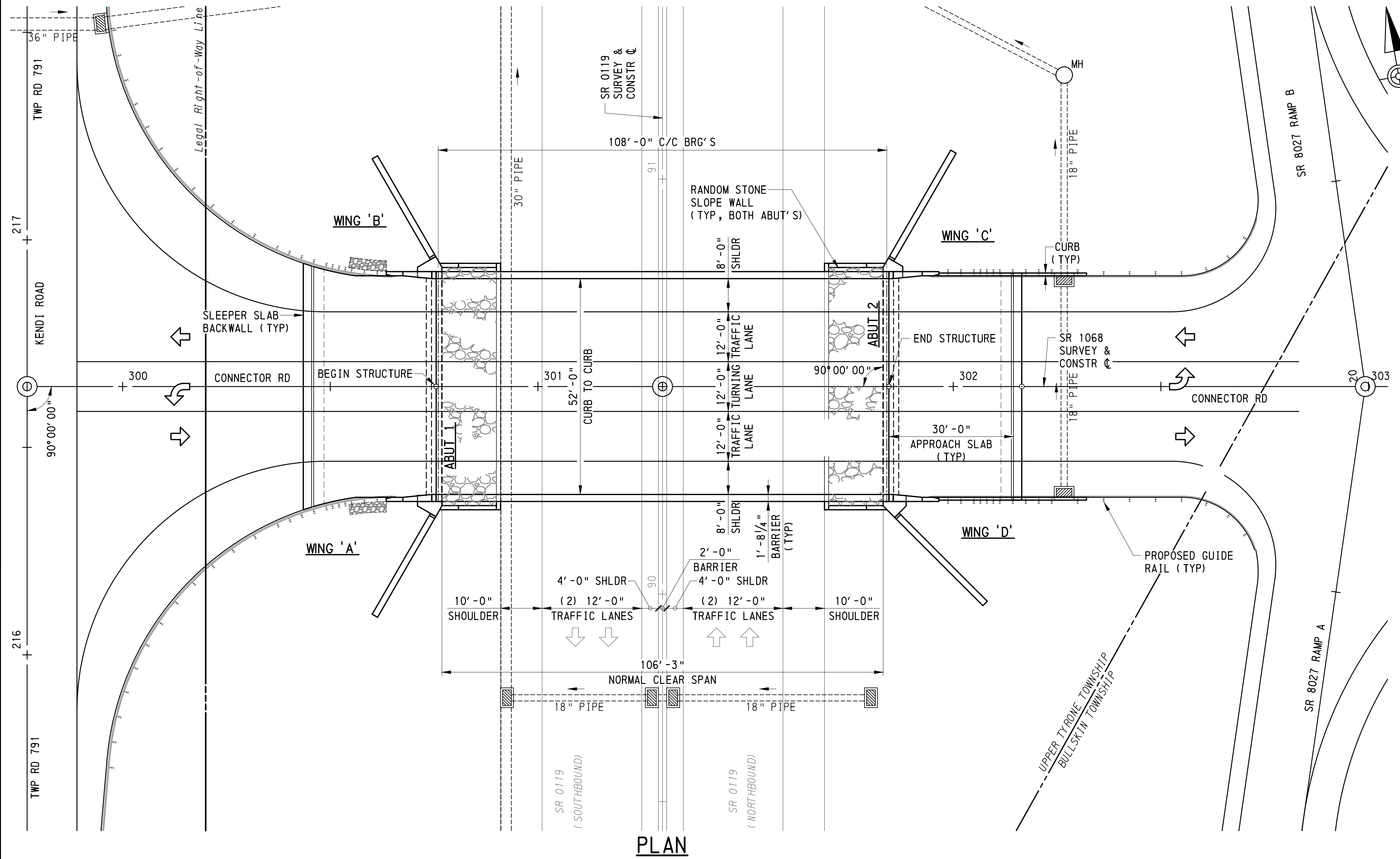

PLAN

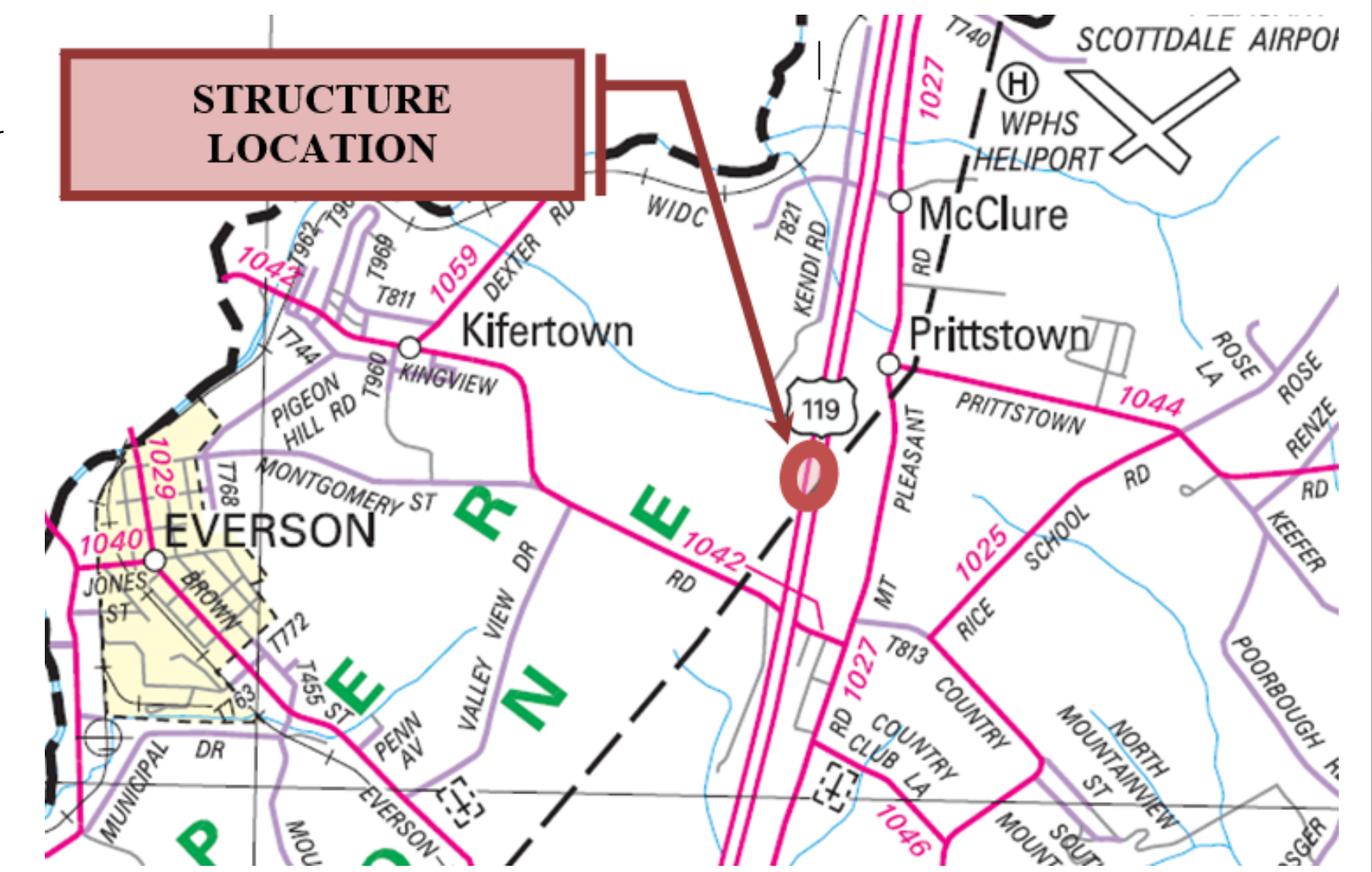

File name: I:\Roadway\DIST-12\SR0119\20K (McClure Rd)\Public Meeting 2024\01 Gen Plan.dwg, Nov 19, 2024-11:50am

DES: JRC DWG: KSS CKD: PMS



SR 0119 SECTION 20K MCCLURE/KINGVIEW ROAD INTERCHANGE PROJECT PLANNED CONSTRUCTION SEQUENCE



PHASE 1 - 2025

- CONSTRUCT KENDI ROAD EXTENSION
- CONSTRUCT CONNECTOR ROAD
- CONSTRUCT ROUNDABOUT
- RECONSTRUCT KINGVIEW ROAD
- RECONSTRUCT CROSSROADS ROAD
- RECONSTRUCT MCCLURE ROAD
- CONSTRUCT OVERHEAD BRIDGE
- CONSTRUCT RAMPS A & B

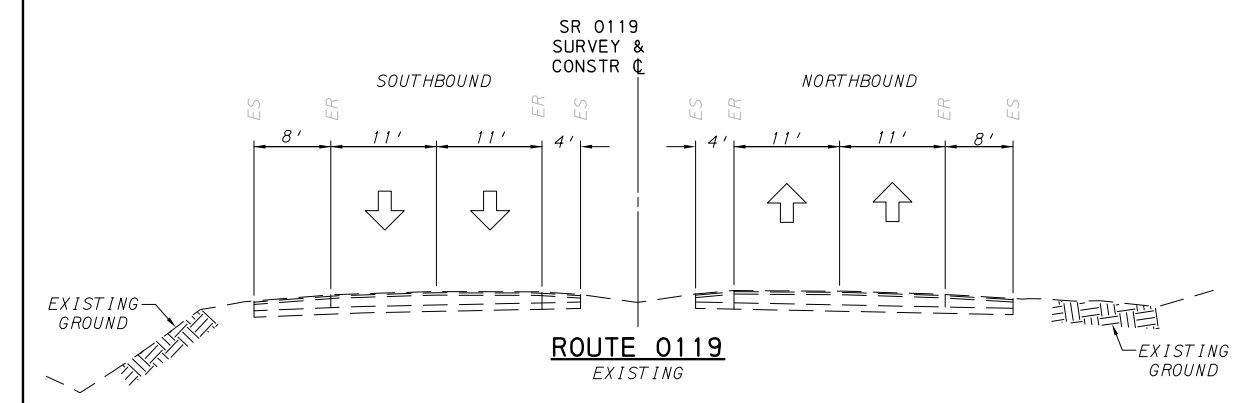

PHASE 2 - 2025

- CONSTRUCT ROUTE 119 TEMPORARY MEDIAN WIDENING

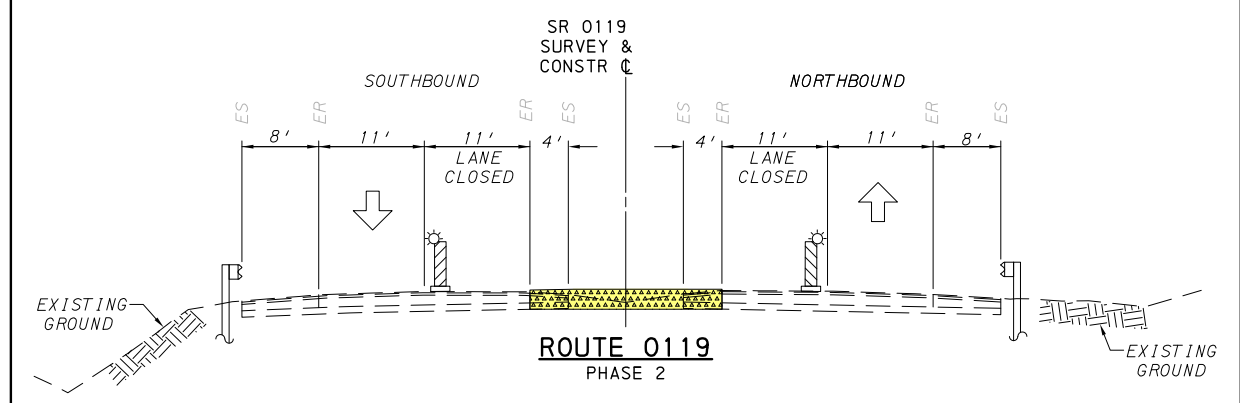

- LEGEND**
- VERTICAL PANEL CHANNELIZING DEVICE WITH TYPE C LIGHT
 - TRAFFIC DIRECTION
 - EXISTING GUIDE RAIL
 - TEMPORARY WIDENING

PHASE 3 - 2026

- CONSTRUCT ROUTE 119 NORTHBOUND RIGHT LANE AND SHOULDER PERMANENT PAVEMENT

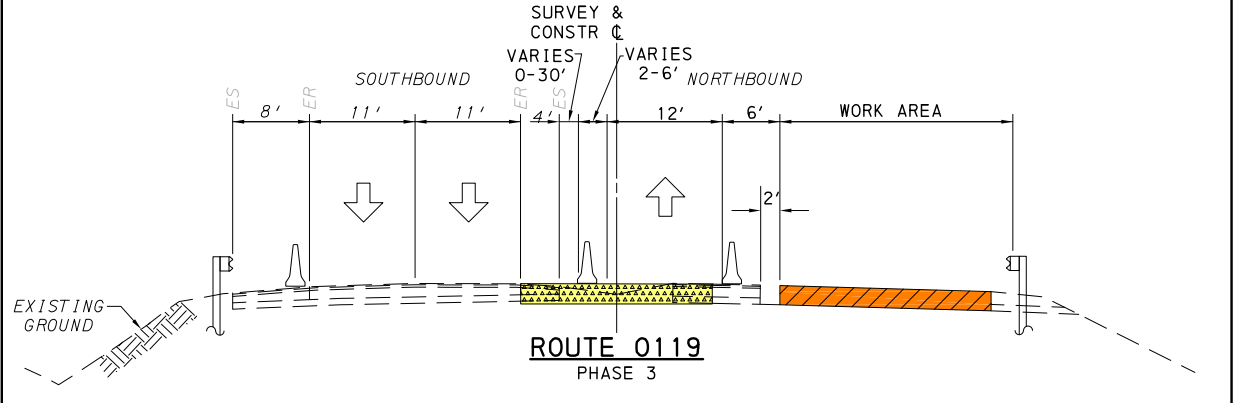

- LEGEND**
- TEMPORARY RECONSTRUCTION/WIDENING (PHASE 2)
 - WORK AREA (PHASE 3)
 - VERTICAL PANEL CHANNELIZING DEVICE WITH TYPE C LIGHT
 - TRAFFIC DIRECTION
 - EXISTING GUIDE RAIL
 - TEMPORARY BARRIER

PHASE 4 - 2026

- CONSTRUCT ROUTE 119 SOUTHBOUND RIGHT LANE AND SHOULDER PERMANENT PAVEMENT

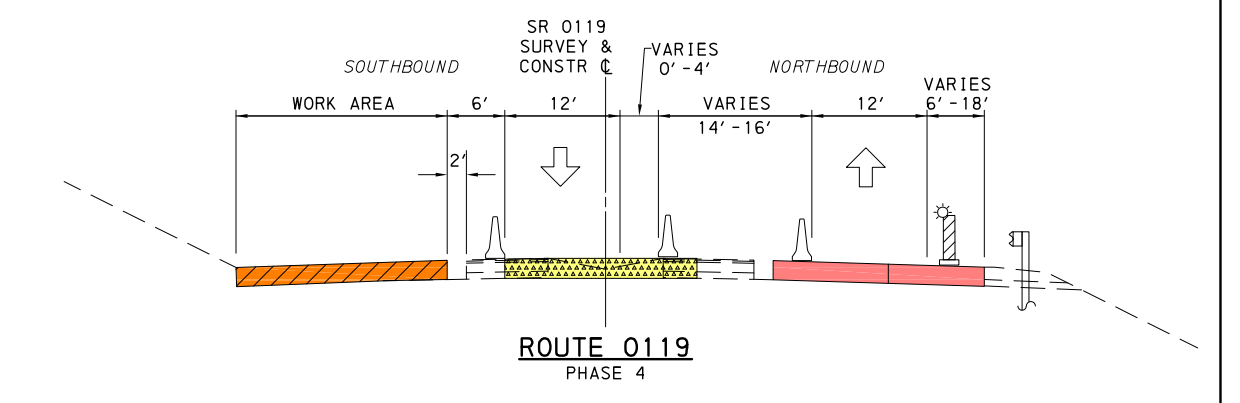

- LEGEND**
- TEMPORARY RECONSTRUCTION/WIDENING (PHASE 2)
 - PERMANENT PAVEMENT (PHASE 3)
 - WORK AREA (PHASE 4)
 - VERTICAL PANEL CHANNELIZING DEVICE WITH TYPE C LIGHT
 - TRAFFIC DIRECTION
 - PROPOSED PERMANENT GUIDE RAIL
 - TEMPORARY BARRIER

PHASE 5 - 2027

- CONSTRUCT ROUTE 119 NORTHBOUND, SOUTHBOUND AND MEDIAN PERMANENT PAVEMENT AND BARRIER

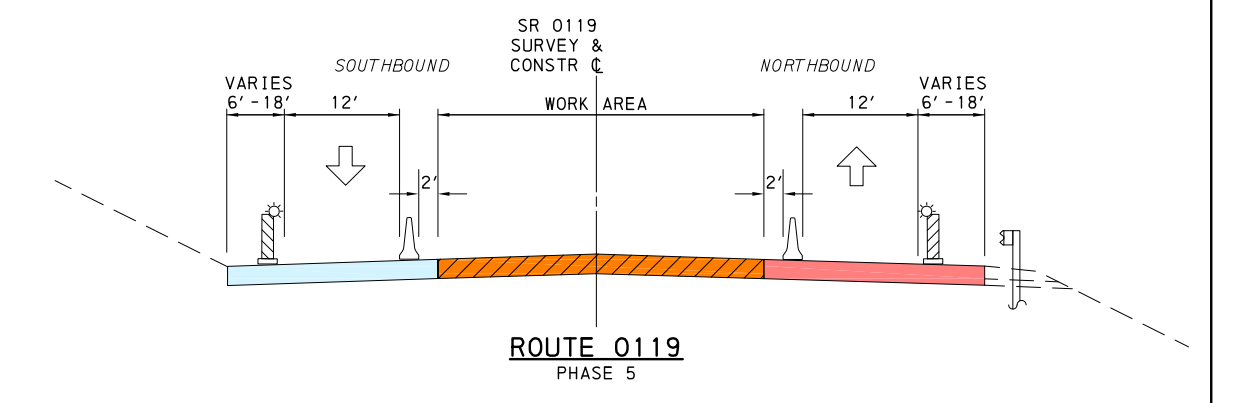

- LEGEND**
- PERMANENT PAVEMENT (PHASE 3)
 - PERMANENT PAVEMENT (PHASE 4)
 - WORK AREA (PHASE 5)
 - VERTICAL PANEL CHANNELIZING DEVICE WITH TYPE C LIGHT
 - TRAFFIC DIRECTION
 - PROPOSED PERMANENT GUIDE RAIL
 - TEMPORARY BARRIER