

PLOT DRIVER: pcedot201.plt
 PEN TABLE: ..\Pen_Table.ctb
 WORKSPACE: 028001-02.rvt

OPERATOR: danielle.deroif
 FILE PATH: I:\2018\080505_02\22322_02\1113.dgn
 PLOT DATE: 10/17/2022

PROPOSED CROSS SECTION

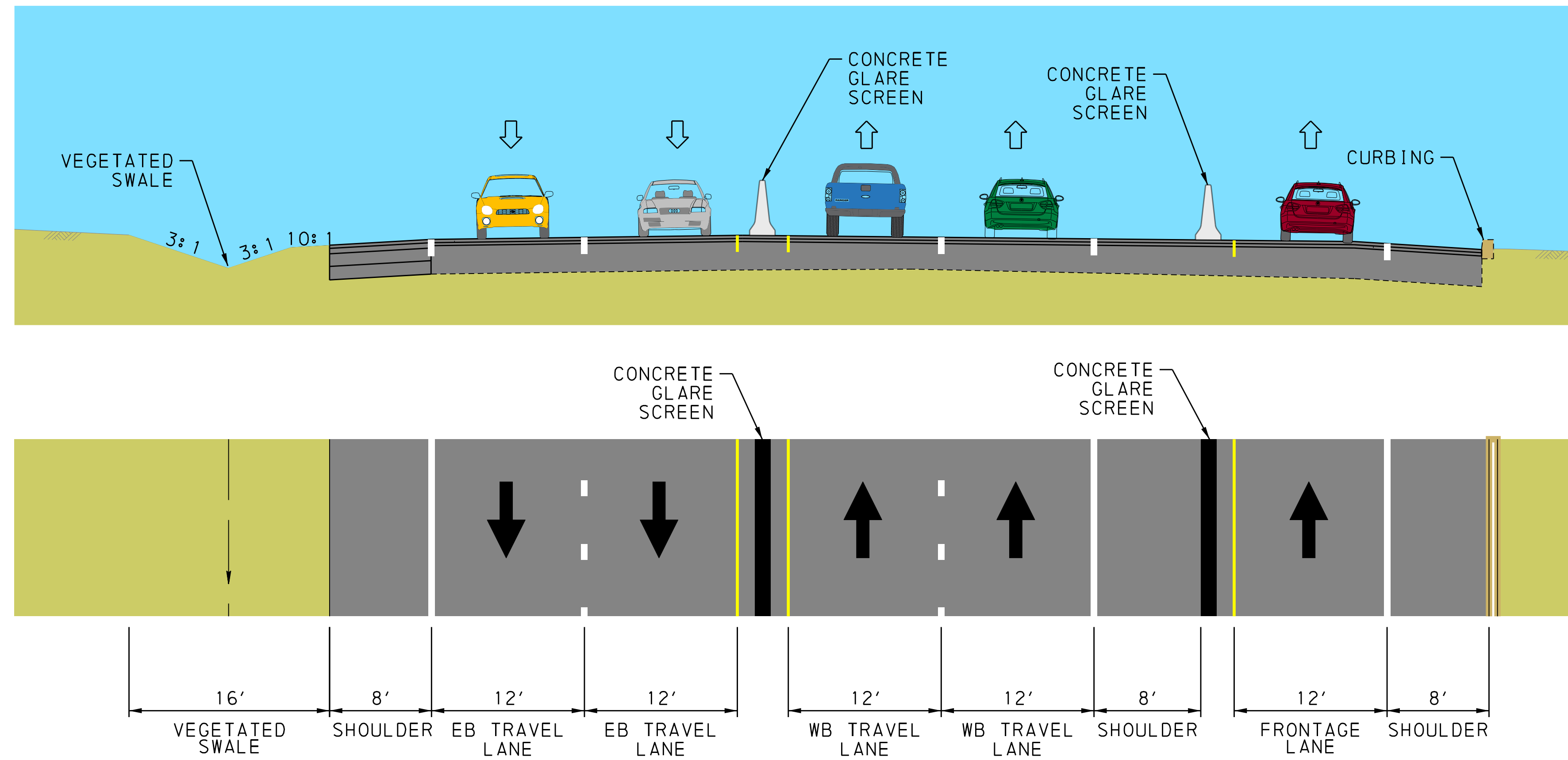

EXISTING CROSS SECTION

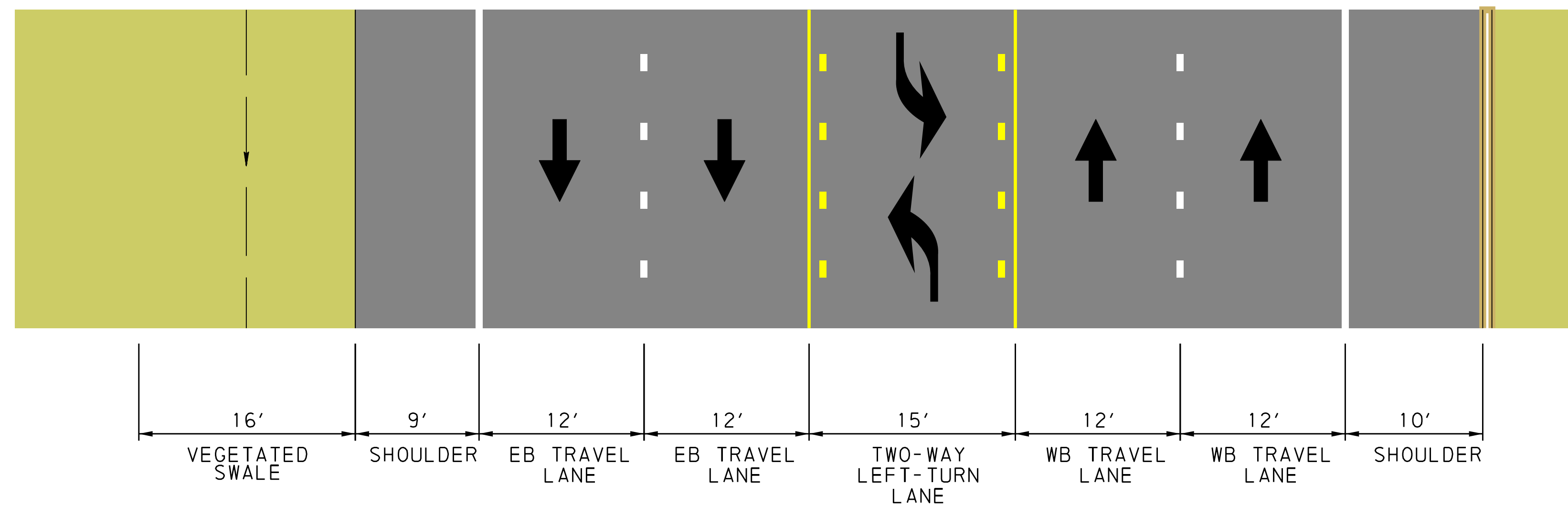

ROUTE 22/322 CLARK'S FERRY IMPROVEMENT PROJECT

Dauphin and Perry Counties

EXISTING AND PROPOSED CROSS SECTIONS

