

PENNSYLVANIA GAME COMMISSION
2001 ELMERTON AVENUE
HARRISBURG, PA 17110-9797
ATTN: FORESTRY DIVISION, BUREAU OF WILDLIFE HABITAT MANAGEMENT

Gentlemen:

In answer to a recent advertisement for lump sum bids on an estimated 1,120,951 board feet of sawlogs and 7,644 tons of pulpwood located on 377 acres of State Game Lands No. 211, Rush Township, Dauphin County, I offer the following:

\$ _____
(BID QUOTATION MUST BE TYPEWRITTEN OR IN INK)

Full payment will be made when agreements are signed or payment in full for each individual cutting block before cutting operations are started on that block.

It is further understood that an acceptable bond of **\$10,000.00** will be provided to guarantee faithful performance of the agreement.

Removal of timber to be subject to the terms, conditions and stipulations included in the Timber Sale Agreement. It is understood that the contract will run until **May 30, 2027**.

ATTACHED IS **CERTIFIED, CASHIER'S OR TREASURER'S CHECK OR MONEY ORDER, (PERSONAL, COMPANY, CORPORATE CHECK OR CASH ARE NOT ACCEPTED)**, IN THE AMOUNT OF **\$1,000.00** as evidence of good faith in bidding. I understand that it will be forfeited as fully liquidated damages upon my failure within 45 days after presentation to accept and execute the contract and provide a bond as required.

IN CASE OF PARTNERSHIP, EACH PARTNER SIGNS: IF A CORPORATION, THE AUTHORIZED OFFICER MUST SIGN, GIVING HIS/HER TITLE AND NAME OF CORPORATION.

Sincerely yours,

(Tax No. or Social Security No.)

Signature of Bidder - Sign In Ink

(Telephone Number)

Print Name

Firm Name

Street Address (Name, Number, Etc.)

City State Zip

BIDS MUST BE SUBMITTED IN AN ENVELOPE THAT CLEARLY STATES ON THE OUTSIDE: **BID PROPOSAL FOR TIMBER SGL #211**. Bids will be opened in the Bureau of Wildlife Habitat Management, 2001 Elmerton Avenue, Harrisburg, PA 17110-9797, at **2:00 P.M., Monday, August 12, 2024**. The Commission reserves the right to reject any and all bids and to award the contract as deemed to its best interests.

STATE GAME LANDS #: 211
SALE #: 211-2023-01
NAME: Too Long

- INSTRUCTIONS TO BIDDERS -

The following information covers details concerning the proposed lump sum sale of an estimated 1,120,951 board feet of sawlogs and 7,644 tons of pulpwood to be cut from 377 acres of State Game Lands No. 211, Rush Township, Dauphin County.

See attached sheets for additional volume information. The volume and percentages are not guaranteed and each prospective bidder is urged to examine the sale area and bid on the basis of his own estimate.

- SHOW DATE -

Timber will be shown to prospective bidders on **July 23, 2024**. Viewers will be met at the gate along Rt. 325 (40.548162, -76.577929) at 9:00 a.m., and conducted to the sale area.

The timber to be sold will be clearly designated by Jonathan Weaver, 253 Snyder Road, Reading, PA 19605, telephone: 1-610-926-3136, the Regional Forester.

- BIDS -

BIDS SHOULD BE MAILED EARLY ENOUGH TO PERMIT U.S. POSTAL SERVICE DELIVERY. USE SPECIAL MAIL SERVICE IF MAILED LATER THAN FOUR DAYS PRIOR TO BID OPENING. SPECIAL DELIVERY BIDS SHOULD BE ADDRESSED TO: PENNSYLVANIA GAME COMMISSION, FORESTRY DIVISION, 2001 ELMERTON AVENUE, HARRISBURG, PA 17110-9797.

Bids must be submitted in an envelope that clearly states on the outside: **BID PROPOSAL FOR TIMBER. SGL #211**. Bids received in envelopes not containing this information will be rejected.

In order to be considered, the bid shall be accompanied by a **CERTIFIED, CASHIER'S OR TREASURER'S CHECK, OR A BANK, POSTAL OR EXPRESS MONEY ORDER**, payable to the Pennsylvania Game Commission in the amount of **\$1,000.00**, as evidence of good faith in bidding, to be forfeited as fully liquidated damages upon the bidders failure to accept the award, execute the contract and give bond as required. Bid deposits will be returned to the successful bidder when the contract has been executed and a satisfactory performance deposit has been furnished.

In lieu of bid deposit, bidders may submit an open bid bond to cover the deposit requirement. Any bid bond must be filed for an annual period and both the amount of bond and the surety shall receive prior approval of the Pennsylvania Game Commission.

The Commission reserves the right to reject any and all bids and to award the contract as deemed to its best interests.

Bids will be opened in the Bureau of Wildlife Habitat Management, 2001 Elmerton Avenue, Harrisburg, Pennsylvania 17110-9797, at 2:00 P.M., **Monday, August 12, 2024**, telephone: 717/787-2039. **BIDS RECEIVED LATER THAN 2:00 P.M., THIS DATE, WILL BE REJECTED.**

- PERFORMANCE DEPOSIT -

A performance bond in the amount of **\$10,000.00** will be required in the form of a Certified Check or a Postal Money Order drawn to the order of the Pennsylvania Game Commission. Negotiable securities, including assignment of a bank savings account may be furnished in lieu of above. A bond with corporate surety approved by the Attorney General, or a bank Irrevocable Letter of Credit, may be posted provided the bond has an expiration date a minimum of 1 year beyond the expiration date of the timber contract.

- EXPIRATION OF CONTRACT -

Contract will expire **May 30, 2027.**

- PAYMENTS -

The sale is divided into 11 cutting blocks. Payment may be made by:

1. Total payment when agreement is signed.
or
2. Payment by individual block or blocks.

- 1 – 11% - 30 acres
- 2 – 1% - 27 acres
- 3 – 8% - 19 acres
- 4 – 0% - 14 acres
- 5 – 27% - 58 acres
- 6 – 11% - 40 acres
- 7 – 4% - 34 acres
- 8 – 19% - 45 acres
- 9 – 9% - 56 acres
- 10 – 9% - 33 acres
- 11 – 0% - 21 acres

- ANTI DISCRIMINATION -

The contractor awarded the Timber Sale Agreement agrees he will not discriminate against any employee or other persons on account of race, sex, creed, age, ancestry or national origin.

- SAFETY and ENVIRONMENTAL PROTECTION –

The Buyer, his employees and sub-contractors are expected to perform all logging operations in a safe manner as required by applicable laws and regulations. The Commission expects the Buyer to ensure that logging crewmembers dress in protective attire and perform their duties with equipment in accordance with standards established by the logging industry and the Occupational Safety and Health Administration (OSHA).

The PGC recommends that logging crews working on State Game Lands be trained in safe logging techniques and sound environmental logging practices through a formal training program such as the one provided by the Pennsylvania Sustainable Forestry Initiative (PA SFI) or another similar program.

Contractor must comply with the erosion and sediment control plan for disturbed areas that is included as a

Rev (7-13)
part of the timber contract.

- SPECIAL PROVISIONS -

See Attached Sheets.

SPECIAL PROVISIONS FOR THE "TOO LONG" TIMBER SALE

STATE GAME LANDS # 211

1) ADMINISTRATIVE ITEMS

- a) All contractors, subcontractors and consultants of the Buyer must be pre-approved by the Commission. The Commission reserves the right to reject any subcontractor at its sole discretion. If Contractor enters into any subcontract(s) not previously approved by the Commission, the Commission shall have the right to require the Contractor to terminate such contracts.
- b) **No trees may be felled during June and July due to Indiana Bat habitat restrictions.**
- c) For this timber harvest, all pulpwood trees may be felled, skidded, and chipped in their entirety. A pulpwood tree is defined as follows: that is any tree between 1" DBH and 12" DBH and which does not contain a merchantable saw log.
- d) Utility Rights-Of-Way (ROW) should not be driven on or across with any vehicles or equipment. The eastern and western timber sale boundary borders the edge of ROWs. These utility ROWs are designated on the attached map.
- e) All top wood 3" in diameter and smaller from all sawtimber trees is reserved and cannot be removed from the site. The tops need to be scattered across the harvest site.
- f) The Regional Forester or his designee will closely monitor harvest and skidder damage to residual trees. If damage becomes excessive additional restrictions will be placed on the harvest. Total disregard to the residual trees and failure to take corrective actions will result in payment of damages and/or termination of the timber contract.
- g) If site conditions in the woods (for felling, skidding, or trucking) or the use of the haul road become too wet, muddy or ice covered and could or will cause damage to the property, all phases of the job will be suspended until working conditions are favorable. The Regional Forester will make the final decision in this matter.

2) BOUNDARIES, BLOCKS AND CUTTING INSTRUCTIONS

- a) All sale activity (Felling, Skidding & Trucking) is restricted to the defined sale area. Sale area boundary is defined by blue paint.
- b) No skidding is permitted on the haul road.
- c) No trees may be felled during June and July due to Indiana Bat habitat restrictions.
- d) In all blocks: All Red and Blue painted trees must be left standing and not damaged. All unmarked trees 1" in diameter and larger in these blocks must be cut through and placed on the ground.
- e) All stumps must be less than 12" in height when measured from the ground.

3) US /STATE / LOCAL ROADS

- a) The PGC access road entrance is along Rt. 325 (40.548162, -76.577929).

4) GAME LAND ROADS TO BUILD / IMPROVE

- a) The timber contractor must build about 2,200 feet of haul road at this location and improve about 21,400 feet of existing haul road. The road must have a 12-foot running surface along with a crown and side ditches. Water bars,

intercept dips, culvert pipes (10 locations) and water turnouts will be used for draining surface water. Stone will be required on the new road. The Regional forester will designate specific locations for culvert pipes, stone, and water bars (see the attached map). The side ditches and all disturbed areas must be seeded immediately following construction of the road.

- b) Small borrow pits in the sale area may be used for fill with authorization of the Regional Forester. These sites must be regraded and seeded at the conclusion of usage. This is to be used in addition to required stone, not as a replacement.
- c) Required stone for this harvest
 - 1. Stone is for all designated locations on the haul road.
 - 2. Minimum of 700 tons of AASHTO # 3 (similar to 3A modified) stone for the following locations: Haul road base- 500 tons, road retirement – 200 tons.
 - 3. Minimum of 400 tons of 2A Modified stone for the following locations: Haul road surface – 250 tons, culvert pipes – 150 tons.
 - 4. Receipts may be required to verify the amount of stone applied to the designated locations.
- d) Haul Road Construction / Timeframe
 - 1. The Regional Forester will designate all locations for culvert pipes, water bars, water turnouts, and intercept dips. Side ditches and disturbed areas must be seeded immediately following grading of the haul road. All road improvements must be completed and approved by the Regional Forester.
 - 2. The timber contractor will supply and install ten smooth bore 24" X20' black plastic culvert pipes. There are eight designated locations for pipes, and the remaining two pipes will be utilized as needed. The pipes must be installed with a backhoe and be bedded with 2A modified stone. Stone head walls must be set on each end of each pipe. The pipe must have side ditches for the drainage of water to the pipe and a tailrace for drainage out of the pipe.
 - 3. All road construction and culvert pipe installations must be allowed to settle for 30 days prior to any usage. During that time period, no truck activity will be permitted on the newly constructed road. This requirement will be waived if the operator provides a vibrating roller to compact the entire road surface. The road must have a solid surface and not show any movement. The use of the roller is at the discretion of the contractor.
 - 4. Construction and or improvement of the haul road should occur during the time period of April 1 to October 10. During times of wet site conditions, no road construction will be permitted.
 - 5. Between October 10 and April 1 road construction and road improvements will be permitted providing the following conditions can be met.
 - a. The site conditions must be favorable for the construction of a quality road (Not wet or frozen ground). Excavation and grading of the haul road along with installation of culvert pipe must be able to be completed without creating an erosion hazard.
 - b. Seeding will occur at the completion of the construction. Straw mulch must be applied to all locations, which would require seeding. (Applies to this Time Period).
 - c. The ground must be workable and able to be compacted. Access for stone trucks must adequate. Designated log landing locations must be cleared.
 - d. The Regional Forester will have the final decision to approve construction/improvement of the haul road and

landing.

6. The road improvements must be completed by October 10, 2026.
7. All equipment will be cleaned of soil and debris before being moved onto site to prevent spread of invasive species.
8. The road will be inspected and approved by the Regional Forester prior to any usage by the timber operator.

5) LANDINGS

- a) Eleven locations have been designated as the log landings for this harvest. The landings are located in Blocks 1, 3, 4, 5, 6, 7, 8, and 9. The contractor will be required to improve the existing log landing in blocks 1, 5, 6, and 8. The contractor will be required to construct a log landing in blocks 3, 4, 7, and 9. The log landings will require the excavation of stumps and rocks as well as the grading and leveling of the site. There are numerous existing landings that will need to be improved. The contractor will be permitted to load trucks on the haul road providing there is a clear path for other Game Land users to safely utilize the road.
- b) Total size of each landing will be less than ½ acre in size.
- c) Upon completion of the harvest operation, each landing must be cleared of all logging debris/slash and then graded, limed, fertilized, seeded, and mulched.

6) SKIDDING

- a) No skidding outside of the designated sale area.
- b) Equipment and vehicles will not be permitted to be operated on or driven across the utility Rights-Of-Ways west of Block 1 and east of Block 10 and 11.
- c) Skidding of material onto the landings may require the crossing of the haul road. Damage to the road surface will be repaired immediately following the completion of the harvest in the blocks. Crossing sites must be approved by the regional forester.
- d) Skidding is not permitted outside the timber sale blocks.
- e) Material to be removed from all sale blocks must be skidded to the landings.
- f) If a skid trail will be sitting idle for one month or more, they must have open and functional water bars.
- g) All skid trails will require the grading of wheel ruts, the installation of water bars and seeding at the conclusion of the harvest operation.

7) SEEDING OF ROADWAYS AND LANDINGS

- a) The entire haul road will require grading at the completion of the harvest. Final grading and ditches must be established with bulldozer with a six-way blade or equivalent piece of equipment. Use of a log skidder or similar type of equipment is not acceptable for grading the road. Failure to use the proper equipment will require a second grading of the road.
- b) Seeding of disturbed sections of the haul road will be required as designated by the Regional Forester.
- c) Seeding Specifications:

TRAILS AND ROAD

4 lbs. New Zealand White Clover/acre
4 lbs. Red Clover/Acre
3 lbs. Birdsfoot Tree Foil/Acre
60 lbs. Wheat/acre – fall
60 lbs Oats/acre - spring

Fertilizer: 400 lbs of 10-10-10/acre
Ground Limestone: 2 tons of lime/acre (Lime must contain 1.4% Mg)
Straw Mulch: 100 bales per acre of clean wheat straw

Straw Mulch is for the seeding of the Log Landings and designated portion of the haul road. Straw must spread to a depth of less than 1/2" over the entire seeded location. Clean wheat straw must be used as mulch. No hay or other grass mulch will be permitted.

Approximately 6.5 acres are expected to be seeded at the conclusion of the harvest. The breakdown is as follows:

Log landings	5.5 acres
Skid Trails	1.0 acre

Spring Seeding: April 1 to May 30
Fall Seeding: September 1 to October 10

A vegetative cover on all seeded sites will be acceptable when 70 percent of the site has the desired cover. The performance bond will not be released until this requirement is satisfied.

d) Sale Block Clean-up

1. All cleanup work in a sale block must be completed before the contractor will be permitted to move into the next cutting block.
2. All skid trails must be leveled, and water bars installed where needed or when directed by the Regional Forester
3. All skid trails must be seeded immediately (spring & fall seeding period) following the completion of its usage.
4. Each log landing must be graded, sawdust and logging debris scattered along with bare mineral soil exposed, and ground lime, fertilizer, seed, and straw mulch applied. Seeding of these sites is only permitted during the designated seeding periods.
5. The contractor must notify the Regional Forester prior to the application of lime, fertilizer, seed, and mulch.

8. OPERATIONS AND NON-WORKDAYS

- a) No trees may be felled during June and July due to Indiana Bat habitat restrictions.
- b) No in woods operations will be permitted on the following days for the period of this contract:
 1. All Saturdays in the months of October, November, December and January and any Sundays open to hunting.
 2. The opening day and all Saturdays during spring gobbler season, including the youth spring gobbler hunt.
 3. All the days of the general statewide bear season.
 4. The entire two weeks of the general firearms deer season.
 5. The opening day of the flintlock muzzleloader season.

- c) The timber operator, employees and sub-contractors may not hunt to, from, or at the job site when the work location is beyond a gated road that is closed to public travel. The contractor may travel to and from the work location on no-work days to check on the condition of equipment. **No felling, skidding, trucking, equipment repair or access for the purpose of hunting at the job site will be permitted.**
- d) The contractor is responsible for the control and collection of fluids leaking from any equipment used on the site. The contractor must have a spill containment and cleanup kit appropriate for the equipment being used. At a minimum the kit will contain plugs and clamps to control hydraulic line breaks, a container to collect leaking fluids, fluid absorbent pads and a shovel. Operating any equipment noticeably leaking fluids is prohibited. The contractor must collect and control fluids leaking from any equipment and dispose of properly.
- e) **It is unlawful to be present on State Game Lands from November 15 through December 15 inclusive when not engaged in lawful hunting or trapping and fail to wear a minimum of 250 square inches of daylight fluorescent-orange material on the head, chest and back combined, or in lieu thereof, a hat of the same colored material. The material shall be worn so it is visible in a 360-degree arc.**

9. SAFETY AND LOGGER TRAINING

- a) The buyer, his employees and sub-contractors are expected to perform all logging operations in a safe manner as required by applicable laws and regulations. The Commission expects the Buyer to ensure that logging crewmembers dress in protective attire, and perform their duties with equipment, in accordance with standards established by the logging industry and the Occupational Safety and Health Administration (OSHA).
- b) The PGC recommends that logging crews working on State Game Lands be trained in safe logging techniques and sound environmental logging practices through a formal training program such as the one provided by the Pennsylvania Sustainable Forestry Initiative or another similar course.

10. MISCELLANEOUS

- a) The timber contractor must comply with erosion and sedimentation control plan for the harvest site. The plan must be on site and available for inspection at all times.
- b) The timber operator should review the plan, due to his responsibility for the implementation of erosion controls during the harvest operation.
- c) If bats are observed within or fleeing from a felled tree, or if a dead bat is found, tree felling activities will cease and the necessary PGC staff will be contacted.
- d) Implement spill pollution prevention measures as follows: (a) Carry oil spill kits for hydraulic fluids, lubricating oils, fuels, and other environmentally hazardous fluids onsite when equipment is active. Spill kits must include: pads and containment socks (rated to absorb 8+ gal. petroleum-based fluids and able to absorb fluids in water and on the ground), containers (or heavy-duty bags) capable of holding 8+ gal. contaminated soil and other absorbents, and a shovel; (b) Contain leaks/spills immediately; (c) Properly dispose of Soil and absorbents through a landfill approved by the Department of Environmental Protection; (d) Take any precautions, as directed by PGC foresters and DCNR district foresters, to prevent soil erosion, water pollution, and other conditions detrimental to the environment on State Lands. Follow all DEP guidelines and regulations relating to spills and spill prevention.
- e) PGC gates **must** be closed. Part of the access road is open to the public during the fall hunting seasons. The gate near Rt. 325 will be left open at that time. Repeated failure to close gates will be penalized.
- f) All equipment will be cleaned of soil and debris before being moved onto site to prevent the spread of invasive species.
- g) Vehicle traffic on the PGC access road shall not exceed 25 MPH.

- h) The selling of firewood to the general public will not be permitted. The sale of firewood to a commercial firewood contractor is permitted.
- i) Payment for block 4 of the sale is required at the time of execution of the timber contract. Failure to provide this payment will void the timber contract.
- j) The timber sale contractor will be required to make all necessary PA-1 call notifications.
- k) **Payment for at least six blocks is due by May 30, 2026.**
- l) **This timber contract will expire on May 30, 2027.**
- m) **Final payment is due no later than 120 days before the expiration of the agreement.**
- n) This timber sale falls in the spotted lanternfly quarantine area. The buyer is responsible for understanding and complying with all applicable requirements. Up to date information can be found at www.pda.state.pa.us/spottedlanternfly.

Report For TOO LONG

Sale Name:	TOO LONG	SGL Number:	211	
Forester:	Doyle	Report Date:	05/31/2024	
Blocks Numbers in Sale:	1,2,3,4,5,6,7,8,9,10,11		Acres:	377.2
County:	Dauphin	Township:	Rush	

The Pennsylvania Game Commission SGL #211 - TOO LONG Timbersale Scribner Rule (BDFI) - All Volumes are Estimates

Block Number	Acres	Area % of Sale	Harvest Type	Method	Sawtimber			Pulpwood			Culls			
					BDFI	Per Acre	% of Sale	Method	Tons	Per Acre	% of Sale	2 - 4"	6 - 10"	12 +"
1	30	8%	Clearcut with Reserves	BAF 10 Plot	126,449	4,247	11%	BAF 10 Plot	955	32	12%	7,051	668	926
2	27	7%	Thinning	BAF 10 Plot	10,487	393	1%	BAF 10 Plot	535	20	7%	5,412	38	552
3	19	5%	Clearcut with Reserves	BAF 10 Plot	94,859	4,874	8%	BAF 10 Plot	402	21	5%	10,705	967	574
4	14	4%	Group Selection	100% Tally	1,475	103	0%		6	0	0%	10	4	23
5	58	15%	Overstory Removal	BAF 10 Plot	297,623	5,153	27%	BAF 10 Plot	325	6	4%	48,154	573	768
6	40	11%	Overstory Removal	BAF 10 Plot	127,945	3,160	11%	BAF 10 Plot	286	7	4%	2,552	206	443
7	34	9%	Thinning	BAF 10 Plot	40,797	1,202	4%	BAF 10 Plot	887	26	12%	12,353	355	501
8	45	12%	Clearcut with Reserves	BAF 10 Plot	213,458	4,746	19%	BAF 10 Plot	1,387	31	18%	4,920	1,198	573
9	56	15%	Thinning	BAF 10 Plot	102,994	1,838	9%	BAF 10 Plot	1,455	26	19%	12,842	2,069	987
10	33	9%	Clearcut with Reserves	BAF 10 Plot	103,915	3,135	9%	BAF 10 Plot	1,391	42	18%	9,160	262	408
11	21	5%	Group Selection	100% Tally	948	46	0%		15	1	0%	19	14	24
Total	377	100%			1,120,951		100%		7,644	20.3	100%	113,176	6,354	5,779

Pulpwood was sampled in block(s) 1, 2, 3, 5, 6, 7, 8, 9, 10 with a precision of +/- 7.8% (90% C.I.)

Sawtimber was sampled in block(s) 1, 2, 3, 5, 6, 7, 8, 9, 10 with a precision of +/- 7.8% (90% C.I.)

The Pennsylvania Game Commission

SGL #211 - TOO LONG Timbersale

Scribner Rule (BDFI) - All Volumes are Estimates

Block All - 377 acres

Species	10"-12" DBH		14" DBH		16" DBH		18" DBH		20" DBH		22" DBH		24" DBH		26" DBH		28" DBH		30"+ DBH		Total Trees	Sawtimber Totals Total Volume	Avg Vol Per Tree	Pulpwood Trees	Tons
	#TR	VOL	#TR	VOL	#TR	VOL	#TR	VOL	#TR	VOL	#TR	VOL	#TR	VOL	#TR	VOL	#TR	VOL	#TR	VOL					
N. Red Oak	180	7,184	633	49,479	642	74,159	756	139,911	420	96,969	313	95,268	210	79,903	103	43,873	42	15,931	19	12,740	3,318	615,416	185	1,151	524
Yellow-poplar	25	785	19	1,359	71	10,887	102	21,783	66	17,261	85	29,925	64	27,726	66	34,790	14	9,002	0	0	514	153,518	299	91	30
Chestnut Oak	77	3,359	296	19,647	241	27,358	68	10,457	90	18,132	38	10,033	13	6,061	0	0	0	0	4	1,689	826	96,738	117	959	254
Red Maple	205	9,070	433	28,233	319	35,560	79	15,333	0	0	0	0	13	4,182	6	1,794	0	0	0	0	1,055	94,173	89	14,887	3,186
Sweet Birch	357	13,883	545	33,583	286	26,852	113	12,120	18	2,610	15	3,294	0	0	0	0	0	0	0	0	1,333	92,341	69	7,710	2,499
Scarlet Oak	0	0	19	1,369	71	5,564	33	3,762	19	4,847	0	0	0	5	928	0	0	0	0	0	147	16,470	112	9	21
White Oak	26	849	37	2,804	29	3,923	23	4,096	9	1,573	7	2,690	0	0	0	0	0	0	0	0	131	15,934	122	83	25
Aspen	0	0	0	0	57	8,335	11	2,837	0	0	0	0	0	0	0	0	0	0	0	0	68	11,172	164	173	113
Black Oak	25	1,269	19	1,873	0	0	11	2,101	0	0	15	4,411	0	0	0	5	975	0	0	0	75	10,630	142	25	10
Chestnut Oak - dead	52	1,633	0	0	0	0	0	0	0	0	15	1,860	0	0	0	0	0	0	0	0	66	3,493	53	96	36
Hickories	0	0	0	0	14	870	0	0	9	2,022	0	0	0	0	0	0	0	0	0	0	23	2,892	124	0	0
Black Gum	0	0	0	0	14	877	0	0	0	0	8	1,558	0	0	0	0	0	0	0	0	22	2,435	110	4,720	758
Sweet Birch - dead	0	0	0	0	0	0	0	0	0	0	0	0	0	0	6	1,747	0	0	0	0	6	1,747	315	18	13
N. Red Oak - dead	0	0	0	0	0	0	0	0	9	1,624	0	0	0	0	0	0	0	0	0	0	9	1,624	182	0	0
Yellow Birch	0	0	0	0	0	0	11	1,567	0	0	0	0	0	0	0	0	0	0	0	0	11	1,567	139	25	13
Sassafras	26	802	0	0	0	0	0	0	0	0	0	0	0	0	0	0	0	0	0	0	26	802	31	879	136
Red Maple - dead	0	0	0	0	0	0	0	0	0	0	0	0	0	0	0	0	0	0	0	0	0	0	0	26	13
Serviceberry	0	0	0	0	0	0	0	0	0	0	0	0	0	0	0	0	0	0	0	0	0	0	0	102	11
Total	972	38,833	2,001	138,346	1,744	194,386	1,208	213,966	641	145,037	495	149,041	300	117,873	186	83,132	61	25,907	23	14,429	7,631	1,120,951	147	30,954	7,644

**The Pennsylvania Game Commission
SGL #211 - TOO LONG Timbersale
Scribner Rule (BDFI) - All Volumes are Estimates**

Block 1 - 30 acres

Species	10"-12" DBH		14" DBH		16" DBH		18" DBH		20" DBH		22" DBH		24" DBH		26" DBH		28" DBH		30"+ DBH		Total Trees	Sawtimber Totals			Pulpwood	
	#TR	VOL	#TR	VOL	#TR	VOL	#TR	VOL	#TR	VOL	#TR	VOL	#TR	VOL	#TR	VOL	#TR	VOL	#TR	VOL		Total Volume	Avg Vol	Per Tree	Trees	Tons
Yellow-poplar	0	0	0	0	0	0	34	7,227	27	7,028	30	11,299	32	15,683	16	8,024	0	0	0	0	139	49,262	355	0	0	
N. Red Oak	0	0	56	3,880	43	4,073	22	4,765	18	5,048	23	6,315	6	2,365	0	0	0	0	0	168	26,446	158	51	29		
Chestnut Oak	0	0	74	4,885	43	3,754	11	2,004	18	5,115	0	0	6	3,245	0	0	0	0	153	19,003	124	228	81			
Red Maple	0	0	56	3,341	57	7,260	11	2,174	0	0	0	0	0	0	0	0	0	0	124	12,774	103	1,901	404			
Sweet Birch	51	1,693	93	5,597	0	0	34	3,504	0	0	0	0	0	0	0	0	0	0	177	10,794	61	1,323	391			
White Oak	0	0	19	1,396	14	2,424	0	0	0	0	0	0	0	0	0	0	0	0	33	3,820	117	0	0			
Yellow Birch	0	0	0	0	0	0	11	1,567	0	0	0	0	0	0	0	0	0	0	11	1,567	139	25	13			
Black Oak	0	0	0	0	0	0	0	0	0	0	0	0	0	0	0	0	5	975	0	0	975	210	0	0		
Chestnut Oak - dead	0	0	0	0	0	0	0	0	0	0	8	938	0	0	0	0	0	0	8	938	125	0	0	0		
Hickories	0	0	0	0	0	0	14	870	0	0	0	0	0	0	0	0	0	0	14	870	61	0	0	0		
Black Gum	0	0	0	0	0	0	0	0	0	0	0	0	0	0	0	0	0	0	0	0	0	240	37			
Total	51	1,693	297	19,099	171	18,381	124	21,240	64	17,191	60	18,552	44	21,293	16	8,024	5	975		831	126,449	152	3,768	955		

**The Pennsylvania Game Commission
SGL #211 - TOO LONG Timbersale
Scribner Rule (BDFI) - All Volumes are Estimates**

Species	Block 2 - 27 acres														Sawtimber Totals			Pulpwood	
	10"-12" DBH	14" DBH	16" DBH	18" DBH	20" DBH	22" DBH	24" DBH	26" DBH	28" DBH	30"+ DBH	Total Trees	Total Volume	Avg Vol Per Tree	Trees	Tons				
Yellow-poplar	0	0	0	0	0	8	2,677	0	6	2,810	0	0	13	5,487	411	0	0		
Red Maple	0	19	966	15	2,151	0	0	0	0	0	0	0	0	3,117	92	1,624	302		
Sweet Birch	0	38	1,882	0	0	0	0	0	0	0	0	0	38	1,882	49	293	109		
N. Red Oak	0	0	0	0	0	0	0	0	0	0	0	0	0	0	0	92	48		
Black Gum	0	0	0	0	0	0	0	0	0	0	0	0	0	0	0	351	43		
Scarlet Oak	0	0	0	0	0	0	0	0	0	0	0	0	0	0	0	8	20		
Aspen	0	0	0	0	0	0	0	0	0	0	0	0	0	0	0	26	12		
Total			58	2,848	15	2,151			8	2,677		6	2,810		86	10,487	122	2,395	

**The Pennsylvania Game Commission
SGL #211 - TOO LONG Timbersale
Scribner Rule (BDFI) - All Volumes are Estimates**

Species	Block 3 - 19 acres														Sawtimber Totals			Pulpwood	
	10"-12" DBH	14" DBH	16" DBH	18" DBH	20" DBH	22" DBH	24" DBH	26" DBH	28" DBH	30"+ DBH	Total Trees	Total Volume	Avg Vol Per Tree	Trees	Tons				
N. Red Oak	25	852	18	916	125	14,623	66	11,079	18	4,365	0	6	3,452	0	263	37,689	143	25	
Yellow-poplar	0	0	0	42	7,070	33	7,907	0	7	3,002	6	2,078	11	6,339	0	99	26,396	267	91
Chestnut Oak	0	0	55	2,532	56	6,562	0	0	27	5,518	7	1,527	0	0	0	145	16,139	112	30
Scarlet Oak	0	0	0	42	2,634	33	3,762	18	4,563	0	0	5	928	0	98	11,888	121	0	0
Sweet Birch	0	0	18	892	28	1,856	0	0	0	0	0	0	0	0	46	2,747	60	50	27
Red Maple	0	0	0	0	0	0	0	0	0	0	0	0	0	0	0	0	0	937	162
Black Gum	0	0	0	0	0	0	0	0	0	0	0	0	0	0	0	0	0	942	116
Aspen	0	0	0	0	0	0	0	0	0	0	0	0	0	0	0	0	0	18	15
Total	25	852	91	4,340	293	32,745	132	22,748	62	14,447	15	4,529	12	5,530	16	651	94,859	146	2,190

The Pennsylvania Game Commission
SGL #211 - TOO LONG Timbersale
Scribner Rule (BDFI) - All Volumes are Estimates

Block 4 - 14 acres

Species	10"-12" DBH		14" DBH		16" DBH		18" DBH		20" DBH		22" DBH		24" DBH		26" DBH		28" DBH		30"+ DBH		Total Trees	Sawtimber Totals Total Volume	Avg Vol Per Tree	Pulpwood Trees	Pulpwood Tons
	#TR	VOL	#TR	VOL	#TR	VOL	#TR	VOL	#TR	VOL	#TR	VOL	#TR	VOL	#TR	VOL	#TR	VOL	#TR	VOL					
Yellow-poplar	0	0	0	0	1	61	1	214	1	325	0	0	1	335	1	505	0	0	0	0	5	1,440	288	0	0
N. Red Oak	1	34	0	0	0	0	0	0	0	0	0	0	0	0	0	0	0	0	0	0	1	34	34	0	0
Red Maple	0	0	0	0	0	0	0	0	0	0	0	0	0	0	0	0	0	0	0	0	0	0	0	16	3
Aspen	0	0	0	0	0	0	0	0	0	0	0	0	0	0	0	0	0	0	0	0	0	0	0	3	2
Black Gum	0	0	0	0	0	0	0	0	0	0	0	0	0	0	0	0	0	0	0	0	0	0	0	6	1
Sweet Birch	0	0	0	0	0	0	0	0	0	0	0	0	0	0	0	0	0	0	0	0	0	0	0	1	0
Sassafras	0	0	0	0	0	0	0	0	0	0	0	0	0	0	0	0	0	0	0	0	0	0	0	1	0
Total	1	34			1	61	1	214	1	325			1	335	1	505					6	1,475	246	27	6

The Pennsylvania Game Commission
SGL #211 - TOO LONG Timbersale
Scribner Rule (BDFI) - All Volumes are Estimates

Block 5 - 58 acres

Species	10"-12" DBH		14" DBH		16" DBH		18" DBH		20" DBH		22" DBH		24" DBH		26" DBH		28" DBH		30"+ DBH		Sawtimber Totals			Pulpwood	
	#TR	VOL	#TR	VOL	#TR	VOL	#TR	VOL	#TR	VOL	#TR	VOL	#TR	VOL	#TR	VOL	#TR	VOL	#TR	VOL	Total Trees	Total Volume	Avg Vol Per Tree	Trees	Tons
N. Red Oak	25	872	186	14,674	171	19,000	327	60,199	164	38,505	113	34,384	114	44,300	65	28,027	14	5,258	4	2,491	1,184	247,710	209	193	102
Chestnut Oak	51	2,065	37	2,724	86	10,421	23	4,498	0	0	15	4,234	0	0	0	0	0	0	0	0	211	23,944	113	25	15
Aspen	0	0	0	0	57	8,335	11	2,837	0	0	0	0	0	0	0	0	0	0	0	0	68	11,172	164	100	72
Red Maple	0	0	56	4,434	0	0	11	1,614	0	0	0	0	0	0	0	0	0	0	0	0	67	6,048	90	314	111
White Oak	0	0	0	0	0	0	11	2,558	9	1,573	0	0	0	0	0	0	0	0	0	0	20	4,131	202	0	0
Yellow-poplar	0	0	0	0	0	0	0	0	0	8	2,597	0	0	0	0	0	0	0	0	0	8	2,597	344	0	0
Hickories	0	0	0	0	0	0	0	9	2,022	0	0	0	0	0	0	0	0	0	0	0	9	2,022	222	0	0
Black Gum	0	0	0	0	0	0	0	0	0	0	0	0	0	0	0	0	0	0	0	0	0	0	0	19	12
Sweet Birch	0	0	0	0	0	0	0	0	0	0	0	0	0	0	0	0	0	0	0	0	0	0	0	101	13
Total	76	2,937	279	21,832	314	37,756	383	71,707	183	42,100	136	41,215	114	44,300	65	28,027	14	5,258	4	2,491	1,568	297,623	190	752	325

The Pennsylvania Game Commission
SGL #211 - TOO LONG Timbersale
Scribner Rule (BDFI) - All Volumes are Estimates

Block 6 - 40 acres

Species	10"-12" DBH		14" DBH		16" DBH		18" DBH		20" DBH		22" DBH		24" DBH		26" DBH		28" DBH		30"+ DBH		Total Trees	Sawtimber Totals			Pulpwood	
	#TR	VOL	#TR	VOL	#TR	VOL	#TR	VOL	#TR	VOL	#TR	VOL	#TR	VOL	#TR	VOL	#TR	VOL	#TR	VOL		Total Volume	Avg Vol Per Tree	Trees	Tons	
N. Red Oak	0	0	38	3,004	29	2,573	69	12,626	46	8,795	84	25,071	39	14,899	27	10,928	0	0	0	0	332	77,896	234	151	54	
Yellow-poplar	0	0	0	0	0	0	0	0	9	2,556	0	0	13	4,871	16	8,837	5	2,823	0	0	43	19,088	440	0	0	
Red Maple	52	1,773	38	2,455	43	4,154	11	2,217	0	0	0	0	6	2,413	0	0	0	0	0	0	151	13,012	86	529	167	
Sweet Birch	0	0	38	1,855	58	5,586	11	1,598	0	0	8	2,297	0	0	0	0	0	0	0	0	115	11,337	99	63	27	
Black Oak	0	0	0	0	0	0	11	2,101	0	0	0	0	0	0	0	0	0	0	0	0	11	2,101	183	0	0	
Chestnut Oak	0	0	0	0	0	0	0	0	9	1,554	0	0	0	0	0	0	0	0	0	0	9	1,554	168	0	0	
White Oak	0	0	0	0	14	1,499	0	0	0	0	0	0	0	0	0	0	0	0	0	0	14	1,499	103	0	0	
Scarlet Oak	0	0	0	0	14	1,458	0	0	0	0	0	0	0	0	0	0	0	0	0	0	14	1,458	101	0	0	
Black Gum	0	0	0	0	0	0	0	0	0	0	0	0	0	0	0	0	0	0	0	0	0	0	0	55	38	
Total	52	1,773	114	7,315	159	15,270	103	18,543	65	12,906	92	27,368	58	22,182	44	19,766	5	2,823			691	127,945	185	797	286	

**The Pennsylvania Game Commission
SGL #211 - TOO LONG Timbersale
Scribner Rule (BDFI) - All Volumes are Estimates**

Block 7 - 34 acres

Species	10"-12" DBH		14" DBH		16" DBH		18" DBH		20" DBH		22" DBH		24" DBH		26" DBH		28" DBH		30"+ DBH		Total Trees	Sawtimber Totals			Pulpwood	
	#TR	VOL	#TR	VOL	#TR	VOL	#TR	VOL	#TR	VOL	#TR	VOL	#TR	VOL	#TR	VOL	#TR	VOL	#TR	VOL		Total Trees	Total Volume	Avg Vol Per Tree	Trees	Tons
Sweet Birch	51	2,671	131	7,988	86	8,498	11	974	9	1,620	8	997	0	0	0	0	0	0	0	0	295	22,747	77	1,267	407	
Red Maple	25	1,371	19	939	29	3,069	11	2,706	0	0	0	0	0	0	0	0	0	0	0	0	84	8,085	96	1,889	354	
N. Red Oak	25	874	19	1,481	0	0	0	0	9	2,815	0	0	0	0	0	0	0	0	0	0	53	5,171	97	95	40	
Yellow-poplar	0	0	0	0	0	0	11	2,423	0	0	0	0	0	0	0	0	0	0	0	0	11	2,423	214	0	0	
Chestnut Oak	0	0	0	0	14	2,371	0	0	0	0	0	0	0	0	0	0	0	0	0	0	14	2,371	166	102	8	
Sassafras	0	0	0	0	0	0	0	0	0	0	0	0	0	0	0	0	0	0	0	0	0	0	0	289	40	
Black Gum	0	0	0	0	0	0	0	0	0	0	0	0	0	0	0	0	0	0	0	0	0	0	0	342	38	
Total	102	4,917	168	10,408	129	13,938	34	6,103	18	4,435	8	997									458	40,797	89	3,984	887	

The Pennsylvania Game Commission
SGL #211 - TOO LONG Timbersale
Scribner Rule (BDFI) - All Volumes are Estimates

Block 8 - 45 acres

Species	10"-12" DBH		14" DBH		16" DBH		18" DBH		20" DBH		22" DBH		24" DBH		26" DBH		28" DBH		30"+ DBH		Sawtimber Totals			Pulpwood	
	#TR	VOL	#TR	VOL	#TR	VOL	#TR	VOL	#TR	VOL	#TR	VOL	#TR	VOL	#TR	VOL	#TR	VOL	#TR	VOL	Total Trees	Total Volume	Avg Vol Per Tree	Trees	Tons
N. Red Oak	52	2,300	57	4,551	161	18,555	139	27,830	66	14,944	85	27,840	33	11,467	11	4,918	24	8,272	11	8,502	638	129,178	202	275	112
Red Maple	52	2,300	115	6,882	132	13,675	112	2,239	0	0	0	0	7	1,769	6	1,794	0	0	0	0	322	28,658	89	2,730	656
Yellow-poplar	0	0	19	1,359	0	0	23	4,011	9	2,076	23	7,465	0	0	6	2,798	5	2,851	0	0	85	20,558	241	0	0
Chestnut Oak	26	1,294	19	1,398	0	0	23	3,054	9	958	8	2,743	7	2,816	0	0	0	0	4	1,689	96	13,953	145	26	15
Sweet Birch	52	2,240	96	7,387	15	975	12	998	0	0	0	0	0	0	0	0	0	0	0	0	174	11,599	67	878	313
Black Oak	0	0	0	0	0	0	0	0	0	0	8	2,258	0	0	0	0	0	0	0	0	8	2,258	292	0	0
Sweet Birch - dead	0	0	0	0	0	0	0	0	0	0	0	0	0	6	1,747	0	0	0	0	0	6	1,747	315	0	0
Black Gum	0	0	0	0	0	0	0	0	0	0	8	1,558	0	0	0	0	0	0	0	0	8	1,558	201	1,387	245
Scarlet Oak	0	0	0	0	15	1,472	0	0	0	0	0	0	0	0	0	0	0	0	0	0	15	1,472	101	0	0
White Oak	26	849	0	0	0	0	0	0	0	0	0	0	0	0	0	0	0	0	0	0	26	849	33	0	0
Chestnut Oak - dead	26	825	0	0	0	0	0	0	0	0	0	0	0	0	0	0	0	0	0	0	26	825	32	0	0
Sassafras	26	802	0	0	0	0	0	0	0	0	0	0	0	0	0	0	0	0	0	0	26	802	31	52	21
Red Maple - dead	0	0	0	0	0	0	0	0	0	0	0	0	0	0	0	0	0	0	0	0	0	0	0	26	13
Aspen	0	0	0	0	0	0	0	0	0	0	0	0	0	0	0	0	0	0	0	0	0	0	0	26	12
Total	260	10,609	306	21,577	322	34,676	208	38,132	84	17,977	132	41,864	46	16,053	28	11,257	29	11,122	15	10,191	1,429	213,458	149	5,400	1,387

**The Pennsylvania Game Commission
SGL #211 - TOO LONG Timbersale
Scribner Rule (BDFI) - All Volumes are Estimates**

Block 9 - 56 acres

Species	10"-12" DBH		14" DBH		16" DBH		18" DBH		20" DBH		22" DBH		24" DBH		26" DBH		28" DBH		30"+ DBH		Total Trees	Sawtimber Totals			Pulpwood	
	#TR	VOL	#TR	VOL	#TR	VOL	#TR	VOL	#TR	VOL	#TR	VOL	#TR	VOL	#TR	VOL	#TR	VOL	#TR	VOL		Total Volume	Avg Vol Per Tree	Trees	Tons	
N. Red Oak	51	2,251	112	9,348	29	5,158	11	2,192	18	5,090	0	0	6	1,732	0	0	0	0	0	0	228	25,771	113	0	0	
Yellow-poplar	25	785	0	0	29	3,756	0	0	18	5,054	8	2,609	6	2,679	11	5,477	5	3,328	0	0	102	23,688	232	0	0	
Sweet Birch	178	5,975	94	5,114	57	6,041	23	2,556	9	991	0	0	0	0	0	0	0	0	0	0	361	20,677	57	1,633	471	
Red Maple	76	3,626	112	7,770	29	3,660	23	4,383	0	0	0	0	0	0	0	0	0	0	0	0	240	19,440	81	3,710	762	
Chestnut Oak	0	0	56	4,106	14	1,441	0	0	0	0	0	0	0	0	0	0	0	0	0	0	70	5,548	79	151	37	
White Oak	0	0	19	1,408	0	0	11	1,537	0	0	0	0	0	0	0	0	0	0	0	0	30	2,945	98	83	25	
Black Oak	0	0	19	1,873	0	0	0	0	0	0	0	0	0	0	0	0	0	0	0	0	19	1,873	100	0	0	
Scarlet Oak	0	0	19	1,369	0	0	0	0	0	0	0	0	0	0	0	0	0	0	0	0	19	1,369	73	0	0	
Black Gum	0	0	0	0	14	877	0	0	0	0	0	0	0	0	0	0	0	0	0	0	14	877	61	603	110	
Chestnut Oak - dead	25	808	0	0	0	0	0	0	0	0	0	0	0	0	0	0	0	0	0	0	25	808	32	0	0	
Sassafras	0	0	0	0	0	0	0	0	0	0	0	0	0	0	0	0	0	0	0	0	0	0	0	318	38	
Serviceberry	0	0	0	0	0	0	0	0	0	0	0	0	0	0	0	0	0	0	0	0	0	0	0	102	11	
Total	357	13,444	431	30,988	172	20,933	68	10,669	46	11,135	8	2,609	13	4,411	11	5,477	5	3,328			1,109	102,994	93	6,600	1,455	

**The Pennsylvania Game Commission
SGL #211 - TOO LONG Timbersale
Scribner Rule (BDFI) - All Volumes are Estimates**

Block 10 - 33 acres

Species	10"-12" DBH		14" DBH		16" DBH		18" DBH		20" DBH		22" DBH		24" DBH		26" DBH		28" DBH		30"+ DBH		Sawtimber Totals			Pulpwood		
	#TR	VOL	#TR	VOL	#TR	VOL	#TR	VOL	#TR	VOL	#TR	VOL	#TR	VOL	#TR	VOL	#TR	VOL	#TR	VOL	Total Trees	Total Volume	Avg Vol Per Tree	Trees	Tons	
N. Red Oak	0	0	146	11,574.84	84	10,178.121	121	21,219.80	80	17,405.7	7	1,659.6	6	1,687.0	0	0	0	0	0	4	1,748.449	65,471	146	270	124	
Chestnut Oak	0	0	55	4,001.28	28	2,808.11	900	27	4,988.7	7	1,529.0	0	0	0	0	0	0	0	0	0	128	14,226	111	299	60	
Sweet Birch	25	1,304	36	2,818.42	42	3,896.22	2,490	0	0	0	0	0	0	0	0	0	0	0	0	0	125	10,509	84	2,076	734	
Black Oak	25	1,269	0	0	0	0	0	0	0	7	2,153.0	0	0	0	0	0	0	0	0	0	32	3,423	106	25	10	
Red Maple	0	0	18	1,447.14	14	1,523.0	0	0	0	0	0	0	0	0	0	0	0	0	0	0	32	2,970	92	1,225	262	
White Oak	0	0	0	0	0	0	0	0	0	7	2,690.0	0	0	0	0	0	0	0	0	0	7	2,690	364	0	0	
Yellow-poplar	0	0	0	0	0	0	0	0	0	0	0	6	2,081.0	0	0	0	0	0	0	0	6	2,081	335	0	0	
N. Red Oak - dead	0	0	0	0	0	0	0	0	9	1,624.0	0	0	0	0	0	0	0	0	0	0	9	1,624	182	0	0	
Chestnut Oak - dead	0	0	0	0	0	0	0	0	0	7	921.0	0	0	0	0	0	0	0	0	0	7	921	125	96	36	
Black Gum	0	0	0	0	0	0	0	0	0	0	0	0	0	0	0	0	0	0	0	0	0	0	764	116		
Sassafras	0	0	0	0	0	0	0	0	0	0	0	0	0	0	0	0	0	0	0	0	0	0	216	37		
Sweet Birch - dead	0	0	0	0	0	0	0	0	0	0	0	0	0	0	0	0	0	0	0	0	0	0	18	13		
Total	50	2,574	255	19,840	168	18,406	154	24,610	116	24,017	37	8,953	12	3,769						4	1,748	796	103,915	130	4,990	1,391

The Pennsylvania Game Commission
SGL #211 - TOO LONG Timbersale
Scribner Rule (BDFI) - All Volumes are Estimates

Block 11 - 21 acres

Species	10"-12" DBH		14" DBH		16" DBH		18" DBH		20" DBH		22" DBH		24" DBH		26" DBH		28" DBH		30"+ DBH		Total Trees	Sawtimber Totals			Pulpwood	
	#TR	VOL	#TR	VOL	#TR	VOL	#TR	VOL	#TR	VOL	#TR	VOL	#TR	VOL	#TR	VOL	#TR	VOL	#TR	VOL		Total Volume	Avg Vol Per Tree	Trees	Tons	
Yellow-poplar	0	0	0	0	0	0	0	0	1	222	1	276	0	0	0	0	0	0	0	0	2	497	249	0	0	
Scarlet Oak	0	0	0	0	0	0	0	0	1	284	0	0	0	0	0	0	0	0	0	0	1	284	284	1	1	
Red Maple	0	0	0	0	1	68	0	0	0	0	0	0	0	0	0	0	0	0	0	0	1	68	68	11	4	
N. Red Oak	0	0	1	50	0	0	0	0	0	0	0	0	0	0	0	0	0	0	0	0	1	50	50	0	0	
Sweet Birch	0	0	1	49	0	0	0	0	0	0	0	0	0	0	0	0	0	0	0	0	1	49	49	24	8	
Black Gum	0	0	0	0	0	0	0	0	0	0	0	0	0	0	0	0	0	0	0	0	0	0	0	12	1	
Sassafras	0	0	0	0	0	0	0	0	0	0	0	0	0	0	0	0	0	0	0	0	0	0	0	2	0	
Chestnut Oak	0	0	0	0	0	0	0	0	0	0	0	0	0	0	0	0	0	0	0	0	0	0	0	1	0	
Total			2	99	1	68			2	505	1	276								6	948	158	51	15		

**The Pennsylvania Game Commission
SGL #211 - TOO LONG Timbersale
Scribner Rule (BDFI) - All Volumes are Estimates**

Species	2" DBH		4" DBH		6" DBH		8" DBH		10" DBH		12" DBH		14" DBH		16" DBH		18" DBH		20"+ DBH		Pulpwood	
	#TR	VOL	#TR	VOL	#TR	VOL	#TR	VOL	#TR	VOL	#TR	VOL	#TR	VOL	#TR	VOL	#TR	VOL	#TR	VOL	Total Trees	Total Tons
Red Maple	0	0	0	0	7,553	889	4,324	930	2,139	795	745	435	112	98	29	35	11	18	0	0	14,913	3,199
Sweet Birch	0	0	0	0	1,622	208	2,117	410	2,160	711	1,328	710	372	302	113	132	0	0	9	20	7,728	2,513
Black Gum	0	0	0	0	3,162	344	975	132	149	34	230	93	132	85	72	69	0	0	0	0	4,720	758
N. Red Oak	0	0	0	0	0	0	288	54	368	130	380	222	93	79	14	18	0	0	0	0	1,151	524
Chestnut Oak	0	0	0	0	301	26	283	58	361	131	101	58	0	0	0	0	0	0	9	17	1,056	289
Sassafras	0	0	0	0	407	44	286	37	109	24	77	31	0	0	0	0	0	0	0	0	879	136
Aspen	0	0	0	0	0	0	0	0	1	0	79	37	93	75	1	1	0	0	0	0	173	113
Yellow-poplar	0	0	0	0	0	0	56	13	36	17	0	0	0	0	0	0	0	0	0	0	91	30
White Oak	0	0	0	0	0	0	57	11	0	0	25	14	0	0	0	0	0	0	0	0	83	25
Scarlet Oak	0	0	0	0	0	0	0	0	0	0	0	0	1	1	0	0	0	0	0	0	9	21
Yellow Birch	0	0	0	0	0	0	0	0	0	0	25	13	0	0	0	0	0	0	0	0	25	13
Serviceberry	0	0	0	0	102	11	0	0	0	0	0	0	0	0	0	0	0	0	0	0	102	11
Black Oak	0	0	0	0	0	0	0	0	0	0	25	10	0	0	0	0	0	0	0	0	25	10
Black Cherry	0	0	0	0	0	0	0	0	0	0	0	0	0	0	0	0	0	0	0	0	0	0
Eastern Hemlock	0	0	0	0	0	0	0	0	0	0	0	0	0	0	0	0	0	0	0	0	0	0
Hickories	0	0	0	0	0	0	0	0	0	0	0	0	0	0	0	0	0	0	0	0	0	0
Striped Maple	0	0	0	0	0	0	0	0	0	0	0	0	0	0	0	0	0	0	0	0	0	0
Total					13,147	1,521	8,386	1,647	5,323	1,842	3,015	1,622	803	640	229	255	11	18	18	37	30,954	7,644

**The Pennsylvania Game Commission
SGL #211 - TOO LONG Timbersale
Scribner Rule (BDFI) - All Volumes are Estimates**

Block All - 377 acres - Large Tree Stand and Stock Table

Species	<30" DBH		30" DBH		32" DBH		34" DBH		36" DBH		38" DBH		40" DBH		>40" DBH		Sawtimber Totals			Pulpwood	
	#TR	VOL	#TR	VOL	#TR	VOL	#TR	VOL	#TR	VOL	#TR	VOL	#TR	VOL	#TR	VOL	Total Trees	Total Volume	Avg Vol Per Tree	Trees	Tons
N. Red Oak	3,299	602,675	12	6,795	4	2,587	0	0	3	3,357	0	0	0	0	0	0	3,318	615,416	185	1,151	524
Yellow-poplar	514	153,518	0	0	0	0	0	0	0	0	0	0	0	0	0	0	514	153,518	299	91	30
Chestnut Oak	822	95,049	4	1,689	0	0	0	0	0	0	0	0	0	0	0	0	826	96,738	117	959	254
Red Maple	1,055	94,173	0	0	0	0	0	0	0	0	0	0	0	0	0	0	1,055	94,173	89	14,887	3,186
Sweet Birch	1,333	92,341	0	0	0	0	0	0	0	0	0	0	0	0	0	0	1,333	92,341	69	7,710	2,499
Scarlet Oak	147	16,470	0	0	0	0	0	0	0	0	0	0	0	0	0	0	147	16,470	112	9	21
White Oak	131	15,934	0	0	0	0	0	0	0	0	0	0	0	0	0	0	131	15,934	122	83	25
Aspen	68	11,172	0	0	0	0	0	0	0	0	0	0	0	0	0	0	68	11,172	164	173	113
Black Oak	75	10,630	0	0	0	0	0	0	0	0	0	0	0	0	0	0	75	10,630	142	25	10
Chestnut Oak - dead	66	3,493	0	0	0	0	0	0	0	0	0	0	0	0	0	0	66	3,493	53	96	36
Hickories	23	2,892	0	0	0	0	0	0	0	0	0	0	0	0	0	0	23	2,892	124	0	0
Black Gum	22	2,435	0	0	0	0	0	0	0	0	0	0	0	0	0	0	22	2,435	110	4,720	758
Sweet Birch - dead	6	1,747	0	0	0	0	0	0	0	0	0	0	0	0	0	0	6	1,747	315	18	13
N. Red Oak - dead	9	1,624	0	0	0	0	0	0	0	0	0	0	0	0	0	0	9	1,624	182	0	0
Yellow Birch	11	1,567	0	0	0	0	0	0	0	0	0	0	0	0	0	0	11	1,567	139	25	13
Sassafras	26	802	0	0	0	0	0	0	0	0	0	0	0	0	0	0	26	802	31	879	136
Serviceberry	0	0	0	0	0	0	0	0	0	0	0	0	0	0	0	0	0	0	0	102	11
Yellow-poplar - dead	0	0	0	0	0	0	0	0	0	0	0	0	0	0	0	0	0	0	0	0	0
Striped Maple - dead	0	0	0	0	0	0	0	0	0	0	0	0	0	0	0	0	0	0	0	0	0
Striped Maple	0	0	0	0	0	0	0	0	0	0	0	0	0	0	0	0	0	0	0	0	0
Black Cherry	0	0	0	0	0	0	0	0	0	0	0	0	0	0	0	0	0	0	0	0	0
Black Gum - dead	0	0	0	0	0	0	0	0	0	0	0	0	0	0	0	0	0	0	0	0	0
Sassafras - dead	0	0	0	0	0	0	0	0	0	0	0	0	0	0	0	0	0	0	0	0	0
Aspen - dead	0	0	0	0	0	0	0	0	0	0	0	0	0	0	0	0	0	0	0	0	0
Eastern Hemlock - dead	0	0	0	0	0	0	0	0	0	0	0	0	0	0	0	0	0	0	0	0	0
White Pine - dead	0	0	0	0	0	0	0	0	0	0	0	0	0	0	0	0	0	0	0	0	0
White Oak - dead	0	0	0	0	0	0	0	0	0	0	0	0	0	0	0	0	0	0	0	0	0
Red Maple - dead	0	0	0	0	0	0	0	0	0	0	0	0	0	0	0	0	0	0	0	26	13
Total	7,608	1,106,522	16	8,484	4	2,587			3	3,357							7,631	1,120,951	2,253	30,954	7,644

PGC TIMBER SALE Too Long
STATE GAME LANDS NO. 211
211-2023-01

TIMBER SALE COST ESTIMATE

NEW ROAD CONSTRUCTION -	2200 FEET	
Machine/Labor		8500
Tons AASHTO #3		11000
Tons AASHTO #4		8800
Culvert Pipes		6000
Seed		0
		<u>34,300.00</u>
EXISTING ROAD IMPROVEMENT -	21400 FEET	
Machine/Labor		5000
Tons AASHTO #3		0
Tons AASHTO #4		0
Culvert Pipes		0
Seed		0.00
		<u>5,000.00</u>
LANDINGS		
Machine/Labor		9,000.00
Seed, Lime, Fertilizer		8,800.00
		<u>17,800.00</u>
SKID TRAILS		
Machine/Labor		2,400.00
Seed		300.00
		<u>2,700.00</u>
ROAD RETIREMENT		
Machine/Labor		5,000.00
Tons AASHTO #3		4,400.00
Tons AASHTO #4		0.00
Seed		0.00
		<u>9,400.00</u>
MISC. COSTS		
Total		\$0.00
TOTAL COST ESTIMATE		\$69,200.00



LOCATION MAP

- Treatment Blocks
- P Parking Area
- Stream
- State Game Land
- PA County
- Administrative Road
- Seasonal Road

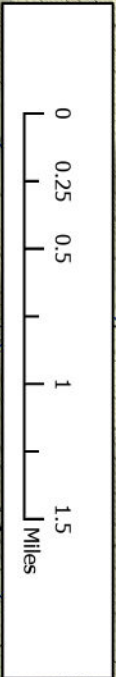

TOO LONG TIMBER SALE
PENNSYLVANIA GAME COMMISSION
STATE GAME LANDS 211
DAUPHIN COUNTY
RUSH TWP
377 APPROXIMATE ACRES

SALE TOUR MEETS HERE
PGC PARKING AREA
CARETAKERS ROAD
OFF ROUTE 325
40.542, -76.573

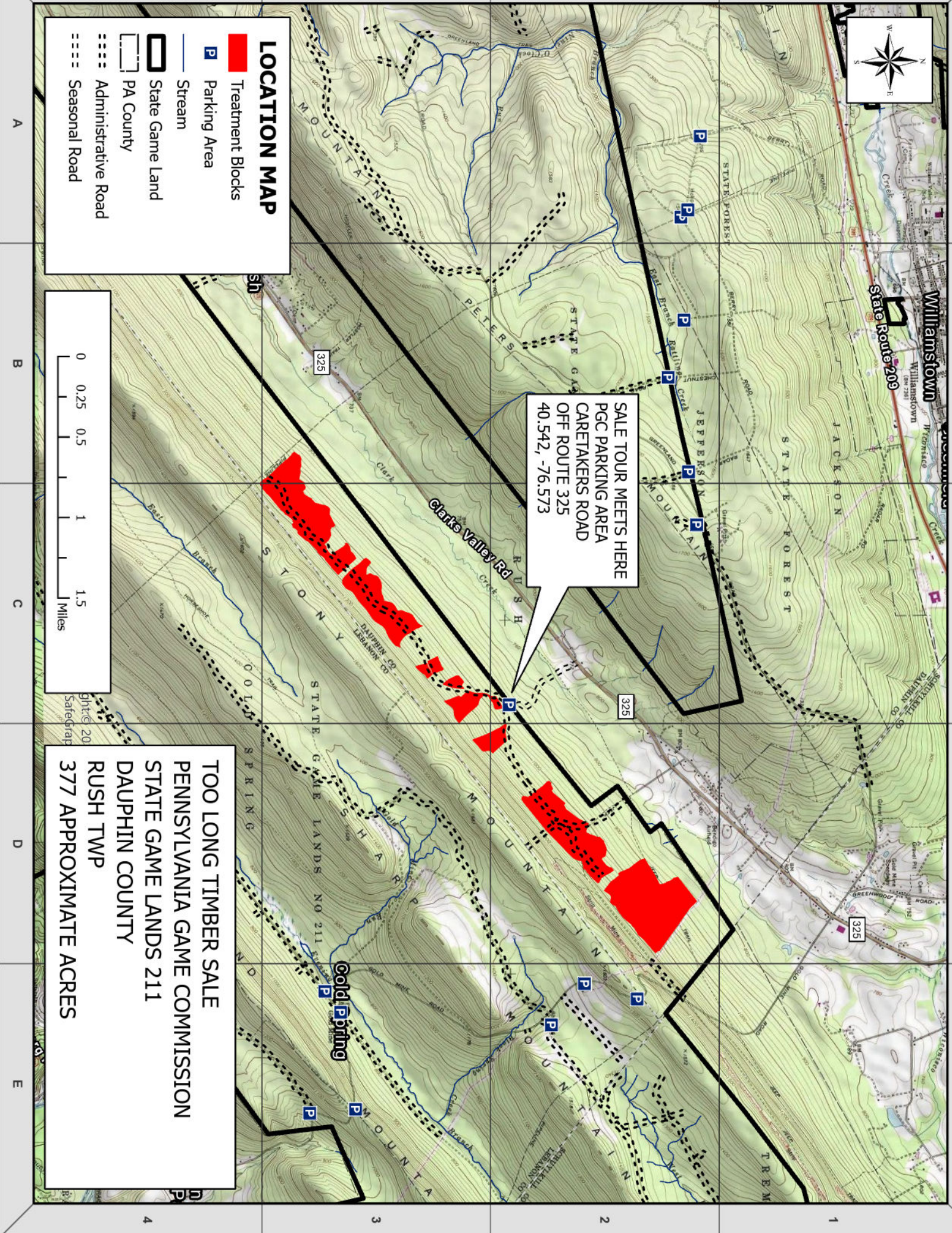

- Block 1 - 30 acres - Clearcut w/ Residuals
- Block 2 - 27 acres - Variable Density Thinning
- Block 3 - 19 acres - Clearcut w/ Residuals
- Block 4 - 14 acres - Group Selection
- Block 5 - 58 acres - Overstory Removal
- Block 6 - 40 acres - Overstory Removal
- Block 7 - 34 acres - Variable Density Thinning
- Block 8 - 45 acres - Clearcut w/ Residuals
- Block 9 - 56 acres - Variable Density Thinning
- Block 10 - 33 acres - Clearcut w/ Residuals
- Block 11 - 21 acres - Group Selection

Total - 377 acres

Legend

- Log_Landing
- Sale_Road
- PGC Roads
- Treatment Area
- Stream
- Land Cover
- Parking Area
- PGC Roads
- PGC Roads
- State Game Land

PGC Parking Area:
40.542, -76.573

AT&T FIBER
OPTIC LINE

CONSTRUCT 2,148 FEET
OF HAUL ROAD (Painted)

UGI PIPELINE



TOO LONG TIMBER SALE
PENNSYLVANIA GAME COMMISSION
STATE GAME LANDS 211
DAUPHIN COUNTY
RUSH TWP
377 APPROXIMATE ACRES

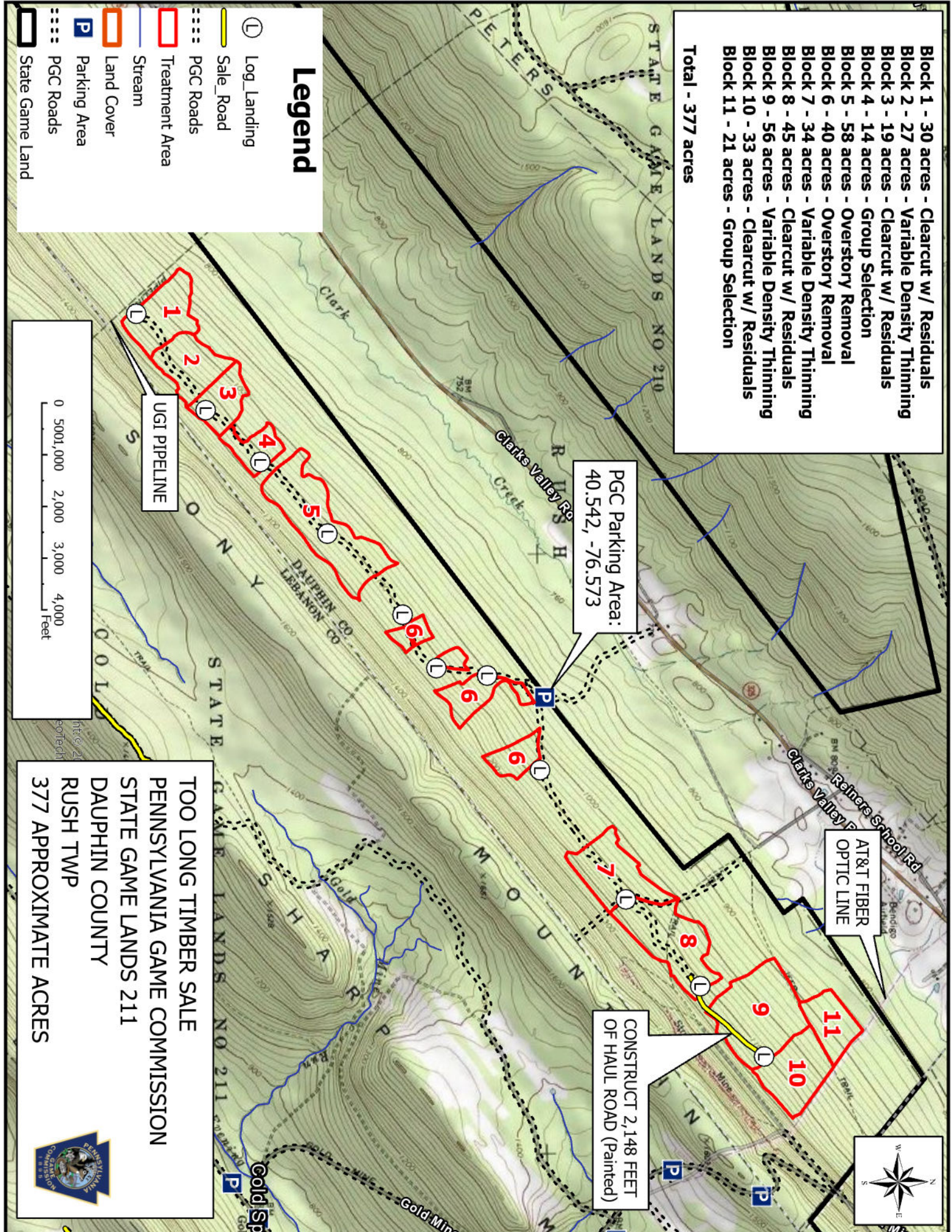

- Block 1 - 30 acres - Clearcut w/ Residuals
- Block 2 - 27 acres - Variable Density Thinning
- Block 3 - 19 acres - Clearcut w/ Residuals
- Block 4 - 14 acres - Group Selection
- Block 5 - 58 acres - Overstory Removal
- Block 6 - 40 acres - Overstory Removal
- Block 7 - 34 acres - Variable Density Thinning
- Block 8 - 45 acres - Clearcut w/ Residuals
- Block 9 - 56 acres - Variable Density Thinning
- Block 10 - 33 acres - Clearcut w/ Residuals
- Block 11 - 21 acres - Group Selection

Total - 377 acres

Legend

- Log_Landing
- Sale_Road
- PGC Roads
- Treatment Area
- Stream
- Land Cover
- Parking Area
- PGC Roads
- State Game Land

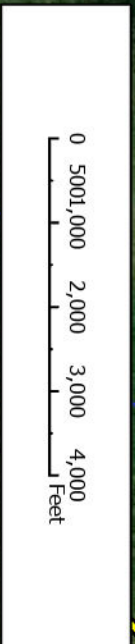

UGI PIPELINE

PGC Parking Area:
40.542, -76.573

Clarks Valley

AT&T FIBER OPTIC LINE

CONSTRUCT 2,148 FEET OF HAUL ROAD (Painted)

TOO LONG TIMBER SALE
PENNSYLVANIA GAME COMMISSION
STATE GAME LANDS 211
DAUPHIN COUNTY
RUSH TWP
377 APPROXIMATE ACRES



Culvert Pipe - 24" x 20' (10)
Intercept Dip - (2)
Ditches need opened near intercept dips

Legend

- PGC Roads
- Treatment Area
- Stream
- Parking Area
- PGC Roads
- State Game Land
- 24" Culvert Pipe
- Intercept Dip
- Ditch Work



TOO LONG TIMBER SALE
PENNSYLVANIA GAME COMMISSION
STATE GAME LANDS 211
DAUPHIN COUNTY
RUSH TWP
ROAD IMPROVEMENTS

